

Door Sensor

User Manual

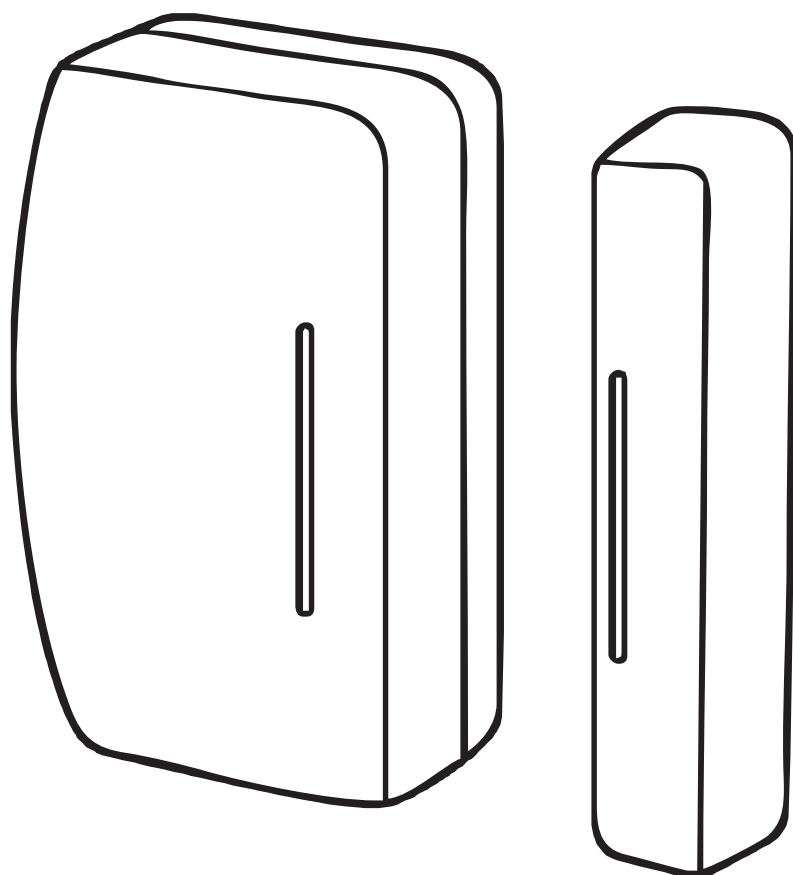

THIRD REALITY

Contents

Mounting Kit	01
Factory Reset	02
Mounting your Door Sensor	02
Setup with Smart Bridge MZ1	03
Setup with Third Reality Hub and SKILL	06
Setup with Compatible Third-Party Zigbee Hubs	08
Pairing with SmartThings	09
Pairing with Amazon Alexa	13
Pairing with Hubitat	16
Pairing with Home Assistant	19
Troubleshooting	24
FCC Regulatory Conformance	26

Mounting Kit

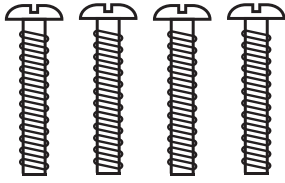

Screw x 4

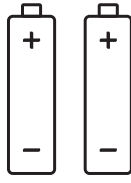

Battery x 2

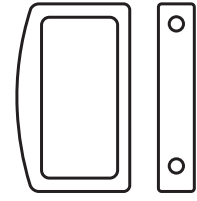

Double-sided
Tape

①

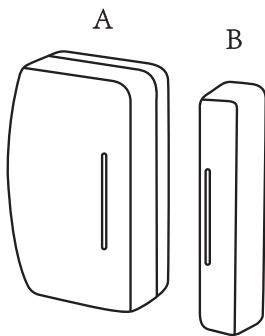

②

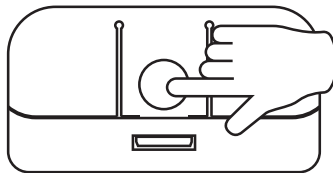

③

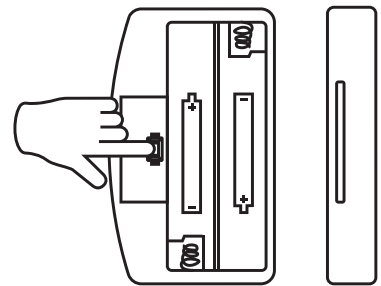

④

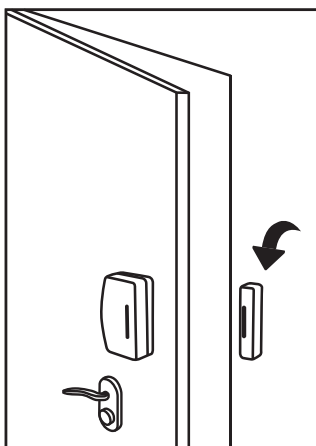

(Correct)

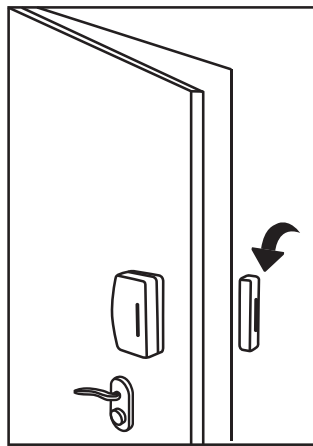

(Incorrect)

Factory Reset

Long press the reset button (Fig. 3) for 3 seconds to factory reset the sensor and put it into pairing mode.

Mounting your Door Sensor

1. Make sure the installation surfaces are clean and dry before installation.
2. Attach Part A and B with double-sided tape separately, make sure the marks on two parts should be aligned and facing each other, the space in between should be less than 5/8 inches(16mm) when closed.

Setting up your Door Sensor

1. Follow the instructions and set up your compatible Zigbee hub.
2. The sensor comes with two parts, A and B (Fig. 1). Press to open part A (Fig. 2), install the batteries and close the back cover, the LED indicator flashes rapidly in blue, the sensor is now ready for setup. Long press the reset button (Fig. 3) for 3 seconds to factory reset the sensor and put it into pairing mode again when needed.
3. Follow the instructions and pair the sensor with your Zigbee hub.

Setup with Smart Bridge MZ1

The Smart Bridge (sold separately) enables your Zigbee device to become Matter-compatible, allowing seamless integration with major Matter ecosystems like Apple Home, Google Home, Amazon Alexa, Samsung SmartThings, and Home Assistant. By setting up your Zigbee sensor with the Smart Bridge, it transforms into a Matter compatible door sensor, enabling local control through Matter. Third Reality also offers the 3R-Installer App, which lets you configure Zigbee sensor attributes such as default-on behavior and perform firmware updates.

1. Ensure your bridge is already set up within your smart home system.
2. Press to open part A (Fig. 2), install the batteries and close the back cover, the LED indicator flashes rapidly in blue, the sensor is now ready for setup. If this sequence doesn't occur, long press the reset button (Fig. 3) for 3 seconds to factory reset the sensor and put it into pairing mode again.
3. Press the pinhole button on the bridge to activate Zigbee pairing mode. The Zigbee blue LED should start blinking.
4. The sensor will pair with the bridge, and a new device will appear in your smart home app, such as Google Home or Alexa.
5. Optionally, you can install the 3R-Installer App and set the open delay time by smart bridge. Then, use the multi-admin feature in your smart home app to share permissions with the 3R-Installer App.

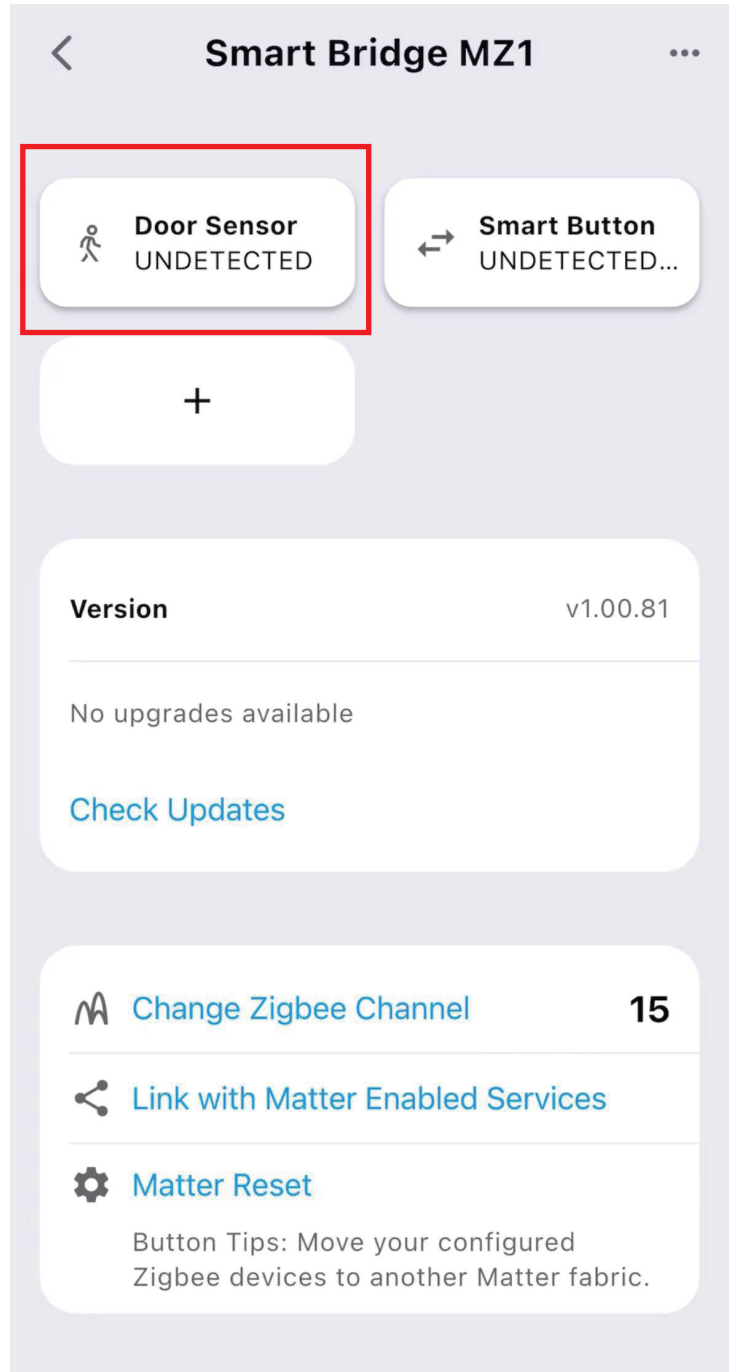
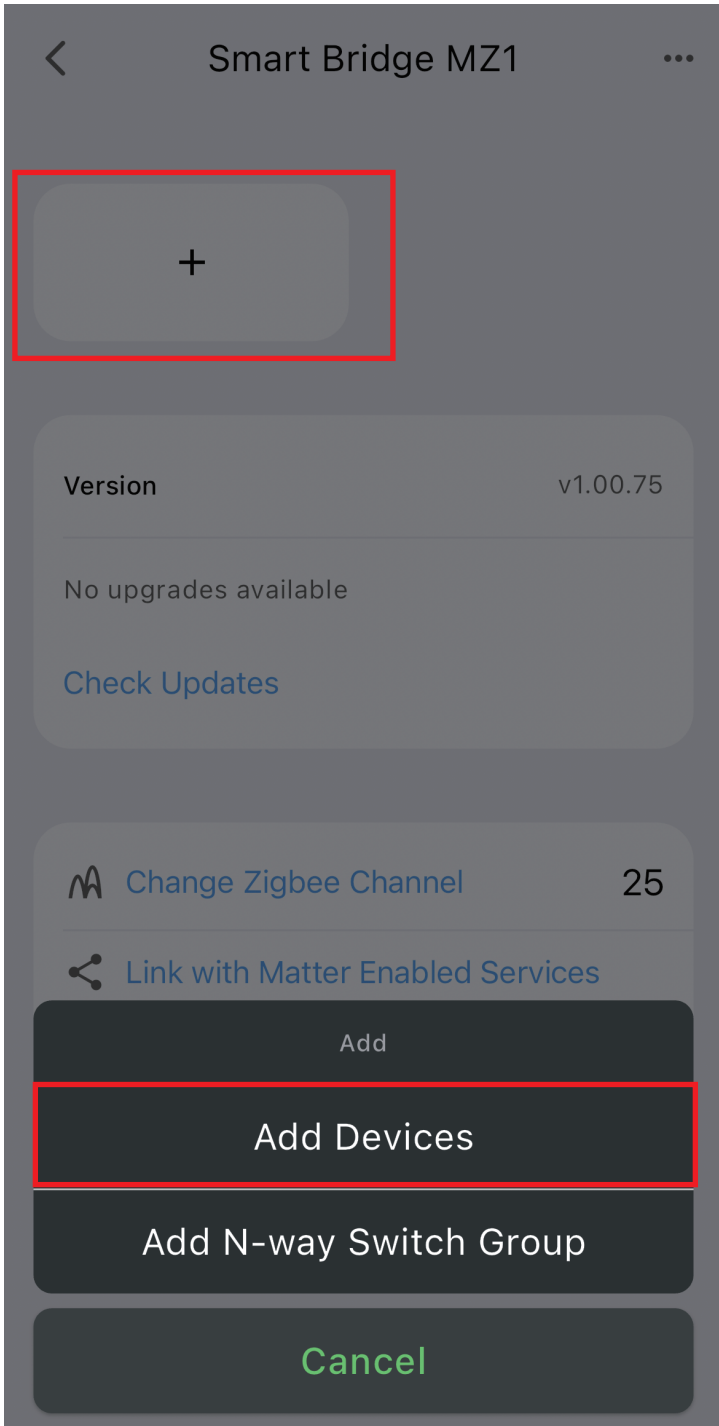
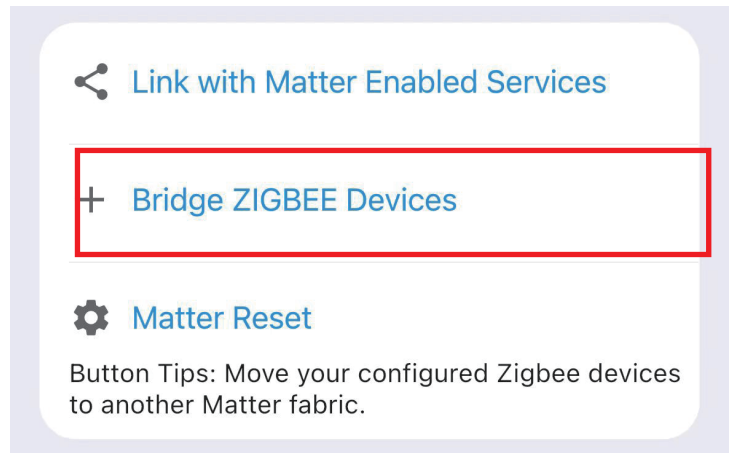
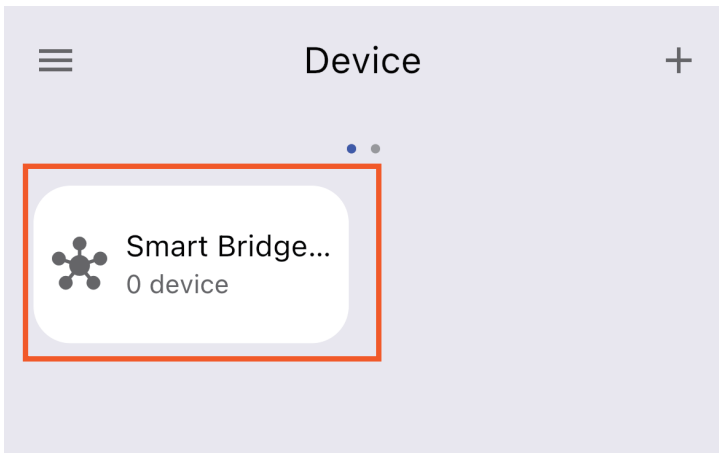

Door Sensor

UNDETECTED

Battery 100%

Open Delay Time 0 s
This feature delays the reporting of the door's open status by a specified time.

Version v1.00.63
No upgrades available
[Check Updates](#)

[Change Zigbee Channel](#) 25

[Link with Matter Enabled Services](#)

[Matter Reset](#)
Button Tips: Move your configured Zigbee devices to another Matter fabric.

Link with Manual Setup Code or Scan the QR Code
Effective duration: 2 minutes 54 seconds

1324-192-6558 



[Done](#)

Setup with Third Reality Hub and SKILL

The Third Reality Hub (sold separately) allows you to control your device remotely via the Third Reality App, making it a great option for smart home beginners or those without a system from major providers. Additionally, the Third Reality Cloud supports SKILL integration with Google Home or Amazon Alexa, enabling you to connect your device to these platforms. However, due to the potential for slow and unreliable Cloud-to-Cloud connections, we recommend using the Bridge solution if Google Home or Alexa is your primary smart home platform.

1. Ensure your hub is properly set up with Third Reality App.
2. Press to open part A (Fig. 2), install the batteries and close the back cover, the LED indicator flashes rapidly in blue, the sensor is now ready for setup. If this sequence doesn't occur, long press the reset button (Fig. 3) for 3 seconds to factory reset the sensor and put it into pairing mode again.
3. Open the Third Reality App, press the “+” icon next to the hub, and select “Quick Pair.”
4. The sensor will pair with your hub and appear in the Third Reality App.
5. Optionally, you can enable the Third Reality SKILL in either the Alexa or Google Home app to enable Cloud-to-Cloud communication.

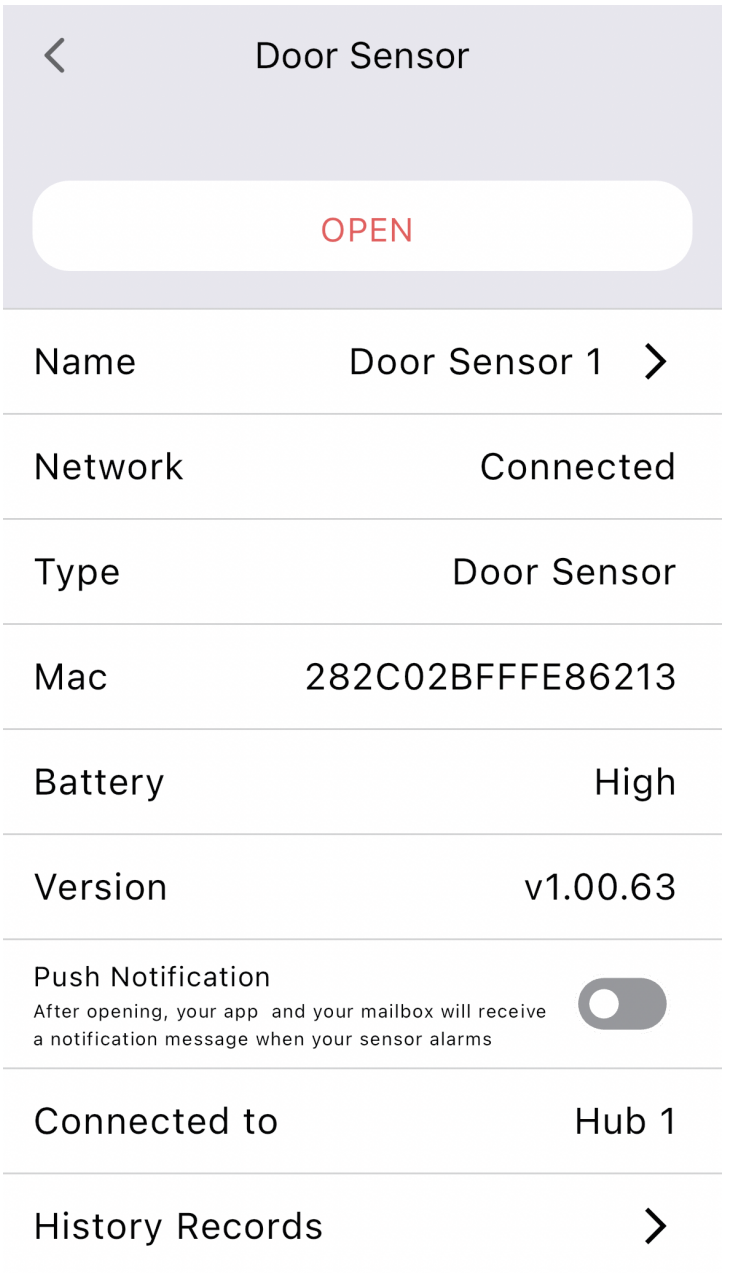
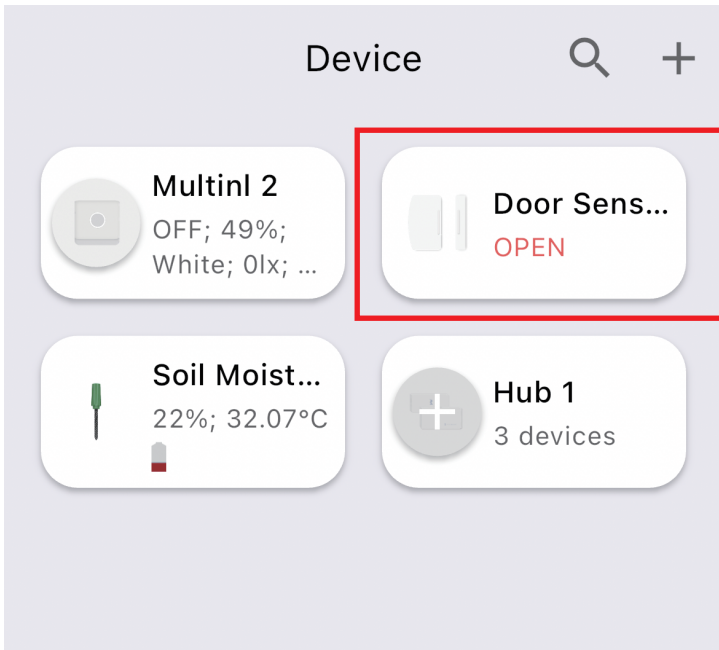
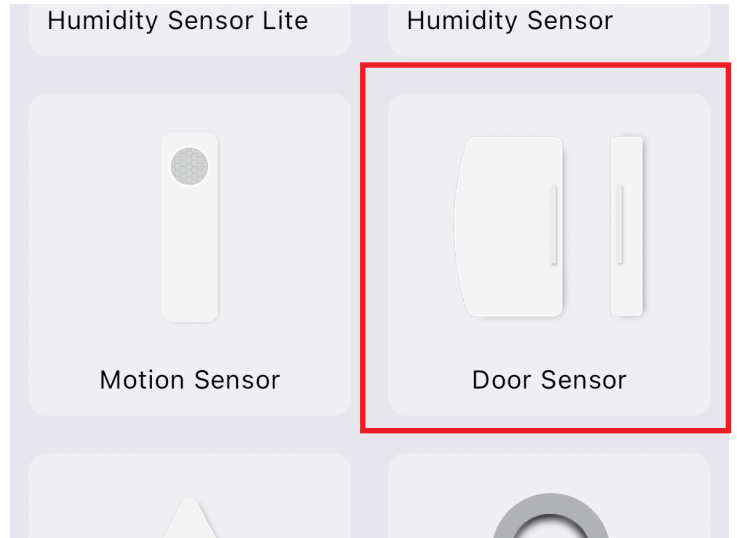
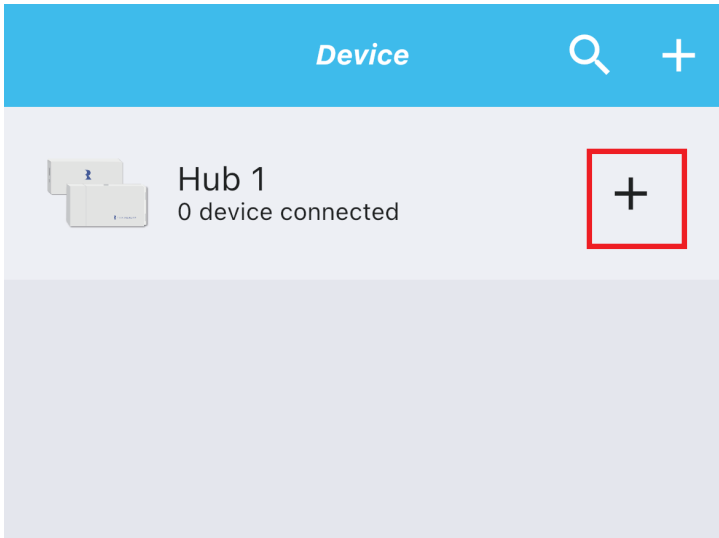

Setup with Compatible Third-Party Zigbee Hubs

Third Reality supports integration with various open Zigbee platforms, including Amazon Echo with built-in Zigbee, Samsung SmartThings, Home Assistant (with ZHA or Z2M), Homey and Hubitat. If you own any of these devices, you can pair the door sensor directly without the need for an additional bridge or hub.

1. Ensure your Zigbee Hub is already set up within your smart home system.
2. Press to open part A (Fig. 2), install the batteries and close the back cover, the LED indicator flashes rapidly in blue, the sensor is now ready for setup. If this sequence doesn't occur, long press the reset button (Fig. 3) for 3 seconds to factory reset the sensor and put it into pairing mode again.
3. Open your smart home app and follow the on-screen instructions to begin the Zigbee pairing process.
4. The door sensor will flash and then turn red, indicating it has successfully paired with the Zigbee hub.
5. You can now use your smart home app to turn the sensor on/off.

Pairing with SmartThings

App: SmartThings App

Devices: SmartThings Hub 2nd Gen(2015) and 3rd Gen(2018), Aeotec Smart Home Hub.



Pairing steps:

1. Before pairing, check for updates to make sure the SmartThings Hub firmware is up to date.
2. Add SmartThings drivers for Third Reality Door Sensor
 - Open this link in your PC browser. Log in your SmartThings Account.
<https://bestow-regional.api.smartthings.com/invite/adMKr50EXzj9>
 - Click "Enroll" -- "Available Drivers" -- "Install" to install the device driver.

SmartThings

Channel Information

- Name
Third Reality
- Description
SmartThings driver for Third Reality devices
- [Terms of Service](#)

My Hubs

Aeotec Hub

My home

Enroll

SmartThings

Channel Information

- Name
Third Reality
- Description
SmartThings driver for Third Reality devices
- [Terms of Service](#)

My Hubs

Aeotec Hub

My home

Unenroll

Available Drivers

SmartThings

Third Reality

Aeotec Hub

My home

- Name
Zigbee Window Treatment
- Description
ThirdReality window treatment devices drivers
- Permissions
 - zigbee: Enable full access to Zigbee actions

Install

3. Press to open part A (Fig. 2), install the batteries and close the back cover, the LED indicator flashes rapidly in blue, the sensor is now ready for setup. If this sequence doesn't occur, long press the reset button (Fig. 3) for 3 seconds to factory reset the sensor and put it into pairing mode again.
4. Open your SmartThings App, tap "+" on the up right corner to "Add device" and then tap "Scan nearby".

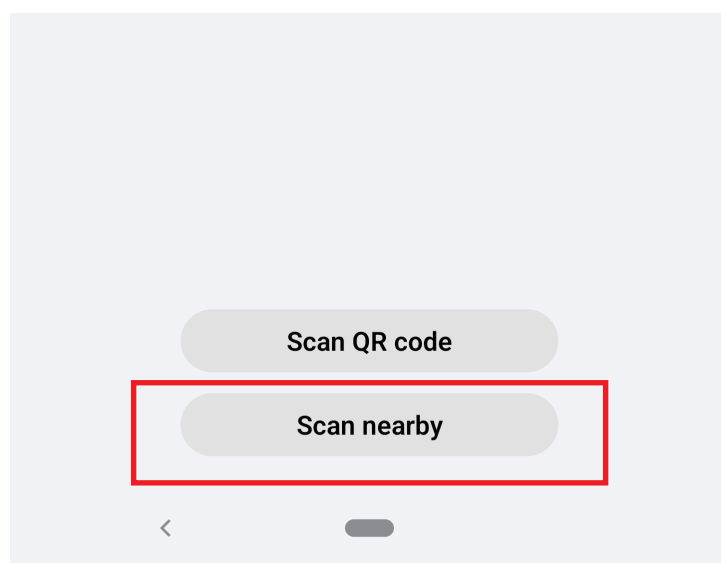
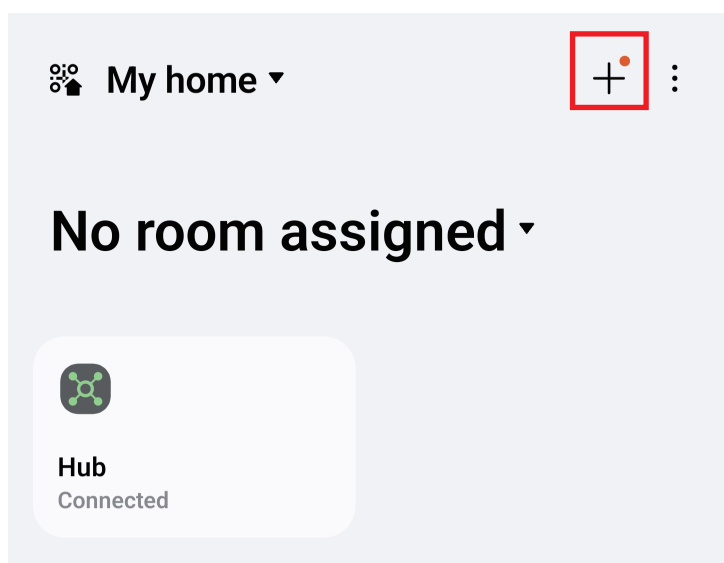

5. The sensor will be added to your SmartThings hub in a few seconds.

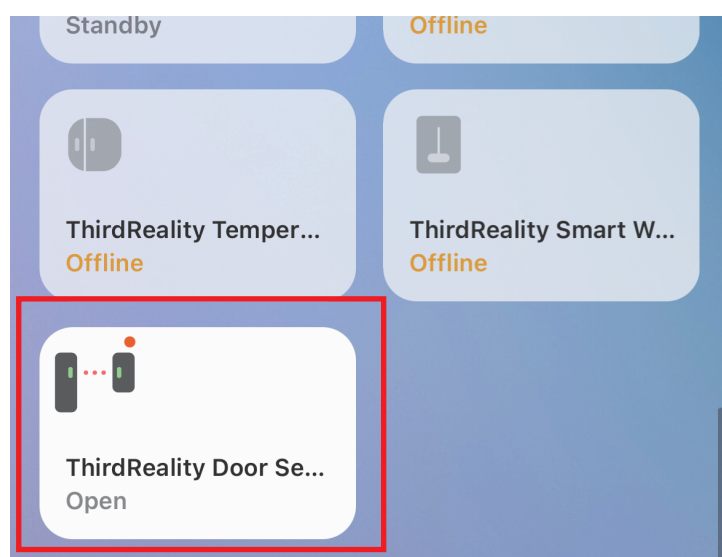
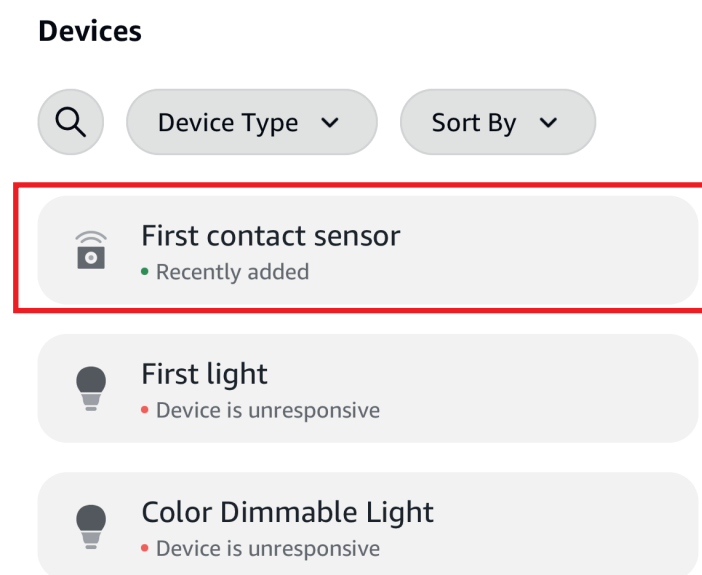

6. Create routines to control connected devices.

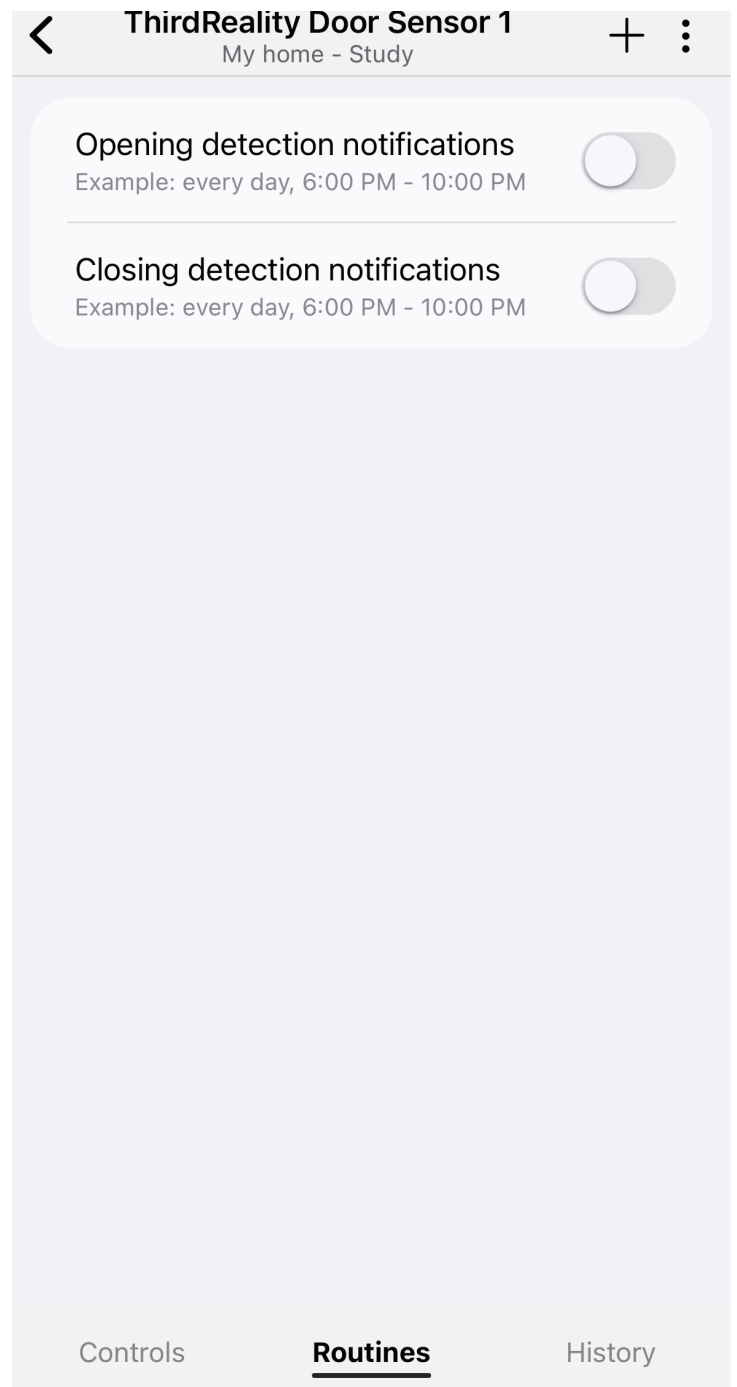
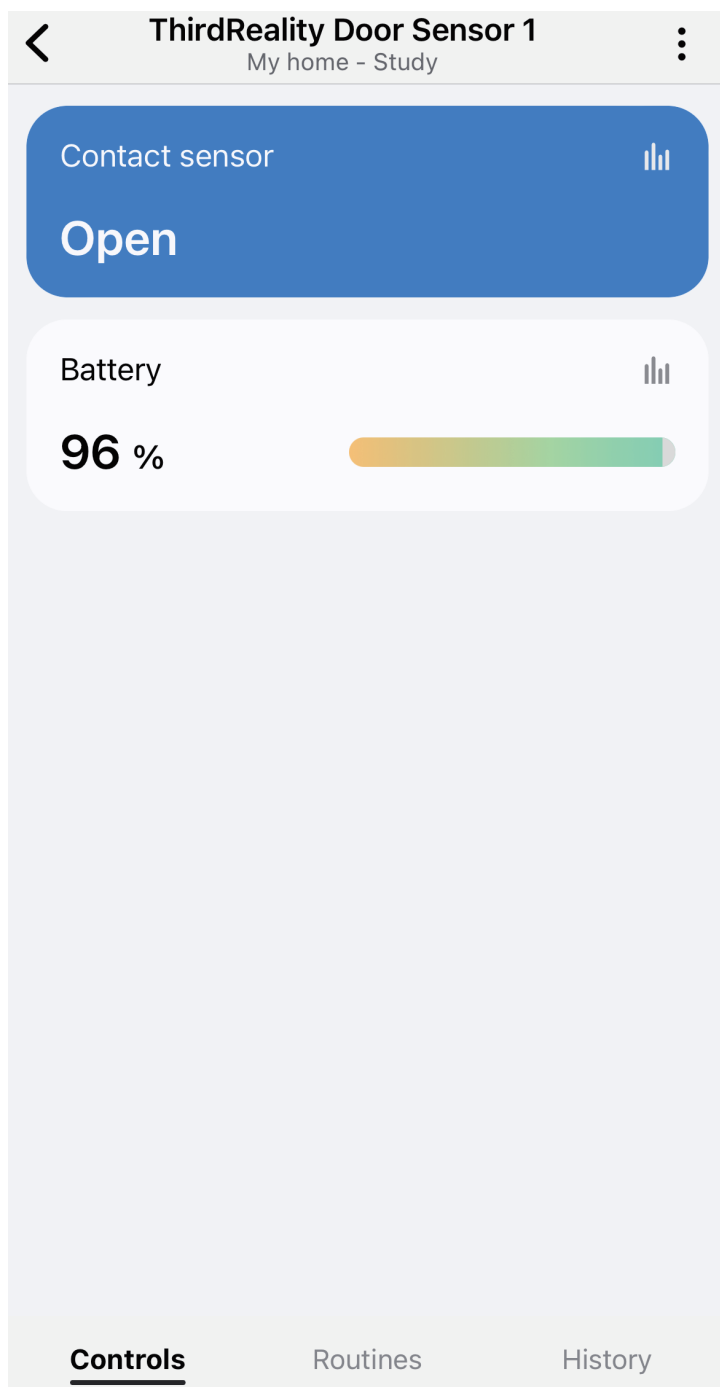

Pairing with Amazon Alexa

App: Amazon Alexa

Devices: Echo speakers with built-in Zigbee hub, Echo 4th Gen, Echo Plus 1st & 2nd Gen, Echo Studio



Pairing steps:

1. Ask Alexa to check for updates before pairing.
2. Press to open part A (Fig. 2), install the batteries and close the back cover, the LED indicator flashes rapidly in blue, the sensor is now ready for setup. If this sequence doesn't occur, long press the reset button (Fig. 3) for 3 seconds to factory reset the sensor and put it into pairing mode again.
3. Tap "+" in the Alexa App, choose "Other" and "Zigbee" to add device, the sensor will be added.
4. You can create routines with the device.

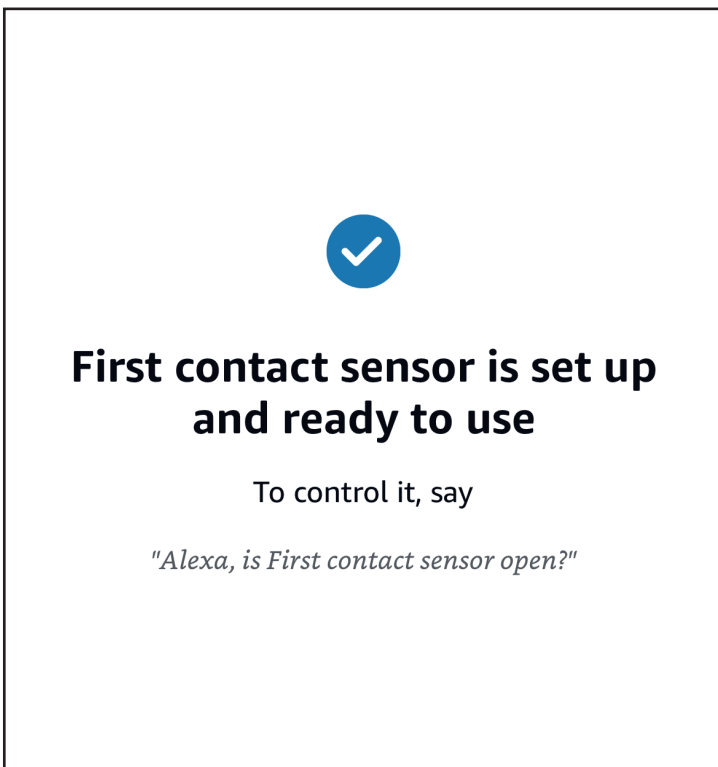
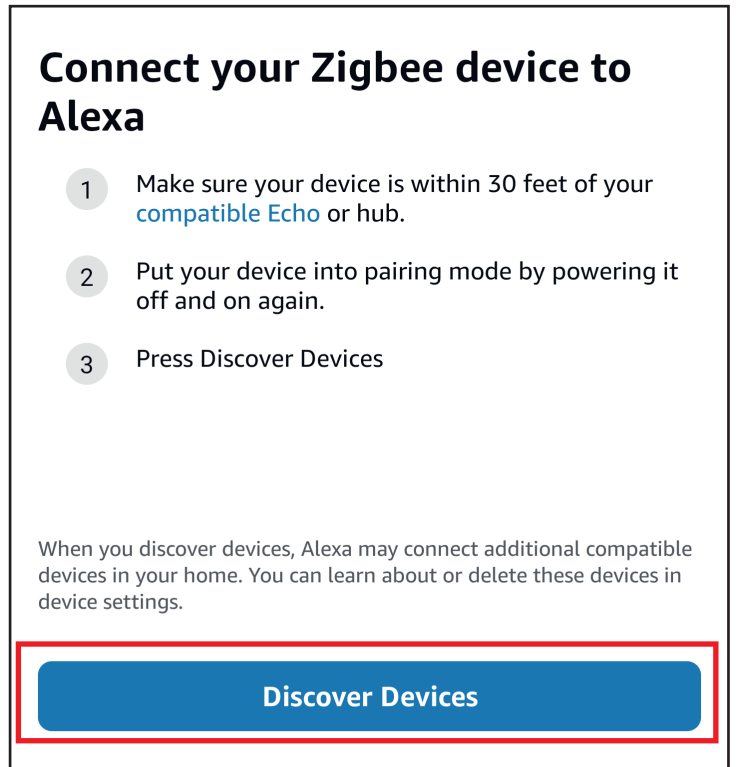
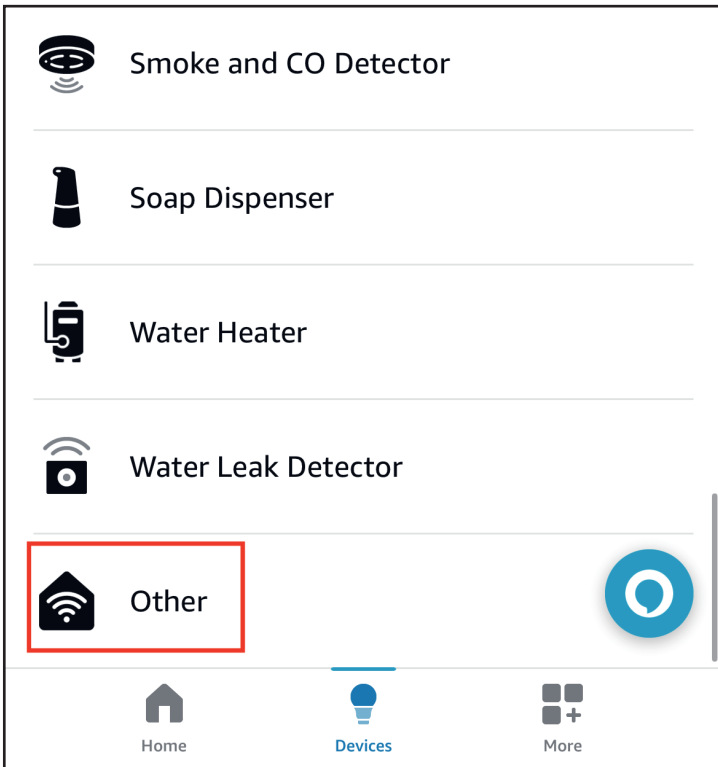
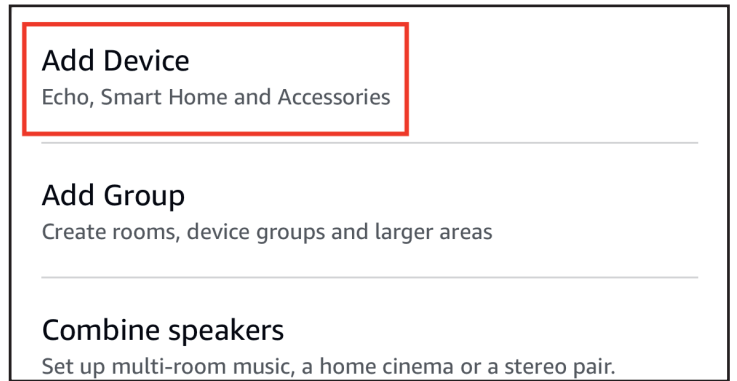
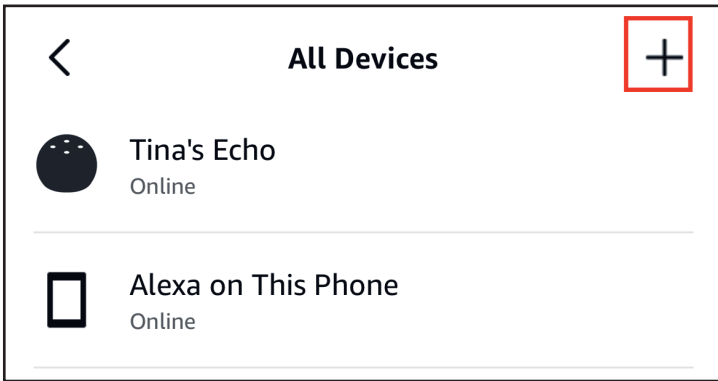

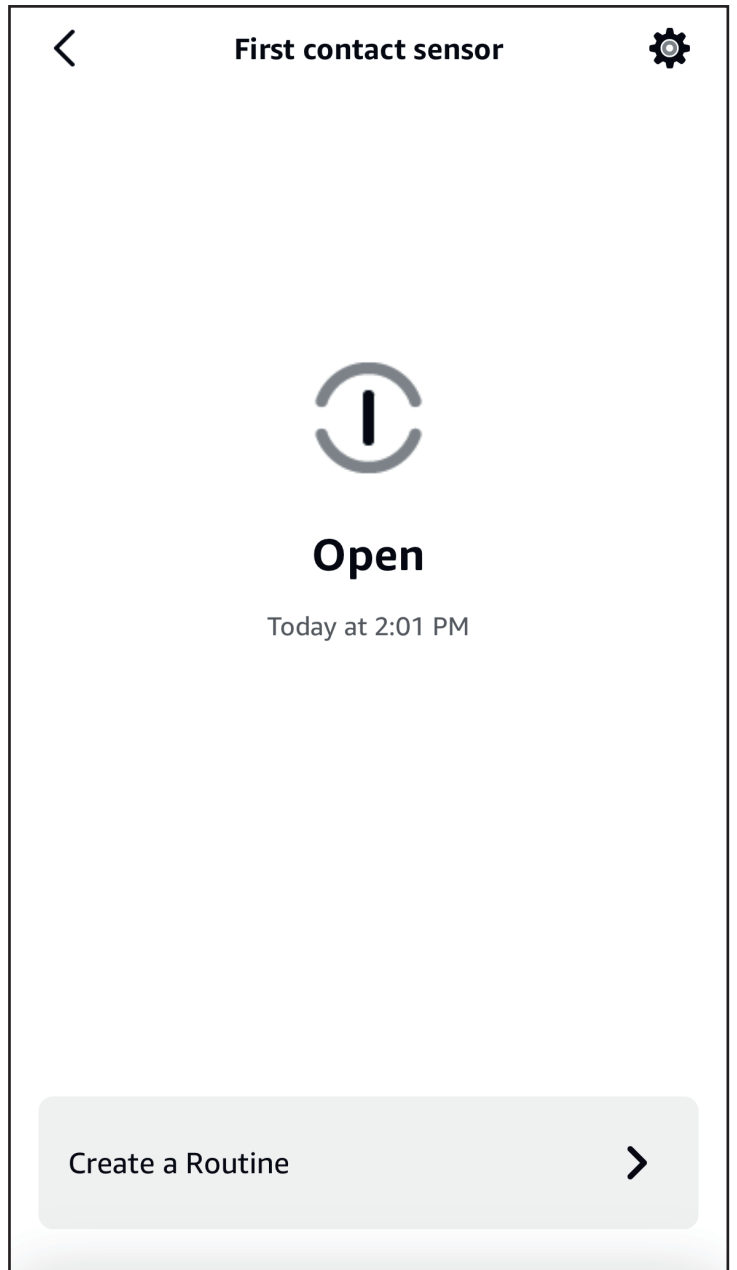
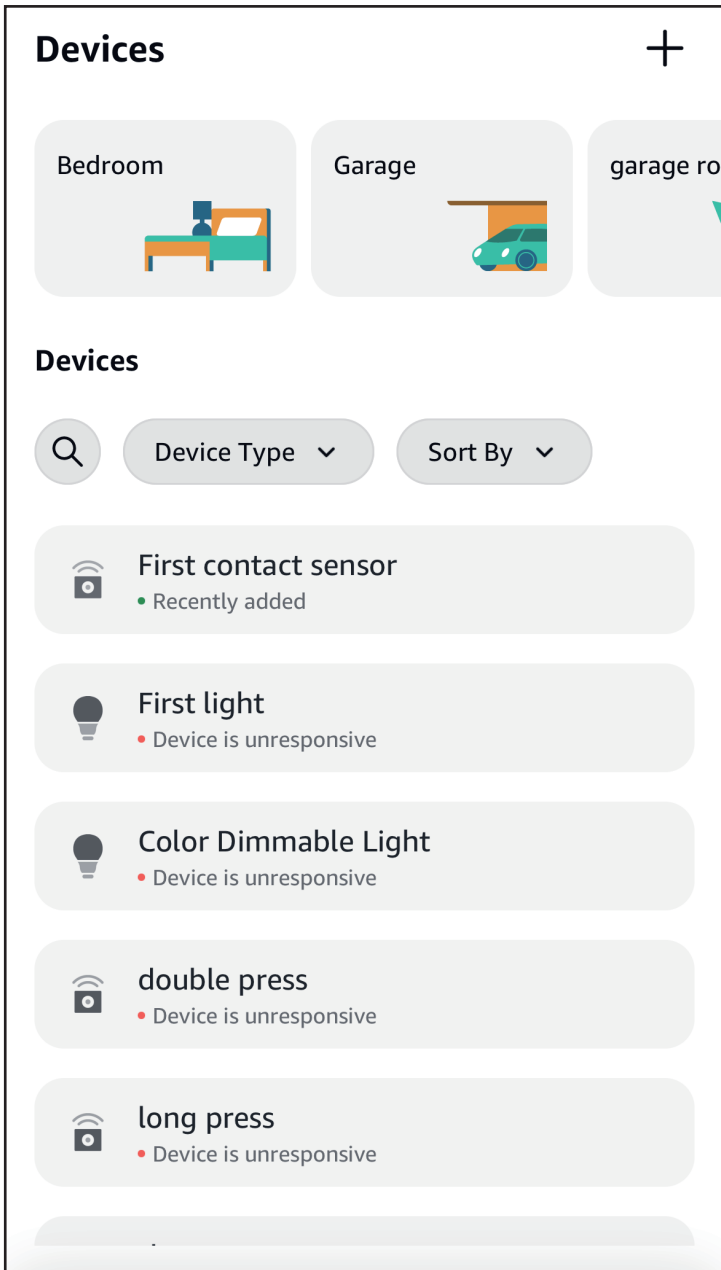

Pairing with Hubitat

Website: <http://find.hubitat.com/>



Pairing steps:

1. Press to open part A (Fig. 2), install the batteries and close the back cover, the LED indicator flashes rapidly in blue, the sensor is now ready for setup. If this sequence doesn't occur, long press the reset button (Fig. 3) for 3 seconds to factory reset the sensor and put it into pairing mode again.
2. Visit your Hubitat Elevation hub device page from your web browser, select the Devices menu item from the sidebar, then select Discover Devices in the upper right.
3. Click Start Zigbee Pairing button after you select a Zigbee device type, the Start Zigbee Pairing button will put the hub in Zigbee pairing mode for 60 seconds.
4. Pairing is completed. Change type to Generic Zigbee Contact Sensor(no temp).
5. Tap Apps, and Create New Basic Rules.

Hubitat **Devices** hubitat-c7

Compatible device list X Clear Search... **+ Add device**

Disable	Label (Name)	Type	Room	Source	DNI	Status	Last Activity	
<input type="checkbox"/>	1 (Advanced Zigbee CT Bulb)	Advanced Zigbee CT Bulb		System	2EA3 B40ECFD298B00000		8/27/2024 10:42:35	
<input checked="" type="checkbox"/>	444 (Device)	Device	huan	System	1315 282C02BFFF909D1			
<input type="checkbox"/>	729ms (Generic Zigbee Motion Sensor (no temp))	Generic Zigbee Motion Sensor (no temp)		System	8439 282C02BFFF909D1		7/29/2024 15:44:55	60
<input type="checkbox"/>	Advanced Zigbee CT Bulb	Advanced Zigbee CT Bulb		System	1AED B40ECFD32AAC0000		8/27/2024 10:42:28	
<input type="checkbox"/>	d4l (Third Reality Smart Button)	Third Reality Smart Button		System	5A05 282C02BFFF909D1		8/06/2024 13:42:54	100
<input type="checkbox"/>	Plant Watering System	Generic Zigbee Switch		System	4F31 282C02BFFF909D1		8/27/2024 10:13:02	
<input type="checkbox"/>	Smart Soil Moisture Sensor (Device)	Generic Zigbee Temperature/Humidity Sensor		System	952B A4C138EEDB829E73			

Documentation Community Videos FAQ Terms of Service Copyright 2018-2024 Hubitat, Inc

Hubitat **Add device** hubitat-c7

Find by device type
Bulbs, dimmers, locks, outlets, switches...

Find by brand
Aeotec, Bosch, Centralite, Dome, Ecolink...

Add device manually:

Zigbee Z-Wave Matter Iris V1 Zigbee

Virtual

Documentation Community Videos FAQ Terms of Service Copyright 2018-2024 Hubitat, Inc

Hubitat Elevate Your Environment

Add device

Home - Zigbee Cancel

Give your new Third Reality Multi-Function Night Light a name:

Door Sensor

Next > **Replace existing device** Pairing info

Documentation Community Videos FAQ Terms of Service Copyright 2018-2024 Hubitat, Inc.

Hubitat Elevate Your Environment

Door Sensor

Enable debug logging

Enable descriptionText logging

Status attribute for Devices/Rooms: None

Save Preferences

Device Information

Device Name * Third Reality Door Sensor Device Network Id * OE3E [edit](#)

Device Label Door Sensor Type * **Generic Zigbee Contact Sensor (no temp)**

Zigbee Id F44250C38A400000 Room No room assigned

Event history size, per event type (1-2000) 11 Hub Mesh enabled

State history size, per attribute (1-2000) 30 HomeKit enabled

Too many events alert threshold, per hour (100-2000) 300

Save Device

Advanced

Send ZWave Command* Send Command

Documentation Community Videos FAQ Terms of Service Copyright 2018-2024 Hubitat, Inc.

Pairing With Home Assistant

Device: Zigbee dongle



Zigbee Home Automation

1. Press to open part A (Fig. 2), install the batteries and close the back cover, the LED indicator flashes rapidly in blue, the sensor is now ready for setup. If this sequence doesn't occur, long press the reset button (Fig. 3) for 3 seconds to factory reset the sensor and put it into pairing mode again.
2. In Zigbee Home Automation, go to "Configuration" page, click "integration".
3. Then click the "Devices" on the Zigbee item, the click "Add Devices".
4. Pairing completed.
5. Back to "Devices" page to find the sensor added.
6. Click to enter in the control interface to see detailed information .
7. Click "+" belongs to Automation and add trigger and actions.

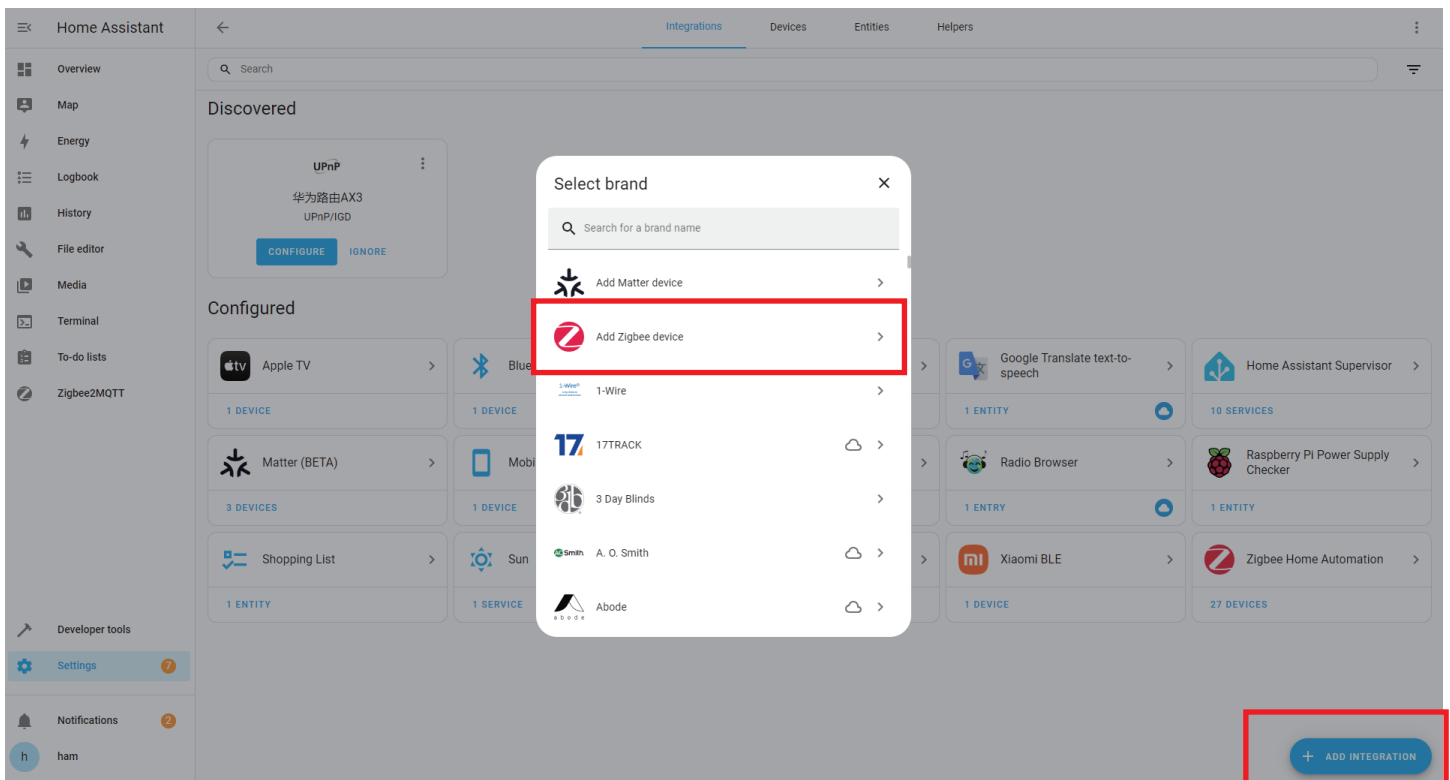
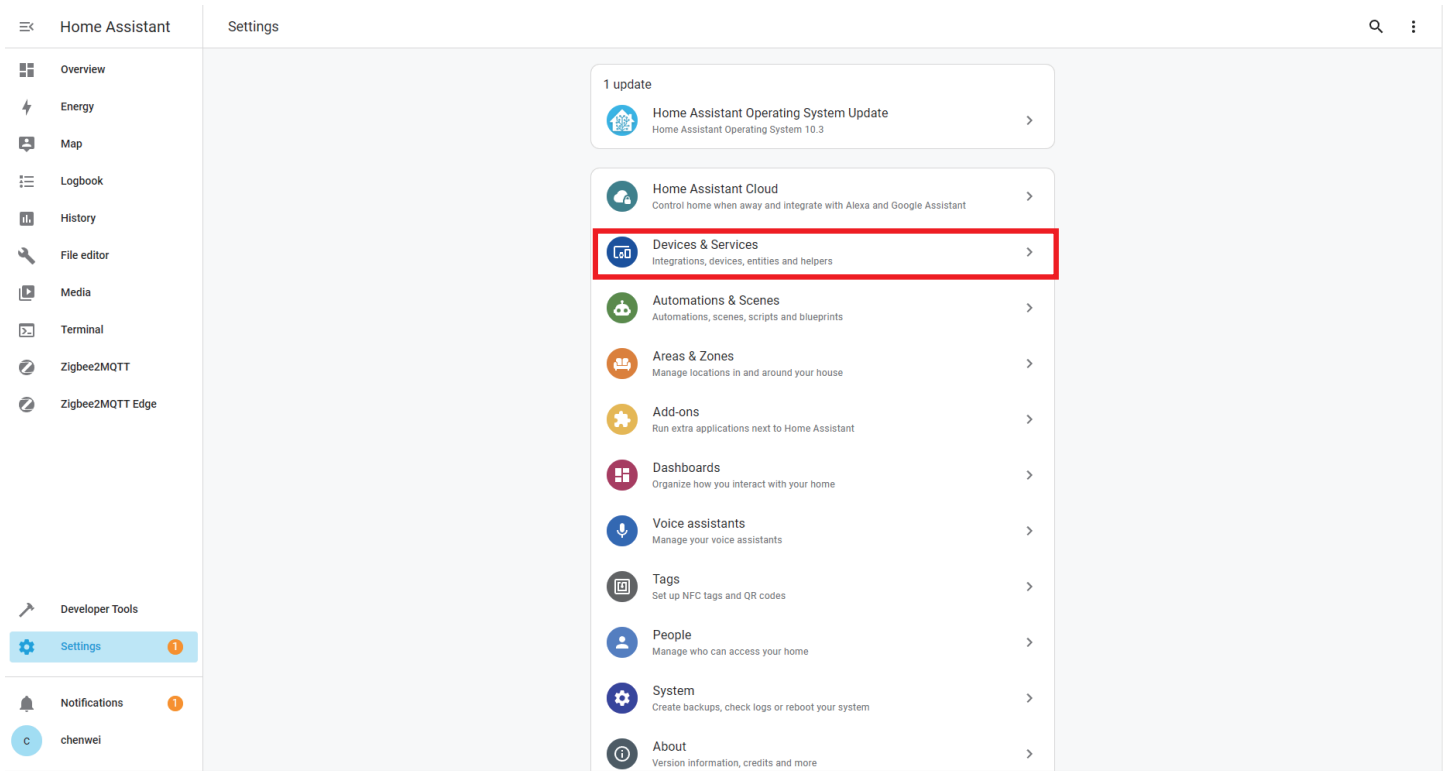

Home Assistant

Integrations **Devices** Entities Helpers

Filters Search 28 devices Group by Sort by Device

Device	Manufacturer	Model	Area	Integration	Battery
red button	Third Reality, Inc	3RSB228Z	Living Room	Zigbee Home Automation	-
Silicon Labs EZSP	Silicon Labs	EZSP	-	Zigbee Home Automation	-
Third Reality 3RTHS0224Z	Third Reality	3RTHS0224Z	-	Zigbee Home Automation	100%
Third Reality 3RTHS0224Z	Third Reality	3RTHS0224Z	-	Zigbee Home Automation	-
Third Reality 3RTHS0224Z	Third Reality	3RTHS0224Z	-	Zigbee Home Automation	-
Third Reality, Inc 3RDS17BZ	Third Reality, Inc	3RDS17BZ	-	Zigbee Home Automation	92%
Third Reality, Inc 3RDS01056Z	Third Reality, Inc	3RDS01056Z	-	Zigbee Home Automation	-
Third Reality, Inc 3RDS01056Z	Third Reality, Inc	3RDS01056Z	-	Zigbee Home Automation	-
Third Reality, Inc 3RMS16BZ	Third Reality, Inc	3RMS16BZ	-	Zigbee Home Automation	-
Third Reality, Inc 3RMS16BZ	Third Reality, Inc	3RMS16BZ	-	Zigbee Home Automation	-
Third Reality, Inc 3RMS16BZ	Third Reality, Inc	3RMS16BZ	-	Zigbee Home Automation	-
Third Reality, Inc 3RMS16BZ	Third Reality, Inc	3RMS16BZ	-	Zigbee Home Automation	-
Third Reality, Inc 3RSNL02043Z	Third Reality, Inc	3RSNL02043Z	office	Zigbee Home Automation	-
Third Reality, Inc 3RSP02028BZ	Third Reality, Inc	3RSP02028BZ	-	Zigbee Home Automation	-
Third Reality, Inc 3RSS009Z	Third Reality, Inc	3RSS009Z	-	Zigbee Home Automation	-

ADD DEVICE

Home Assistant

← Third Reality, Inc 3RDS17BZ

92%

Device info

3RDS17BZ
by Third Reality, Inc
Firmware: 0x0000003f

Zigbee info

Zigbee Home Automation

RECONFIGURE

Sensors

Opening Open

[ADD TO DASHBOARD](#)

Logbook

November 8, 2024

Third Reality, Inc 3RDS17BZ Opening was opened
11:00:59 AM - 3 minutes ago

Automations

No automations have been added using this device yet. You can add one by clicking the + button above.

Configuration

Firmware Up-to-date

[ADD TO DASHBOARD](#)

Diagnostic

Battery 92%

+2 entities not shown

[ADD TO DASHBOARD](#)

Scenes

No scenes have been added using this device yet. You can add one by clicking the + button above.

Scripts

No scripts have been added using this device yet. You can add one by clicking the + button above.

Zigbee2MQTT

1. Press to open part A (Fig. 2), install the batteries and close the back cover, the LED indicator flashes rapidly in blue, the sensor is now ready for setup. If this sequence doesn't occur, long press the reset button (Fig. 3) for 3 seconds to factory reset the sensor and put it into pairing mode again.
2. Permit join to start Zigbee pairing in Zigbee2MQTT.
3. Pairing completed, the sensor will be displayed in the device list
Go to Settings page, create automation.

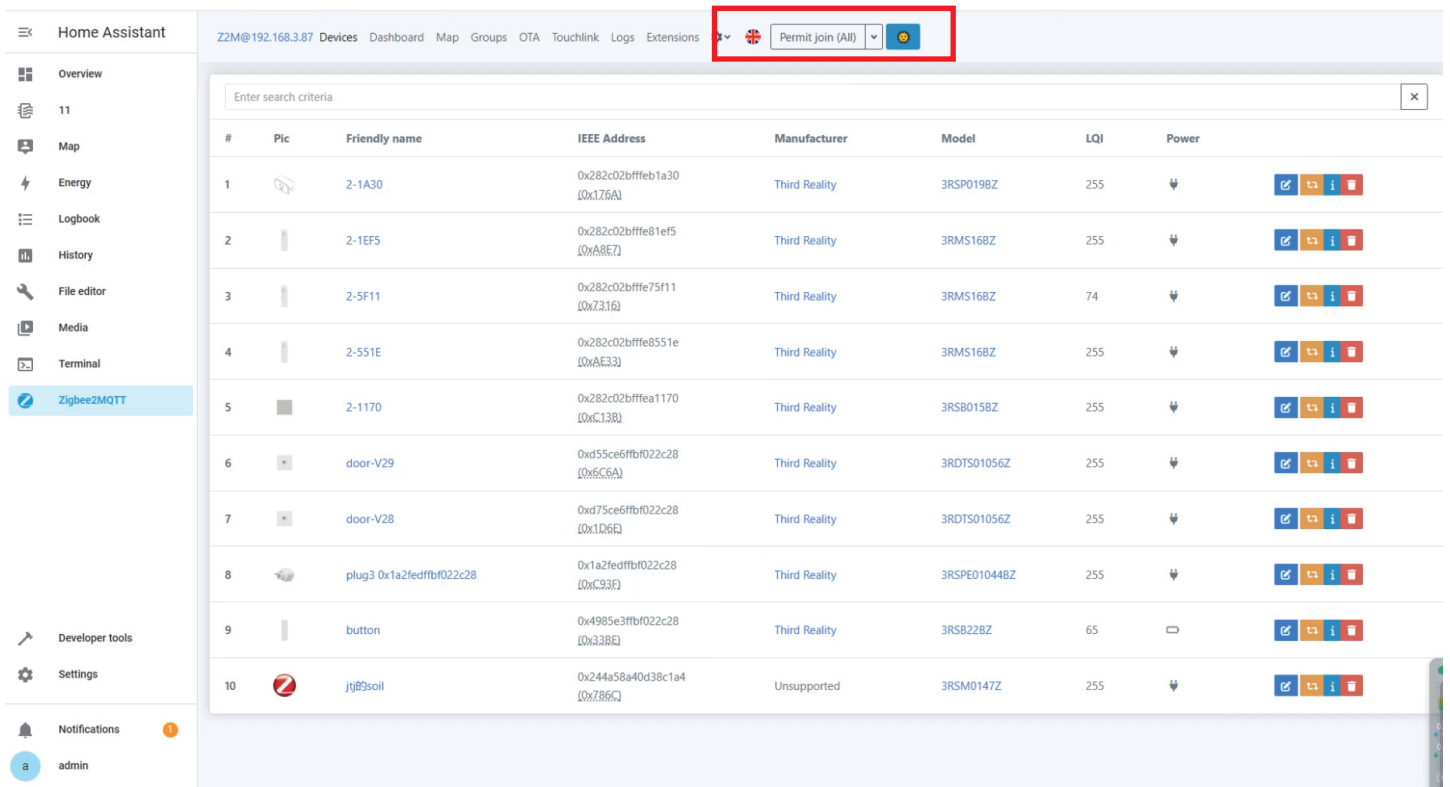

The screenshot shows the Home Assistant interface with the Zigbee2MQTT integration active. The top navigation bar includes 'Home Assistant', 'Z2M@192.168.3.87', and various menu items. A red box highlights the 'Permit join (All)' button in the top right corner. Below this is a search bar and a table of devices.

#	Pic	Friendly name	IEEE Address	Manufacturer	Model	LQI	Power	
1		2-1A30	0x282c02bfff1a30 [0x176A]	Third Reality	3RSP019BZ	255	↓	
2		2-1EF5	0x282c02bfff81ef5 [0xA8E7]	Third Reality	3RMS16BZ	255	↓	
3		2-5F11	0x282c02bfff75f11 [0x7316]	Third Reality	3RMS16BZ	74	↓	
4		2-551E	0x282c02bfff8551e [0xAE33]	Third Reality	3RMS16BZ	255	↓	
5		2-1170	0x282c02bffa1170 [0xC138]	Third Reality	3RSB015BZ	255	↓	
6		door-V29	0xd55ce6ffb022c28 [0x6C6A]	Third Reality	3RDT501056Z	255	↓	
7		door-V28	0xd75ce6ffb022c28 [0x1D6E]	Third Reality	3RDT501056Z	255	↓	
8		plug3 0x1a2fedffb022c28	0x1a2fedffb022c28 [0xC93E]	Third Reality	3RSPE01044BZ	255	↓	
9		button	0x4985e3ffb022c28 [0x338E]	Third Reality	3RSB22BZ	65	□	
10		jtj89soil	0x244a58a40d38c1a4 [0x786C]	Unsupported	3RSM0147Z	255	↓	

- Overview
- 11
- Map
- Energy
- Logbook
- History
- File editor
- Media
- Terminal
- Zigbee2MQTT
- Developer tools
- Settings 7
- Notifications 1
- admin

3		2-5F11	0x282c02bffe75f11 (0x7316)	Third Reality	3RMS16BZ	74		
4		2-551E	0x282c02bffe8551e (0xAE33)	Third Reality	3RMS16BZ	255		
5		2-1170	0x282c02bffe1170 (0xC138)	Third Reality	3RSB0158Z	255		
6		door-V29	0xd55ce6ffb022c28 (0x6C6A)	Third Reality	3RDS01056Z	255		
7		door-V28	0xd75ce6ffb022c28 (0x1D6E)	Third Reality	3RDS01056Z	255		
8		huan-switch	0x282c02bffe900c0 (0x13EE)	Third Reality	3RSS009Z	255		
9		wl	0x7cb94c6334c80000 (0x9982)	Third Reality	3RCB01057Z	255		
10		zzx-sengled	0xb0ce18140015bd64 (0x8F9B)	Sengled	E21-N1EA	23		
11		zzx-philips	0x00178801042be004 (0xA3E0)	Philips	9290012573A	210		
12		zzx-light	0xb40ecfd2dc210000 (0x0885)	Third Reality	3RCB01057Z	255		
13		0x282c02bffe8c05a	0x282c02bffe8c05a (0xE31B)	Third Reality	3RWS18BZ	211	?	
14		0xf44250c3818d0000	0xf44250c3818d0000 (0xC8C2)	Third Reality	3RSNL02043Z	42		
15		0x282c02bffe86213	0x282c02bffe86213 (0xBCCD)	Third Reality	3RDS17BZ	255		

- Overview
- 11
- Map
- Energy
- Logbook
- History
- File editor
- Media
- Terminal
- Zigbee2MQTT
- Developer tools
- Settings 7
- Notifications 1
- admin

0x282c02bffe86213 ▾

About Exposes Bind Reporting Settings Settings (specific) State Clusters Scene Dev console

Contact
Indicates if the contact is closed (= true) or open (= false) **Open**

Battery low
Indicates if the battery of this device is almost empty **False**

Battery
Remaining battery in %, can take up to 24 hours before reported **95 %**

Voltage
Voltage of the battery in millivolts **3000 mV**

Linkquality
Link quality (signal strength) **255 lqi**

Troubleshooting

1. Why can't my Echo discover the door sensor? It has a ZigBee hub built-in.

- Reboot your Echo by unplugging/plugging it back in.
- Set the door sensor into pairing mode by long press the reset button inside the device, the blue LED flashes rapidly.
- Keep the door sensor near the Echo with ZigBee hub build-in, then ask Alexa to “discover devices”.
- If it is still not working, please factory reset your Echo, re-add echo then re-discover device again, then pair it with your Echo device again.

2. I have a SmartThings hub, do I need a special hub for the door sensor?

- Enable the SmartThings Skill in your Alexa app and sign in to link your accounts on both platforms.
- Go to Devices tab in your Alexa app and add devices to sync your devices under SmartThings to Alexa: “+” icon (on the upper right corner) -> Add Device -> Other.
- Create a routine for the door sensor and light switches in your Alexa app, you can use door open/close to trigger things like light on/off, or you can set an Alexa “custom message” when the door sensor detects a door is opened.

3. Why nothing shows up for devices or group on the Third Reality app? I am using a SmartThings hub.

Because you are using Echo (Alexa APP) and SmartThings (SmartThings APP), it will bypass Third Reality app. Only when you are using Third Reality Hub (which is equivalent to SmartThings Hub), then the Third Reality app is required and will show the device in the app.

FCC Regulatory Conformance

This device complies with part 15 of the FCC rules. Operation is subject to the following two conditions: (1) this device may not cause harmful interference, and (2) this device must accept any interference received, including interference that may cause undesired operation.

Changes or modifications not expressly approved by the party responsible for compliance could void the user's authority to operate the equipment.

NOTE: This equipment has been tested and found to comply with the limits for a Class B digital device, pursuant to part 15 of the FCC Rules. These limits are designed to provide reasonable protection against harmful interference in a residential installation.

This equipment generates uses and can radiate radio frequency energy and, if not installed and used in accordance with the instructions, may cause harmful interference to radio communications. However, there is no guarantee that interference will not occur in a particular installation. If this equipment does cause harmful interference to radio or television reception, which can be determined by turning the equipment off and on, the user is encouraged to try to correct the interference by one or more of the following measures:

- Reorient or relocate the receiving antenna.
- Increase the separation between the equipment and receiver.
- Connect the equipment into an outlet on a circuit different from that to which the receiver is connected.
- Consult the dealer or an experienced radio/TV technician for help important announcement.

NOTE: The manufacturer is not responsible for any radio or TV interference caused by unauthorized modifications to this equipment. Such modifications could void the user's authority to operate the equipment.

Radiation Exposure Statement

This equipment complies with FCC radiation exposure limits set forth for an uncontrolled environment. This equipment should be installed and operated with minimum distance 20cm between the radiator and your body.

This transmitter must not be co-located or operating in conjunction with any other antenna or transmitter.

Limited Warranty

For limited warranty, please visit <https://3reality.com/faq-help-center/>. For customer support, please contact us at info@3reality.com or visit www.3reality.com.

For question on other platforms, visit for corresponding platform's application/support platforms.

ISED Statement

- English: This device complies with Industry Canada license - exempt RSS standard(s). Operation is subject to the following two conditions: (1) This device may not cause interference, and (2) This device must accept any interference, including interference that may cause undesired operation of the device. The digital apparatus complies with Canadian CAN ICES - 3 (B)/NMB - 3(B).

- French: Le présent appareil est conforme aux CNR d'Industrie Canada applicables aux appareils radio exempts de licence. L'exploitation est autorisée aux deux conditions suivantes: (1) l'appareil ne doit pas produire de brouillage, et (2) l'utilisateur de l'appareil doit accepter tout brouillage radioélectrique subi, même si le brouillage est susceptible d'en compromettre le fonctionnement. This radio transmitter has been approved by Industry Canada to operate with the antenna types listed with the maximum permissible gain indicated. Antenna types not included in this list, having a gain greater than the maximum gain indicated for that type, are strictly prohibited for use with this device.

Le présent émetteur radio a été approuvé par Industrie Canada pour fonctionner avec les types d'antenne énumérés ci-dessous et ayant un gain admissible maximal. Les types d'antenne non inclus dans cette liste, et dont le gain est supérieur au gain maximal indiqué, sont strictement interdits pour l'exploitation de l'émetteur.

Radiation Exposure Statement

This equipment complies with Canada radiation exposure limits set forth for an uncontrolled environment. This equipment should be installed and operated with minimum distance 20cm between the radiator & your body.

Déclaration d'exposition aux radiations

Cet équipement est conforme Canada limites d'exposition aux radiations dans un environnement non contrôlé. Cet équipement doit être installé et utilisé à distance minimum de 20cm entre le radiateur et votre corps.

Caution:

The device for operation in the band 5150–5250 MHz is only for indoor use to reduce the potential for harmful interference to co-channel mobile satellite systems;

Avertissement:

les dispositifs fonctionnant dans la bande de 5150 à 5250 MHz sont réservés uniquement pour une utilisation à l'intérieur afin de réduire les risques de brouillage préjudiciable aux systèmes de satellites mobiles utilisant les mêmes canaux;