

Smart Dual Plug ZP1

User Manual



THIRD REALITY

Contents

Specifications	01
Factory Reset	01
Features	02
Setting up your Smart Dual Plug	03
Mesh Network Setup	04
Using your Smart Dual Plug	05
Setup with SmartThings	06
Setup with Third Reality	09
Setup with 3R-Installer	10
Setup with Home Assistant	13
ISED Caution	20
FCC Regulatory Conformance	21
RF Exposure	22
Limited Warranty	22

Specifications

Model Number	3RDP01072Z
Rated Input Voltage	110–120 V AC, 50/60 Hz
Max Combined Output Current	15A Total (shared by both outlets)
Max Combined Output Power	1800 W (at 120 V)
Wireless Connectivity	Zigbee 3.0, 2.4 GHz
Operating Environment	–10°C to 40°C, 5%–90% RH (non-condensing)

Factory Reset

Power on the Smart Plug, then press and hold the button for more than 10 seconds until the red LED light turns on. After that, release the button; the LED will flash rapidly in red.

Features

1. Two sockets allow the user to control them individually, making life easier. When turning off the toaster, it can keep your coffee warm in the machine, so you don't have to worry about starting a fresh day in a rush with a cup of cold coffee.
2. The electricity bill is high, but there's no apparent reason why. Manage your devices wisely! This dual plug also features a separate power metering function, allowing for accurate tracking of small appliances without missing a penny.
3. Its compact size enables two dual plugs to fit into one standard outlet, effectively extending the number of sockets from two to four and eliminating the need for extension leads.
4. Fully Compatible with Home Assistant, SmartThings, Homey, and THIRDREALITY Smart Bridge MZ1. Partial support Thirddreality Hub Gen2 Plus.

Setting up your Smart Dual Plug



LED Indicator	Status
Flashing red	Pairing
LED Light is out	Pairing Completed
Solid red	Power ON
LED Light is off	Power OFF

Insert the Smart Dual Plug into an outlet, it will enter pairing mode automatically.

Pairing with compatible Zigbee hub/bridge

Compatible devices: SmartThings 2015/2018, SmartThings Station, Aeotec, Home Assistant (ZHA/Zigbee2MQTT), Third Reality Hub, Smart Bridge MZ1.

1. Update your hub firmware and phone app to the latest version before pairing, set up your Zigbee Hub by following its user manual.
2. Insert the Smart Plug into an outlet, it will enter pairing mode automatically.
3. Follow the instructions in the corresponding phone app to complete the setup.

Mesh Network Setup

If you have multiple plugs set for different rooms, especially those located far away from your hub with poor signal quality, you can utilize a Mesh Network to extend the signal range.

1. Plug the device into the outlet that is closest to the hub, and then pair it with the hub.
2. Unplug the device and relocate it to a place with a fair to good signal quality. This device will automatically form a Zigbee Mesh Network and function as a node on the web to extend the signal range.

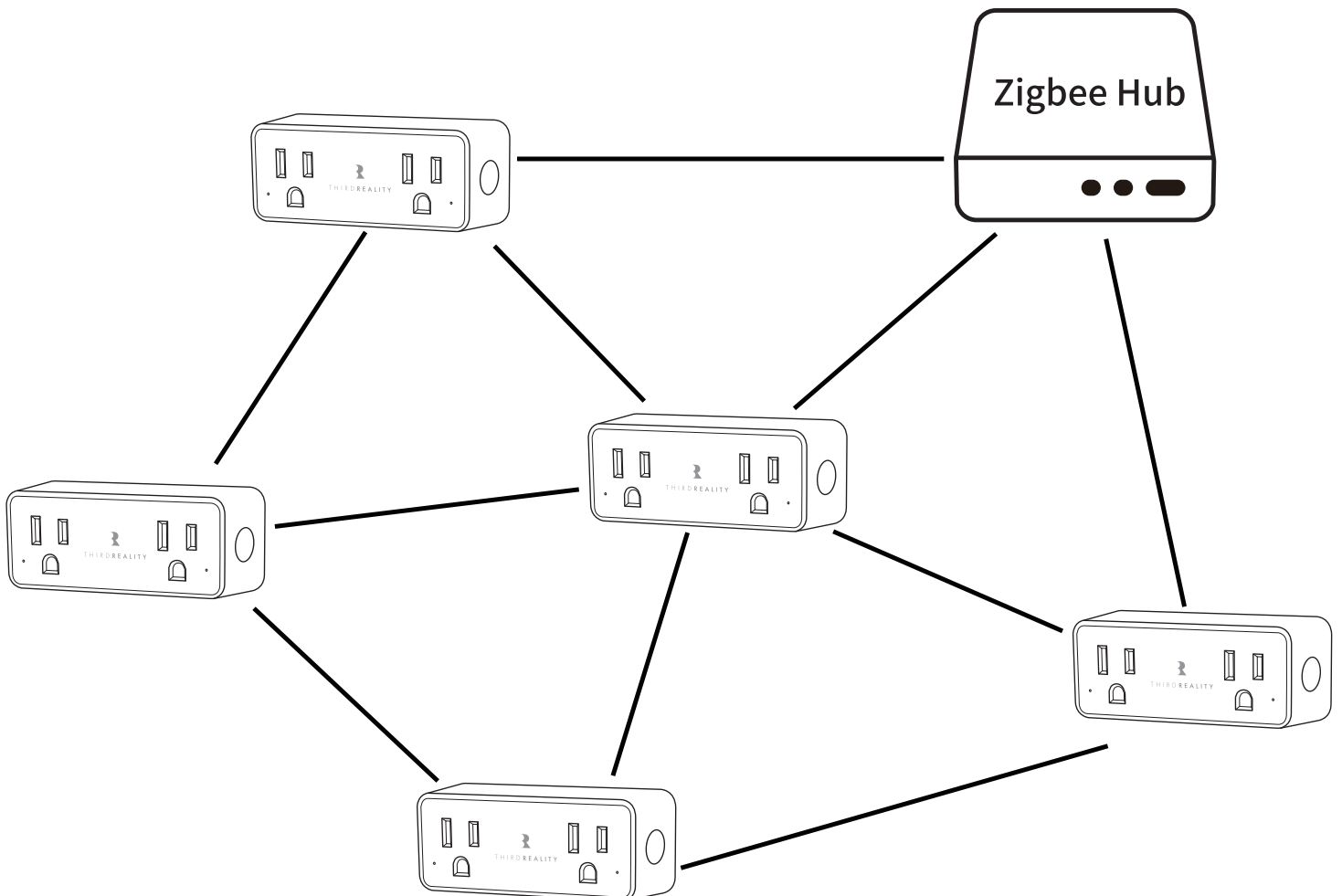

Using your Smart Dual Plug

1. Independent Control and Monitoring

This Smart Dual Plug features two sockets that can be controlled and monitored separately. For example, you can turn off the toaster while keeping the coffee machine on, helping you manage your morning routine more efficiently.

2. Power Consumption Tracking

Each socket supports individual power metering. This allows you to monitor the electricity usage of small appliances separately, making it easier to identify energy consumption patterns. (Note: Power data is for reference only.)

3. Space-Saving Design

The compact form factor allows two Smart Dual Plugs to be used side by side in a standard wall outlet, expanding your available sockets from two to four without the need for extension cords.

Setup with SmartThings

Compatible Devices:

SmartThings 2015/2018, SmartThings Station, Aeotec

App: SmartThings App

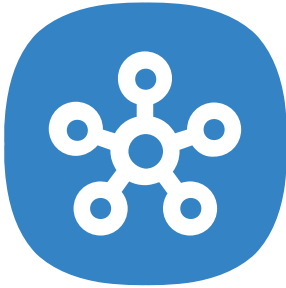

1. Check your SmartThings Hub for firmware updates before pairing the Smart Plug with it.
2. Power on the Smart Plug, then press and hold the button for more than 10 seconds until the red LED light turns on. After that, release the button; the LED will flash rapidly in red. It exits pairing mode within 3 minutes if not successfully paired. To put the plug back into pairing mode.
3. Tap "+" in the upper right corner of your SmartThings App, then tap "Scan for nearby devices." The hub will discover the Smart Dual Plug within seconds. You can see the power meter on the device page.

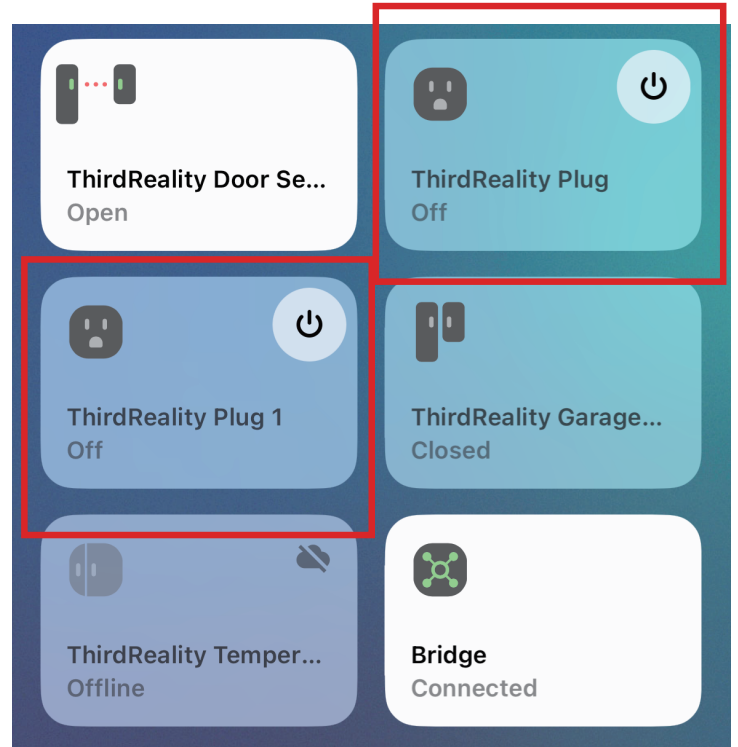
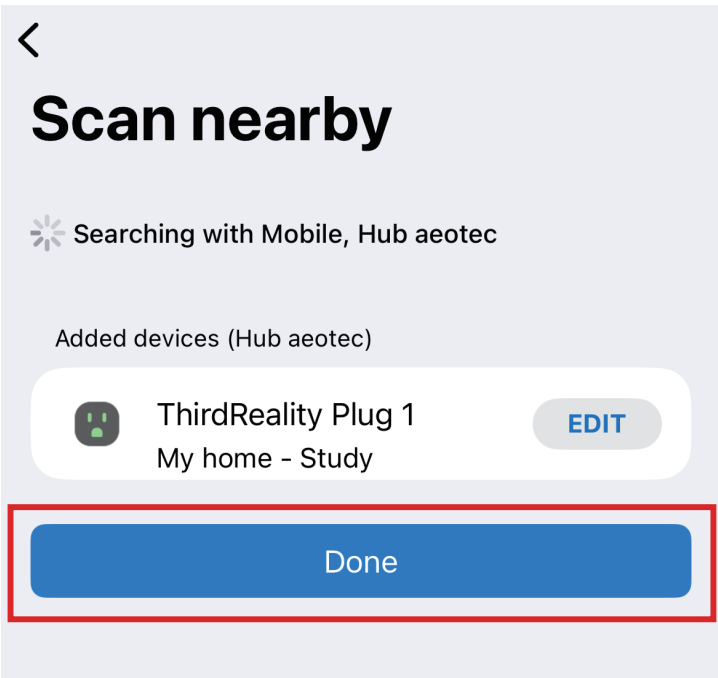
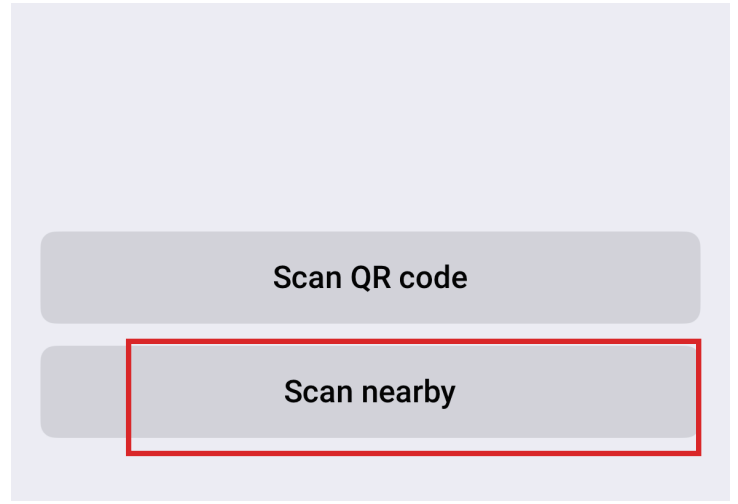
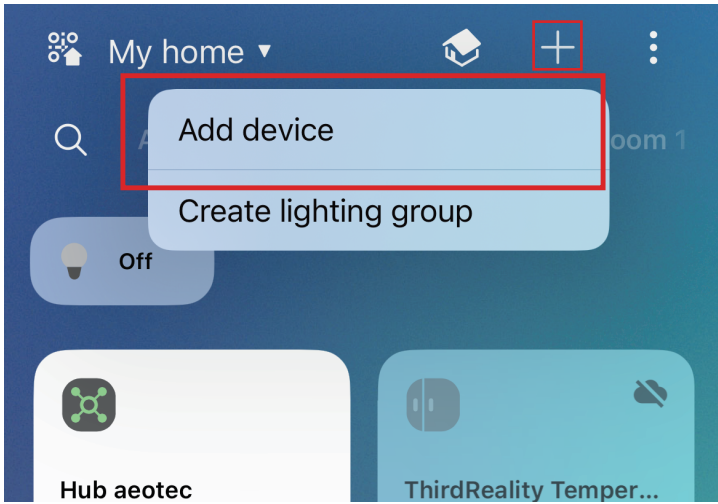

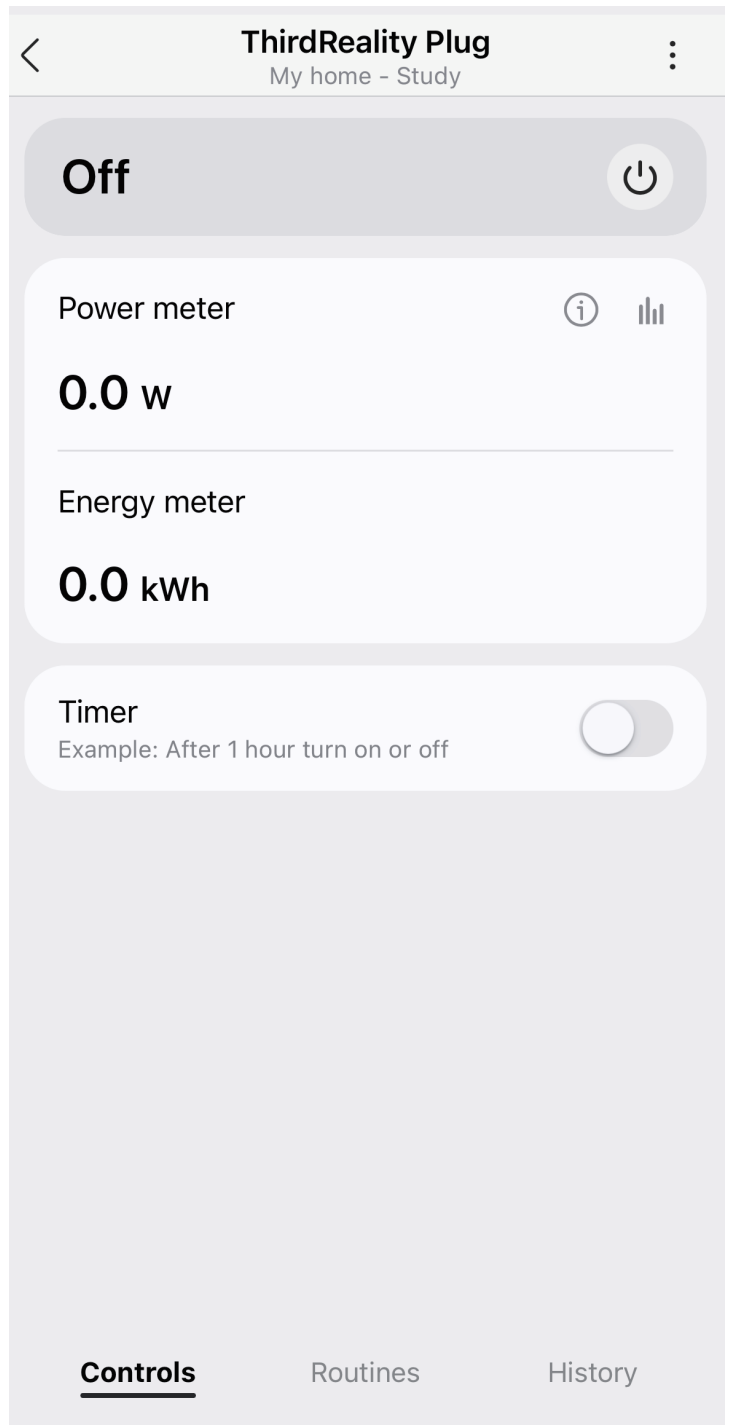
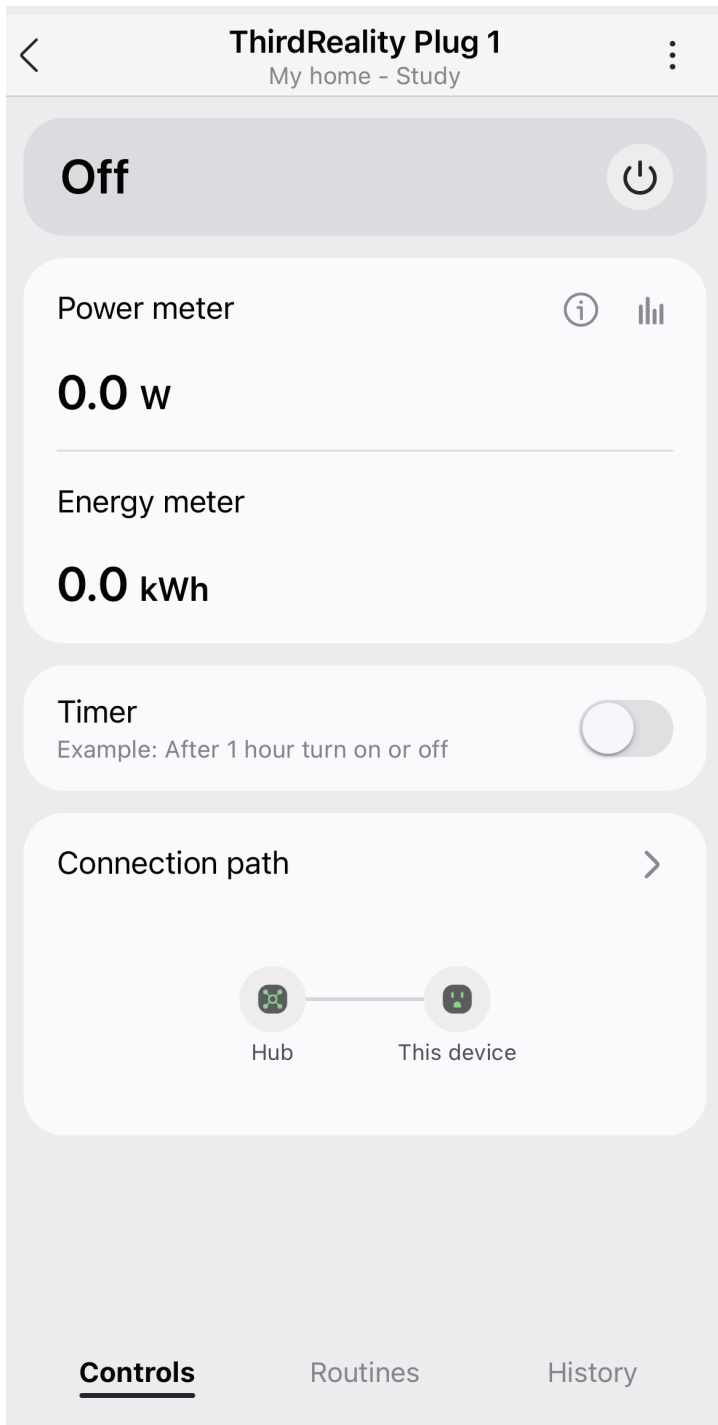

Setup with Third Reality

Zigbee Hub: Smart Hub Gen2 Plus

App: Third Reality App

Functional compatibility notice: ONLY ONE power meter is supported



1. Check your Smart Hub Gen2 Plus's firmware and Third Reality App for updates to ensure you have the latest versions before pairing.
2. Power on the Smart Plug, then press and hold the button for more than 10 seconds until the red LED light turns on. After that, release the button; the LED will flash rapidly in red. It exits pairing mode within 3 minutes if not successfully paired. To put the plug back into pairing mode.
3. Tap "+" in the upright in the Third Reality App, Select the Plug icon, choose the hub you want to pair with, and then tap "Pair" to add a plug. The Smart Dual Plug will be paired within seconds. You can view the power meter and total consumption on the device detail page and customize the "Default Safety Setting" after a power outage.

Setup with 3R-Installer

Device: Smart Bridge MZ1

App: 3R-Installer App

Functional compatibility level: Fully compatible



1. Check your Smart Bridge MZ1's firmware and 3R-Installer App for updates to ensure you have the latest versions before pairing.
2. Power on the Smart Plug, then press and hold the button for more than 10 seconds until the red LED light turns on. After that, release the button; the LED will flash rapidly in red. It exits pairing mode within 3 minutes if not successfully paired. To put the plug back into pairing mode.
3. Launch the 3R-Installer App, go to the bridge's detail page, and tap "+." Select "Add Devices," and then the Smart Dual Plug will be paired within seconds. You can view the power meter and total consumption on the device detail page.

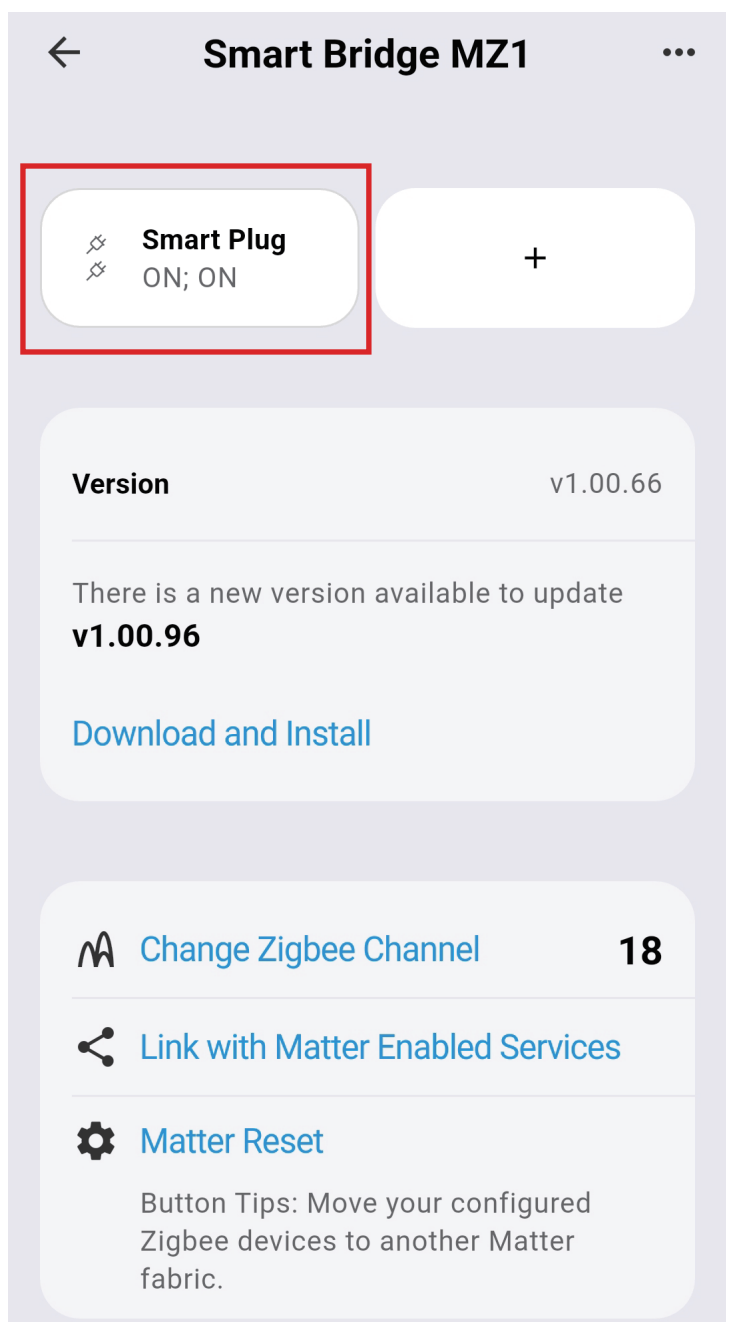
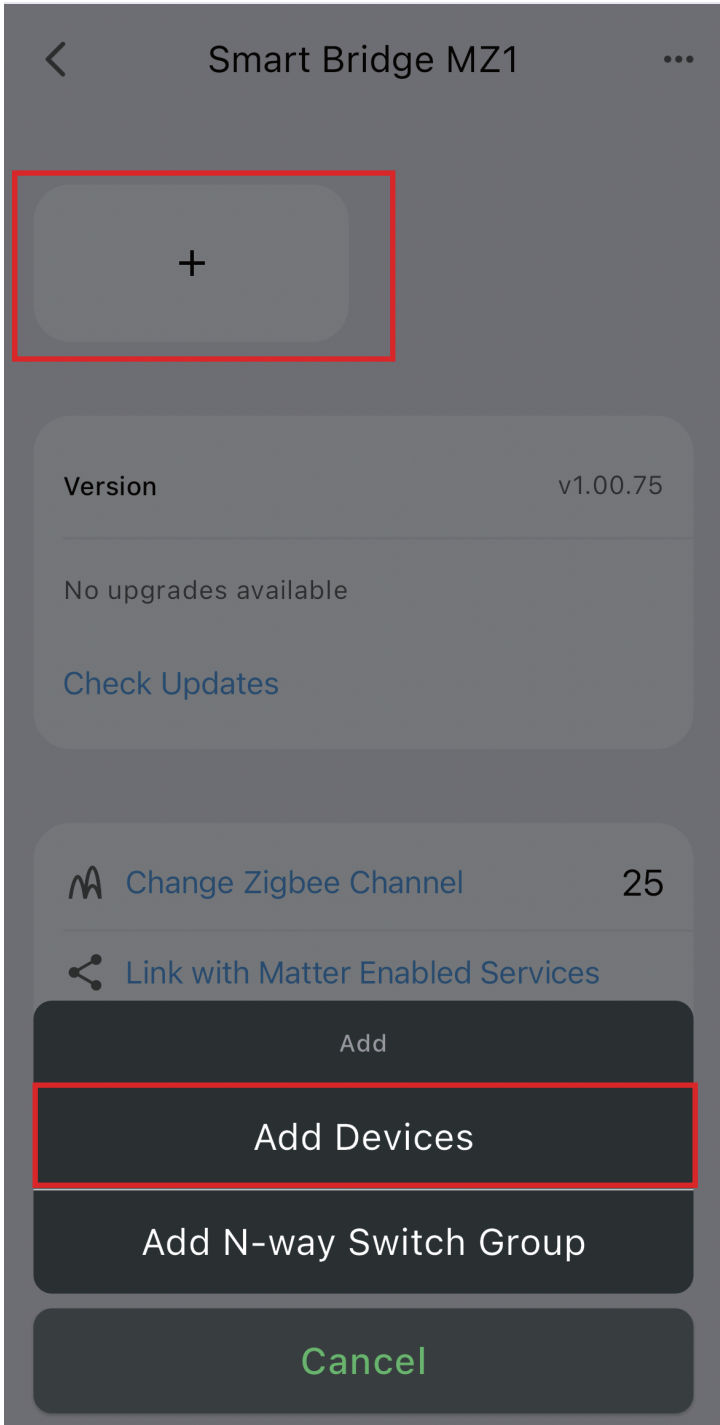
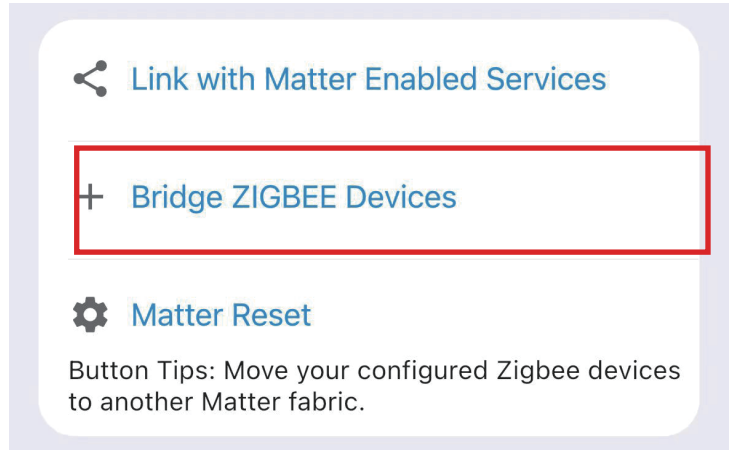
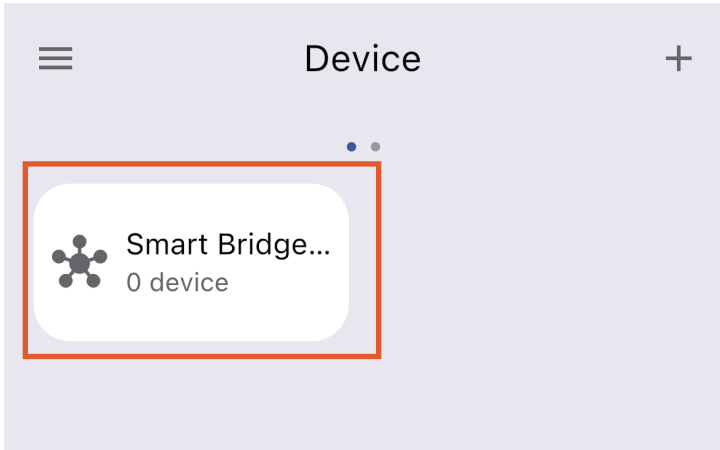

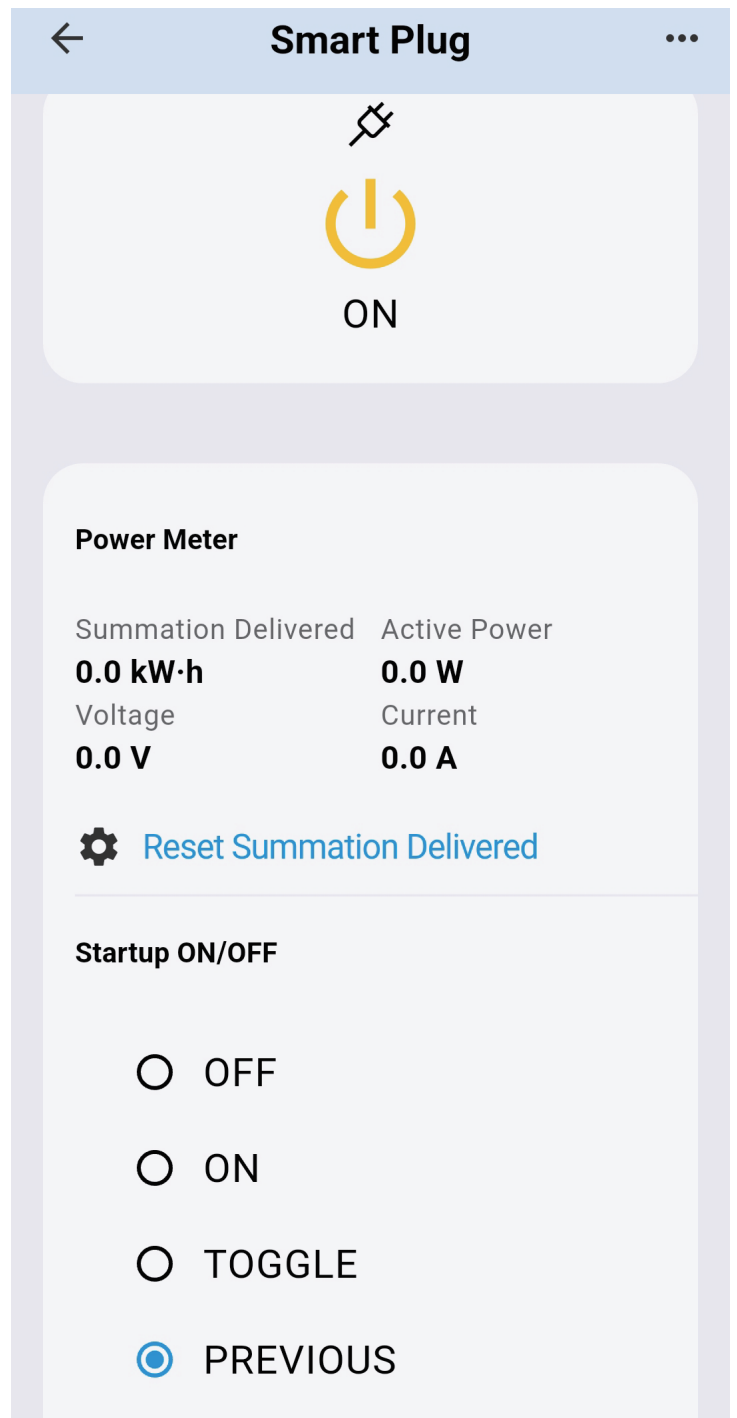
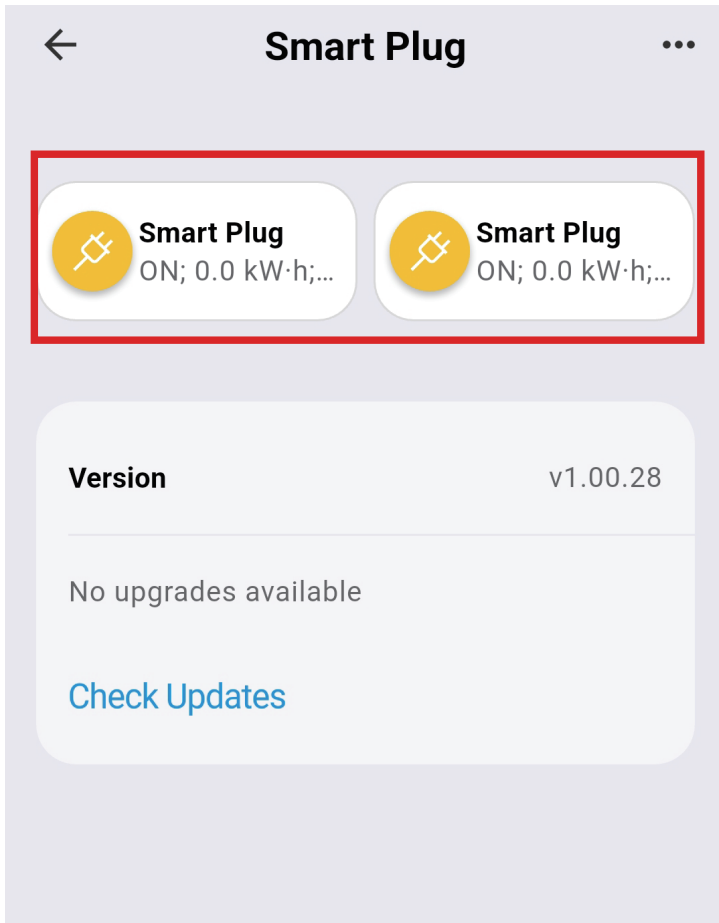

Setup with Home Assistant Via ZHA (Zigbee Home Assistant)

Functional compatibility level: Fully compatible



1. Power on the Smart Plug, then press and hold the button for more than 10 seconds until the red LED light turns on. After that, release the button; the LED will flash rapidly in red. It exits pairing mode within 3 minutes if not successfully paired. To put the plug back into pairing mode.
2. Ensure the Home Assistant integration "Zigbee Home Automation" is set up correctly. Then, navigate to the "Settings" page and click "Devices & Services."
3. Click the "Devices" on the top menu, then click "Add Devices" on the bottom right, and select "Add Zigbee Devices."
4. The Smart Dual Plug will be paired within seconds. You can view the power meter, total consumption, and other information on the device detail page.

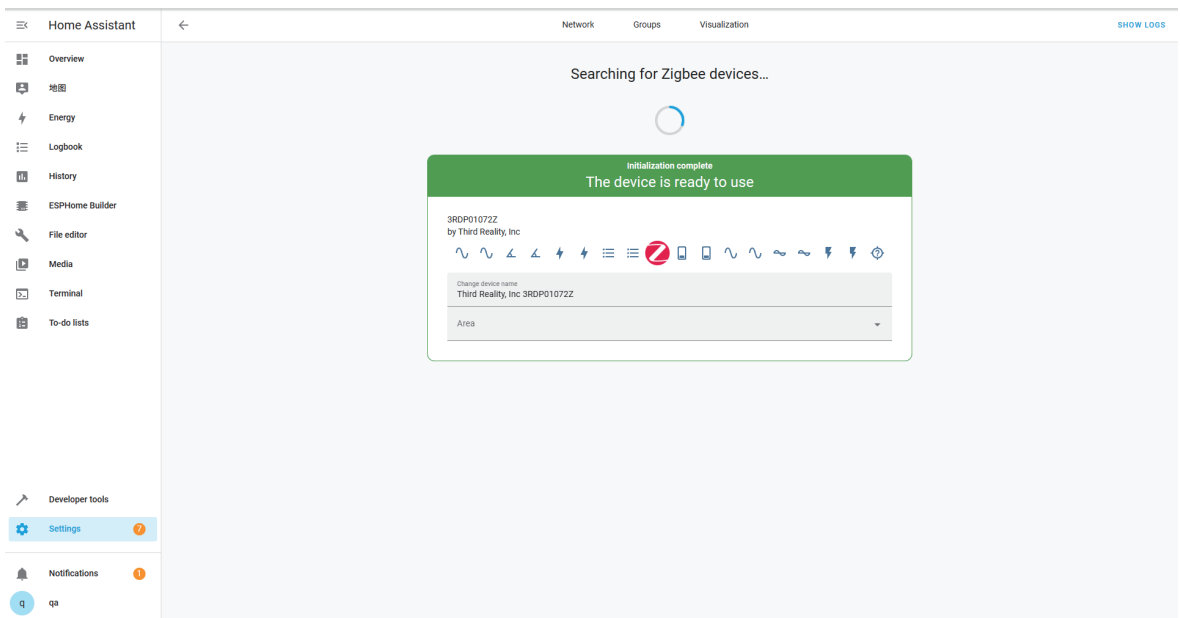
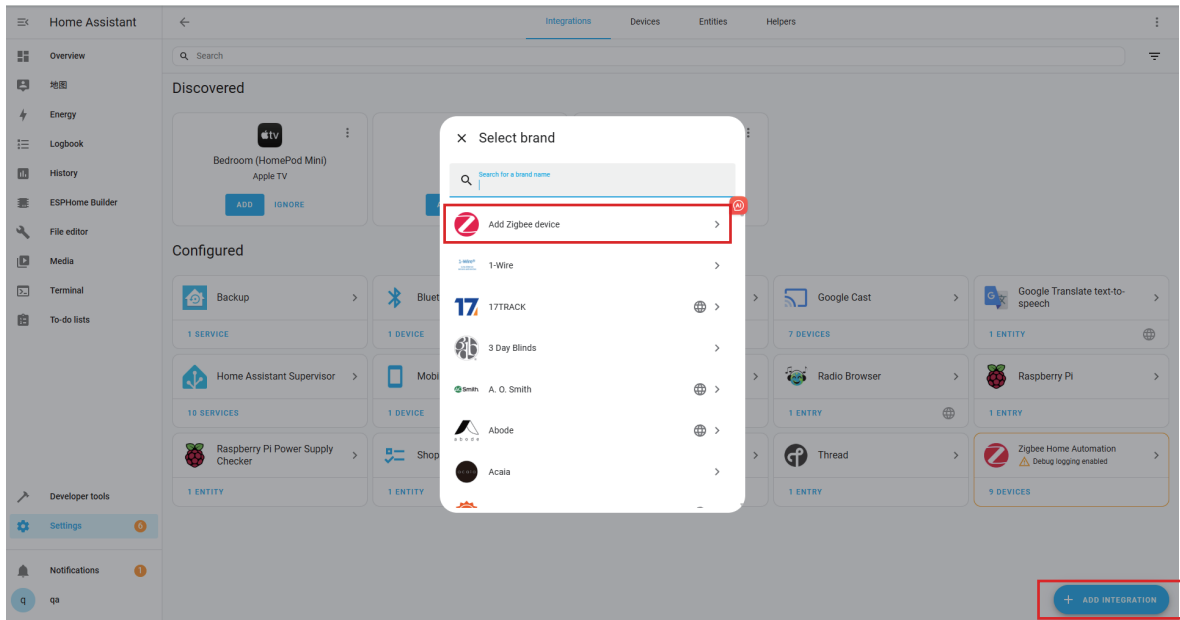
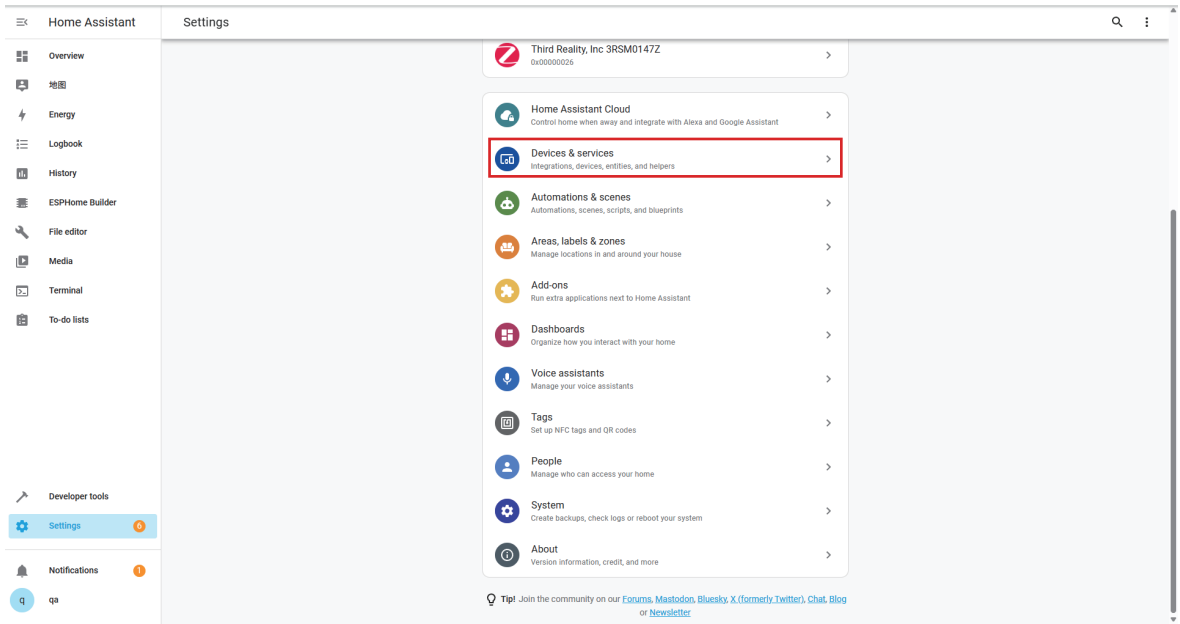

Home Assistant

Integrations **Devices** Entities Helpers

Filters Search 11 devices Group by Sort by Device

Device	Manufacturer	Model	Area	Integration	Battery
2732	Third Reality, Inc	3RSM0147Z	-	Zigbee Home Automation	-
dresden elektronik Conbee II	dresden elektronik	Conbee II	-	Zigbee Home Automation	-
new 3RSB02015Z	Third Reality, Inc	3RSB02015Z	liuj	Zigbee Home Automation	-
Third Reality, Inc 3RDP01072Z	Third Reality, Inc	3RDP01072Z	-	Zigbee Home Automation	-
Third Reality, Inc 3RSB0158Z	Third Reality, Inc	3RSB0158Z	liuj	Zigbee Home Automation	-
Third Reality, Inc 3RSB0158Z old	Third Reality, Inc	3RSB0158Z	liuj	Zigbee Home Automation	-
Third Reality, Inc 3RSM0147Z	Third Reality, Inc	3RSM0147Z	-	Zigbee Home Automation	100%
Third Reality, Inc 3RSM0147Z	Third Reality, Inc	3RSM0147Z	lyr	Zigbee Home Automation	-
Third Reality, Inc 3RSMR01067Z	Third Reality, Inc	3RSMR01067Z	-	Zigbee Home Automation	78%
Third Reality, Inc 3RSPU01080Z	Third Reality, Inc	3RSPU01080Z	zhai	Zigbee Home Automation	-
Third Reality, Inc 3RTHS248Z	Third Reality, Inc	3RTHS248Z	-	Zigbee Home Automation	92%

Developer tools

Settings

Notifications

qa

+ ADD DEVICE

Home Assistant

← Third Reality, Inc 3RDP01072Z

Overview

地图

Energy

Logbook

History

ESPHome Builder

File editor

Media

Terminal

To-do lists

Developer tools

Settings

Notifications

qa

Device info

3RDP01072Z
by Third Reality, Inc
Connected via [dresden elektronik Conbee II](#)

Zigbee info

Zigbee Home Automation

RECONFIGURE

Controls

On/Off

On/Off

ADD TO DASHBOARD

Logbook

June 17, 2025

On/Off turned off triggered by action Switch: Turn off
11:25:10 AM - 10 minutes ago - qa

On/Off turned on triggered by action Switch: Turn on
11:25:09 AM - 10 minutes ago - qa

Sensors

- AC Frequency 50 Hz
- AC Frequency 50 Hz
- Current 0.0 A
- Current 0.0 A
- Power Factor 0%
- Power Factor 0%
- Power Supply 0.0 W
- Power Supply 0.0 W
- Total Delivered 0.0 kWh
- Total Delivered 0.0 kWh
- Voltage 108 V
- Voltage 108 V

Setup with Home Assistant Via Z2M (Zigbee 2MQTT)

Functional compatibility level: Fully compatible



1. Power on the Smart Plug, then press and hold the button for more than 10 seconds until the red LED light turns on. After that, release the button; the LED will flash rapidly in red. It exits pairing mode within 3 minutes if not successfully paired. To put the plug back into pairing mode.
2. Click "Permit Join" in Zigbee2MQTT to add devices.
3. The Smart Dual Plug will be paired within seconds. You can view the power meter, total consumption, and other information on the device detail page.

Home Assistant

Z2M@192.168.3.41 Devices Dashboard Map Groups OTA Touchlink Logs Extensions Permit join (All)

Enter search criteria

#	Pic	Friendly name	IEEE Address	Manufacturer	Model	LQI	Availability	Power	
1		0xffff40e0601de8f	0xffff40e0601de8f (0xc888)	Third Reality	3RSM0147Z	N/A	Offline	?	
2		0x282c02bfffed00eb	0x282c02bfffed00eb (0x2077)	Third Reality	3RMS168Z	N/A	Offline	?	

Overview
地图
Energy
Logbook
History
File editor
HACS
Media
Terminal
Zigbee2MQTT

Developer tools
Settings
Notifications
admin

Home Assistant

Z2M@192.168.3.41 Devices Dashboard Map Groups OTA Touchlink Logs Extensions Disable join (All) 03:41

Enter search criteria

#	Pic	Friendly name	IEEE Address	Manufacturer	Model	LQI	Availability	Power	
1		0xffff40e0601de8f	0xffff40e0601de8f (0xc888)	Third Reality	3RSM0147Z	208	Offline		
2		0x282c02bfffed00eb	0x282c02bfffed00eb (0x2077)	Third Reality	3RMS168Z	240	Online		
3		0x00003b20df74e14c	0x00003b20df74e14c (0x34A4)	Third Reality	3RDP01072Z	216	Online		

Overview
地图
Energy
Logbook
History
File editor
HACS
Media
Terminal
Zigbee2MQTT

Developer tools
Settings
Notifications
admin

z2m: Configuring '0x00003b20df74e14c'

z2m: Device '0x00003b20df74e14c' is supported, identified as: Third Reality Smart Dual Plug ZP1 (3RDP01072Z)

z2m: Successfully interviewed '0x00003b20df74e14c', device has successfully been paired.

zhccontroller: Successfully interviewed '0x00003b20df74e14c'

Home Assistant Z2M@192.168.3.41 Devices Dashboard Map Groups OTA Touchlink Logs Extensions Disable join (All) 03:20

0x00003b20df74e14c

About Exposes Bind Reporting Settings Settings (specific) State Clusters Scene Dev console



Friendly name	0x00003b20df74e14c
Description	
Last seen	N/A
Availability	Online
Device type	Router
Zigbee Model	3RDP01072Z
Zigbee Manufacturer	Third Reality, Inc
Description	Smart Dual Plug ZP1
Support status	Supported
IEEE Address	0x00003b20df74e14c
Network address	0x34AA /1,13476
Firmware build date	20250506-3R
Firmware version	v1.00.15
Manufacturer	Third Reality
Model	3RDP01072Z
Power	
Interview state	Successful

Developer tools Settings Notifications admin

Home Assistant Z2M@192.168.3.41 Devices Dashboard Map Groups OTA Touchlink Logs Extensions Disable join (All) 03:04

Linkquality 216 (signal strength)

State OFF ON

Power-on behavior Controls the behavior when the device is powered on after power loss

Power Instantaneous measured power 0 W

Voltage Measured electrical potential value 108.3 V

AC frequency Measured electrical AC frequency 50 Hz

Power factor Instantaneous measured power factor 0

Current Instantaneous measured electrical current 0 A

Energy Sum of consumed energy 0 kWh

State On/off state of the switch OFF ON

Power-on behavior Controls the behavior when the device is powered on after power loss

Power Instantaneous measured power 0 W

Voltage Measured electrical potential value 108.3 V

Developer tools Settings Notifications admin

Troubleshooting

1. **Factory reset the Smart Dual Plug**

Power on the Smart Plug, then press and hold the button for more than 10 seconds until the red LED light turns on. After that, release the button; the LED will flash rapidly in red.

2. **What happens to the Smart Dual Plug after a factory reset? Will both sockets be affected?**

Yes. Performing a factory reset will reset both plugs at the same time. All settings will be restored to default, and any accumulated power consumption data will be cleared for both sockets. This operation cannot be undone.

ISED Caution

This device complies with Innovation, Science and Economic Development Canada (ISED) licence-exempt RSS standard(s). Operation is subject to the following two conditions: (1) This device may not cause harmful interference, and (2) this device must accept any interference received, including interference that may cause undesired operation.

Cet appareil est conforme à la ou aux normes RSS exemptées de licence pour Innovation, Science et développement économique Canada. Le fonctionnement est soumis aux deux conditions suivantes: (1) ce dispositif ne peut pas causer d'interférence nocive, et (2) ce dispositif doit accepter toute interférence reçue, y compris les interférences pouvant causer un fonctionnement indésirable.

This equipment complies with ISED radiation exposure limits set forth for an uncontrolled environment. This equipment should be installed and operated with minimum distance 20cm between the radiator and your body. This transmitter must not be co-located or operating in conjunction with any other antenna or transmitter.

Cet équipement respecte les limites d'exposition aux rayonnements ionisants fixées pour un environnement non contrôlé. Cet équipement doit être installé et utilisé avec une distance minimale de 20cm entre le radiateur et votre corps. Cet émetteur ne doit pas être localisé ou fonctionner en conjonction avec une autre antenne ou un autre émetteur.

FCC Regulatory Conformance

This device complies with Part 15 of the FCC Rules. Operation is subject to the following two conditions:

- (1) This device may not cause harmful interference.
- (2) This device must accept any interference received, including interference that may cause undesired operation.

NOTE: This equipment has been tested and found to comply with the limits for a Class B digital device, pursuant to part 15 of the FCC Rules. These limits are designed to provide reasonable protection against harmful interference in a residential installation.

NOTE: This equipment generates uses and can radiate radio frequency energy and, if not installed and used in accordance with the instructions, may cause harmful interference to radio communications. However, there is no guarantee that interference will not occur in a particular installation. If this equipment does cause harmful interference to radio or television reception, which can be determined by turning the equipment off and on, the user is encouraged to try to correct the interference by one or more of the following measures:

- Reorient or relocate the receiving antenna.
- Increase the separation between the equipment and receiver.
- Connect the equipment into an outlet on a circuit different from that to which the receiver is connected.
- Consult the dealer or an experienced radio/TV technician for help.

NOTE: The manufacturer is not responsible for any radio or TV interference caused by unauthorized modifications to this equipment. Such modifications could void the user's authority to operate the equipment.

RF Exposure

This equipment complies with FCC radiation exposure limits set forth for an uncontrolled environment.

This transmitter must not be co-located or operating in conjunction with any other antenna or transmitter.

Limited Warranty

For limited warranty, please visit

<https://3reality.com/faq-help-center/>

For customer support, please contact us at info@3reality.com or visit www.3reality.com

For question on other platforms, visit for corresponding platform's application/support platforms.