

Smart Plug M3



Contents

Product Description	01
Features	01
Specifications	02
Factory Reset	03
Set Up with 3R-Installer App	03
Set Up with Apple Home	05
Set Up with Google Home	07
Set Up with Alexa	09
Set Up with SmartThings	12
FCC Regulatory Conformance.....	15
RF Exposure	15
Limited Warranty	16

Product Description

This Smart Plug M3 is the easiest way for you to start controlling lights, fans, humidifiers, and other home appliances. Enjoy hands-free convenience by adding voice control to any outlet. Use the Matter protocol to adapt to multiple smart home ecosystems.

Features

1. Compatible with Matter support ecosystems like Apple Home, Amazon Alexa, Google Home, and SmartThings.
2. Home automation for customizable schedules & routines.
3. Customize On/Off state when power is restored.

Specifications

Smart Plug M3:

Model Number	3RSP03071W
Dimension	2.7 x 1.5 x 1.13 inches
Color	White
Electrical Characteristics	100~120V AC,15A max,50/60Hz
Temperature	-10°C~40°C
Operating Humidity	5%~90% RH(Non-condensing)
Connectivity	Matter

Mode	LED indicator
Pairing	Red Flash
Pairing Completed	Off
Power ON	Solid Red
Power OFF	Off

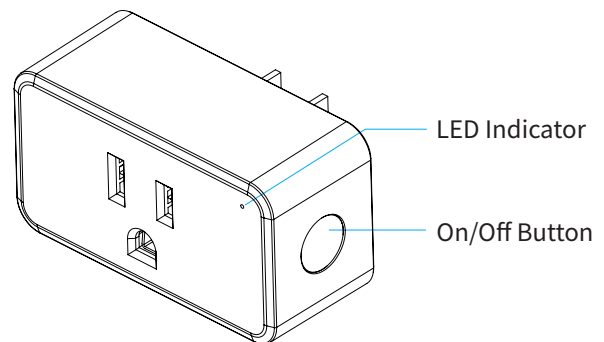

Factory Reset

Long press the button until the LED light flashes red rapidly.

Setup with 3R-Installer App

This Matter certified device can be paired to any Matter certified ecosystems.



1. Make sure it has a stable internet access through a 2.4GHz Wi-Fi network.
2. Log into 3R-Installer App, make sure the app version is up to date.
3. Insert the smart plug into an power outlet, the LED light flashes red rapidly, indicates it is in pairing mode.
4. Tap **+** in 3R-Installer App, Scan Matter QR code on your Smart Plug, or set up without QR-code.
5. Follow the instructions in the app to complete setup.
6. Long press the plug icon to enter the device page, you can check the power consumption, and customize “Startup ON/OFF” state.
7. Tap [Check Updates](#) to update the firmware to the latest version.
8. Tap [Link with Matter Enabled Services](#), copy the numeric code. Launch the app of another MATTER certified ecosystem, follow the setup instruction to enter the setup code and follow the app instructions to complete the setup.

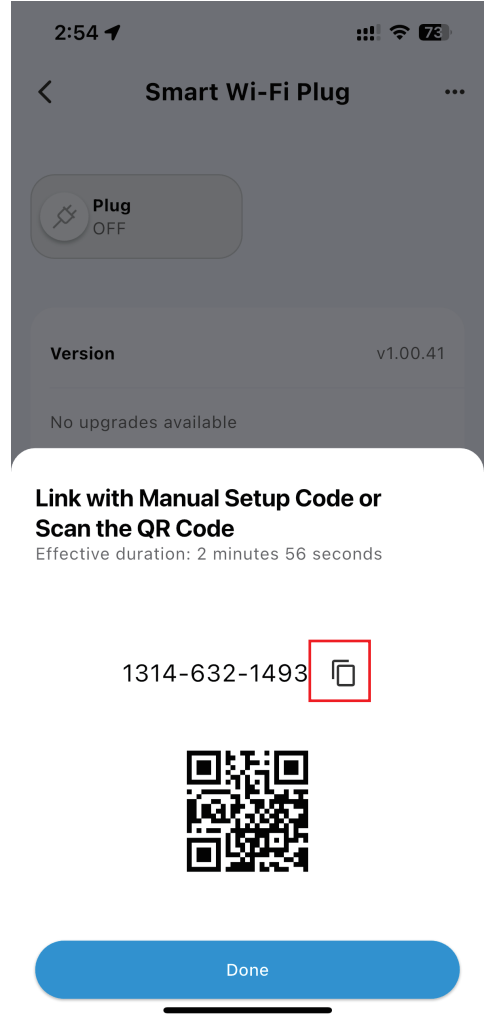
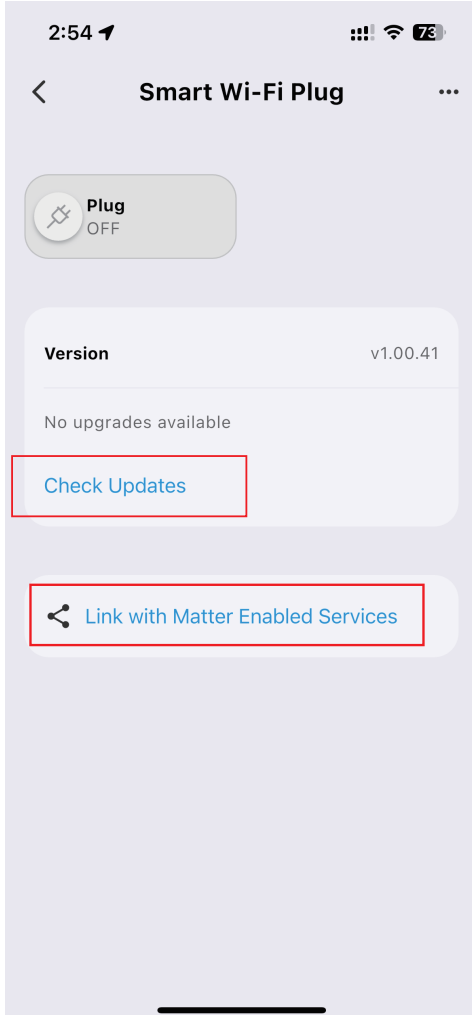
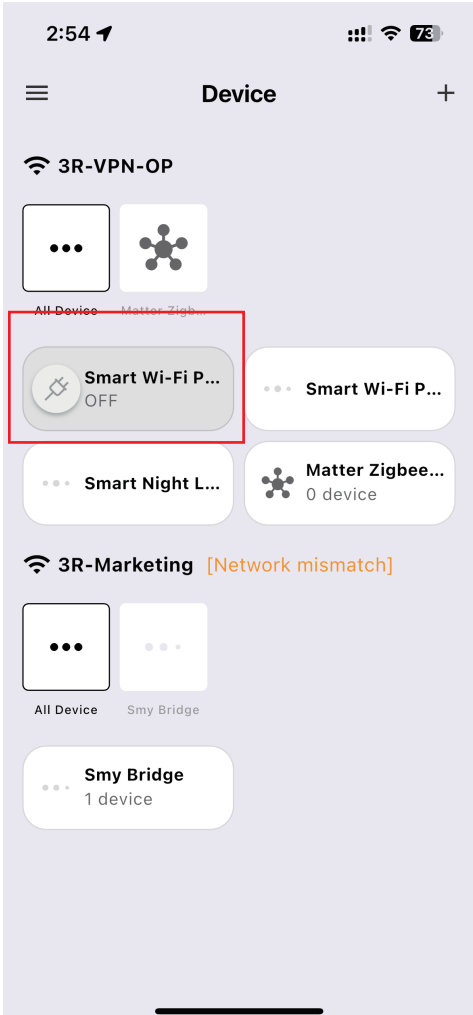
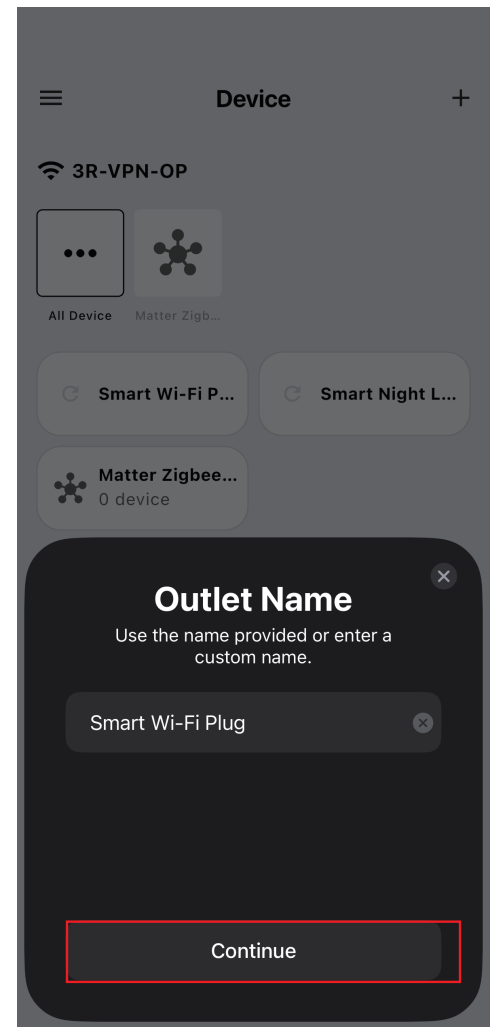
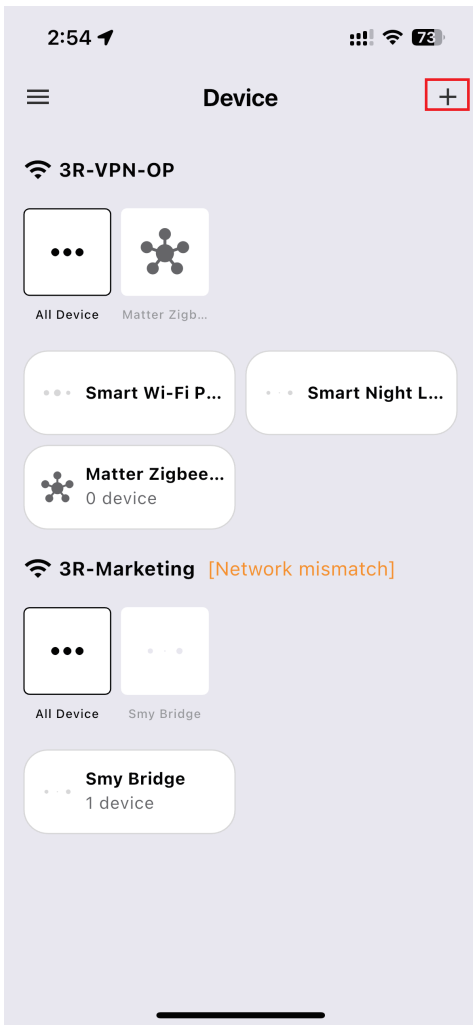

Set Up with Apple Home



Compatibility:

iOS system: Version 16.6 or later.

Matter-supported Controller: Home Pod, Home Pod mini, or Apple TV.

1. Launch your Home App. connect your Apple speaker and your phone to the same Wi-Fi LAN network.
2. Power up the Matter device, the LED light flashes rapidly in red. If it is not in pairing mode, to put it into pairing mode again, press the button for 5 seconds.
3. Scan the Matter QR code on your device. Tap **+** and then tap **Add or Scan Accessory** to add a new device.
4. Choose a location and set a name for your device.
5. Now you can check your device on the Device list, turn it on/off or add automation.
6. To connect the device to another MATTER certified ecosystem app, you need to go to the app of the first ecosystem to generate a new setup code. Long press the Device Icon to open the Accessory Settings page, scroll down, tap **Turn On Pairing Mode** and then **Copy Code**. Launch the app of another MATTER certified ecosystem, follow the setup instruction to enter the setup code and follow the app instructions to complete the setup.

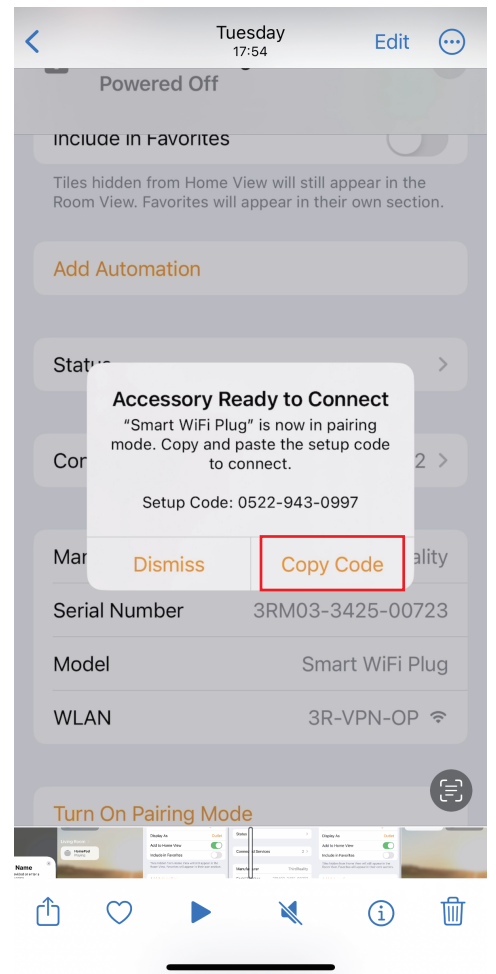
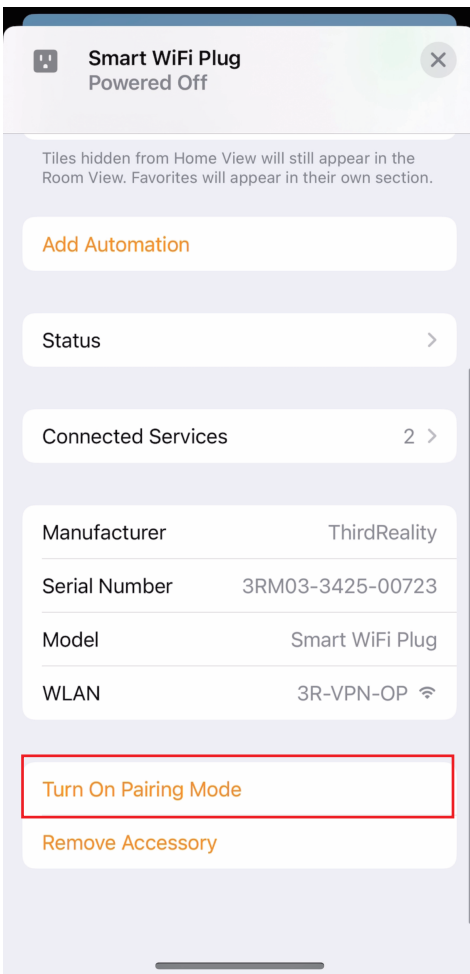
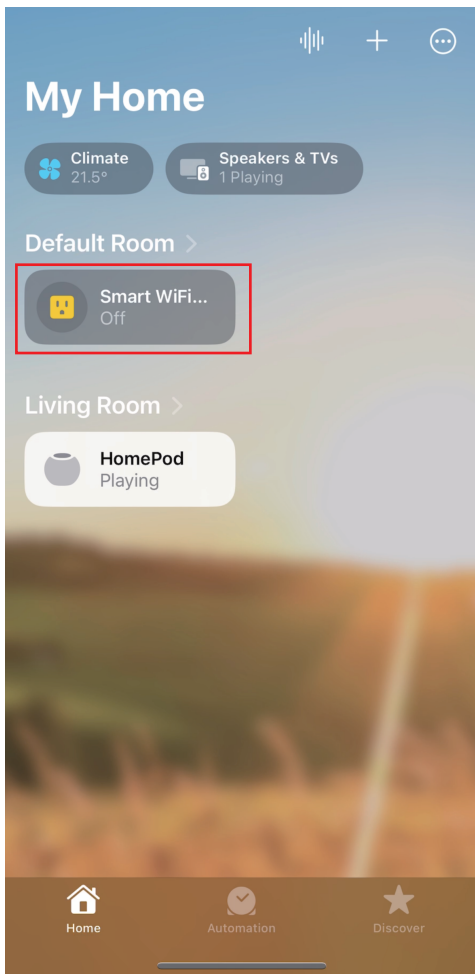
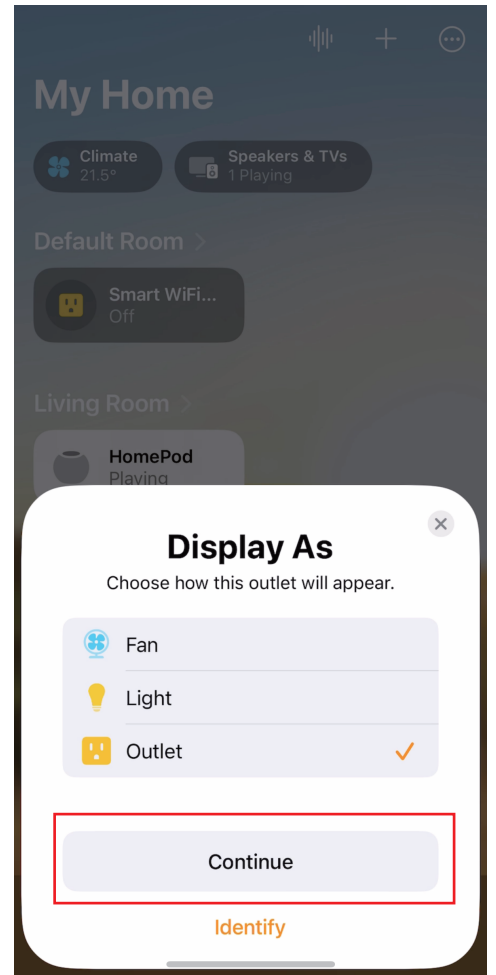
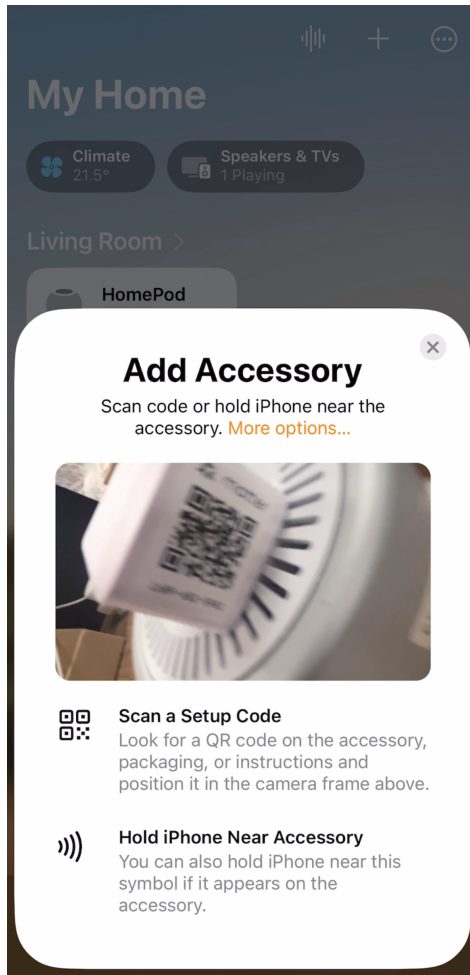
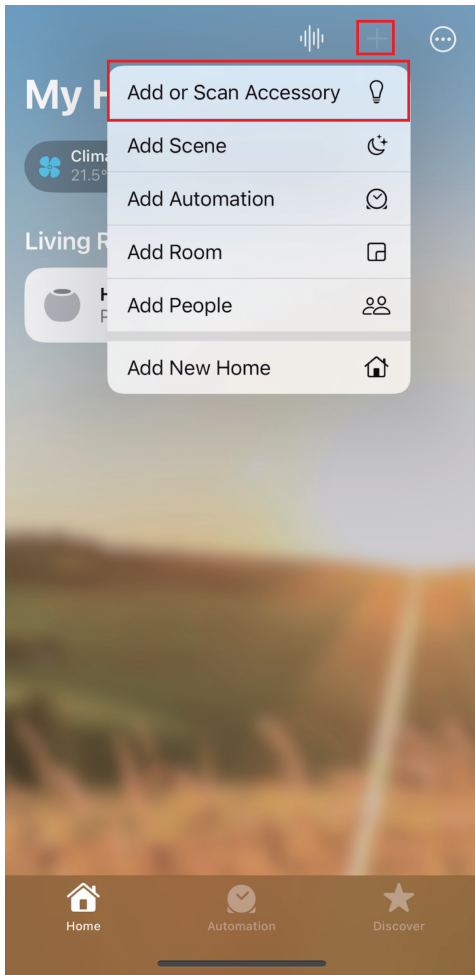

Set Up with Google Home



Compatibility

Google Home App version:

Android: 3.3.1.4 or later

IOS: 3.3.104 or later

1. Set up your Google Home Speaker in your Google Home app, connect your Google Home speaker and your phone to the same Wi-Fi LAN network.
2. Power up the Matter device, the LED light flashes rapidly in red. If it is not in pairing mode, press the button for 5 seconds to put it into pairing mode again.
3. A notification “Set up your device” pops up in your Google Home app, tap [Scan QR code](#) and follow the instructions to add the Matter device.
4. You can create automations with the Matter device.
5. To connect the Matter device to another Matter ecosystem app, open the app of the first ecosystem the Matter device has already been paired with, open the device page and tap the setting icon on the up right, then tap [Linked Matter apps & services](#) , tap [Link apps & services](#) and follow the app instructions to complete the setup.

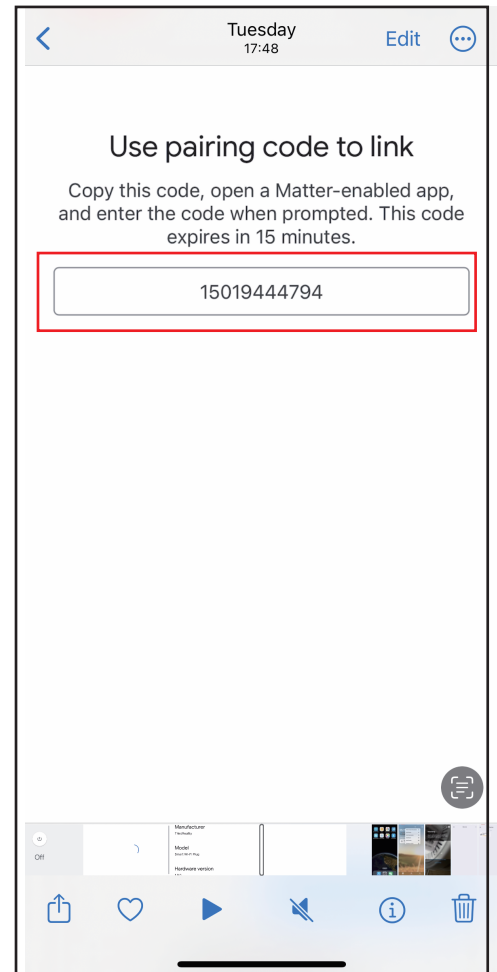
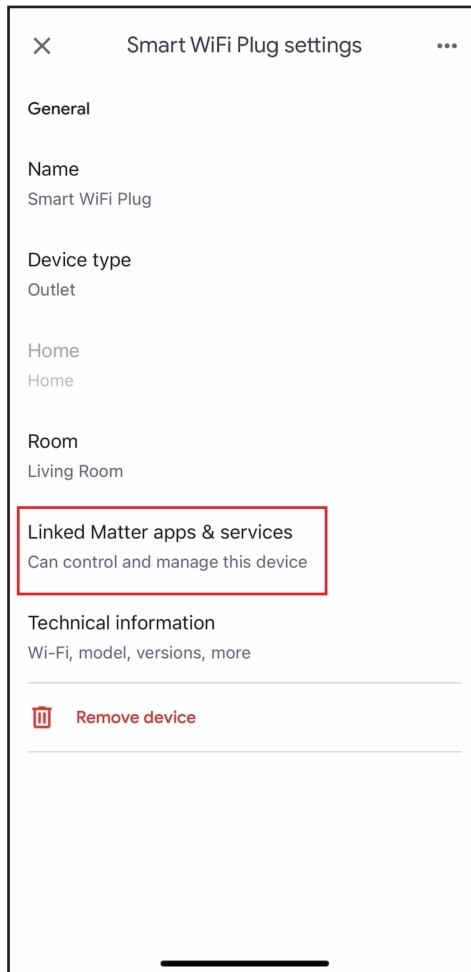
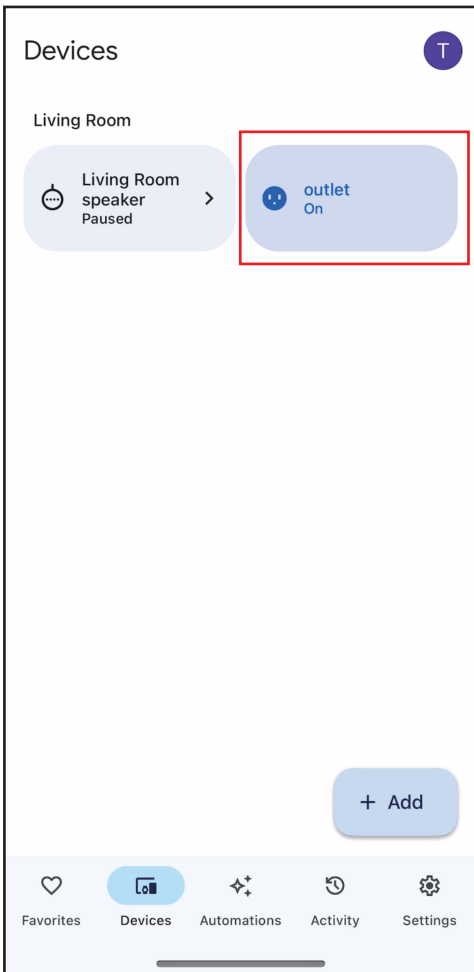
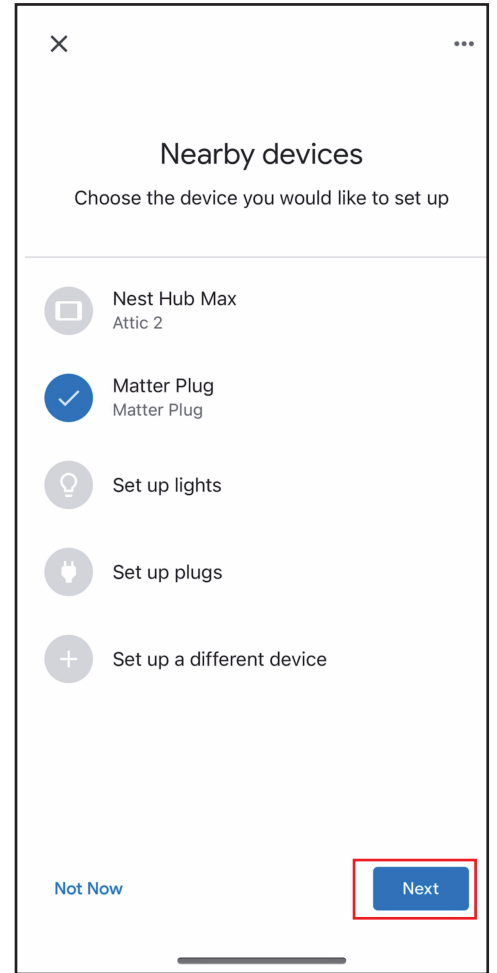
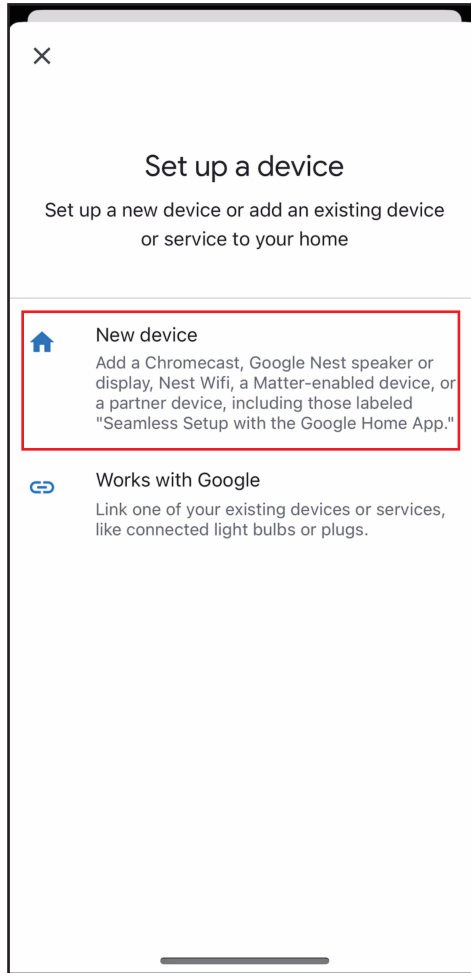
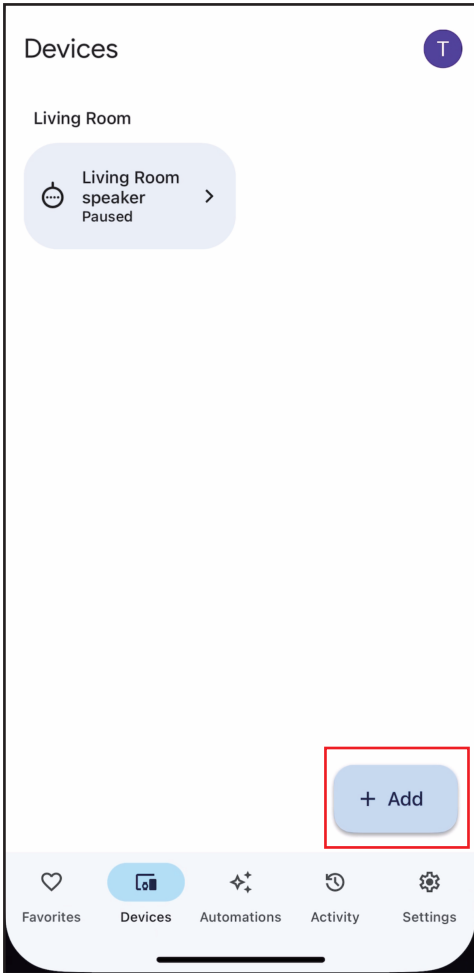

Set Up with Alexa



Alexa app version:

Android: 2.2.521848.0 or later for build version, and 2023.15 or later for APP version

IOS: 2.2.548660 or later for build version, and 2023.15 or later for APP version

1. Set up your Amazon Alexa Speaker, connect your phone to your Wi-Fi router.
2. Power up the Matter device, the LED light flashes rapidly in red. If it is not in pairing mode, press the button for 5 seconds to put it into pairing mode again.
3. Tap **+** in the upper right on the device page in your Alexa App, tap **Device** the scroll down to tap **Other**, tap the matter icon and follow the instructions to add the Matter device. Make sure the Matter device and the Echo Speaker are connected to the same W-iFi router.
4. You can create routines with the Matter device.
5. To connect the Matter device to other Matter ecosystem's Assistant or Apps, open the app of the first ecosystem the Matter device has already been paired with, open the device page and tap the **setting** icon on the up right, then tap **Other assistants and apps** to add other Assistant or App, it generates a new setup code, you can copy this code, then open the other Matter ecosystem App, then use this code to add the device to the second Matter ecosystem.

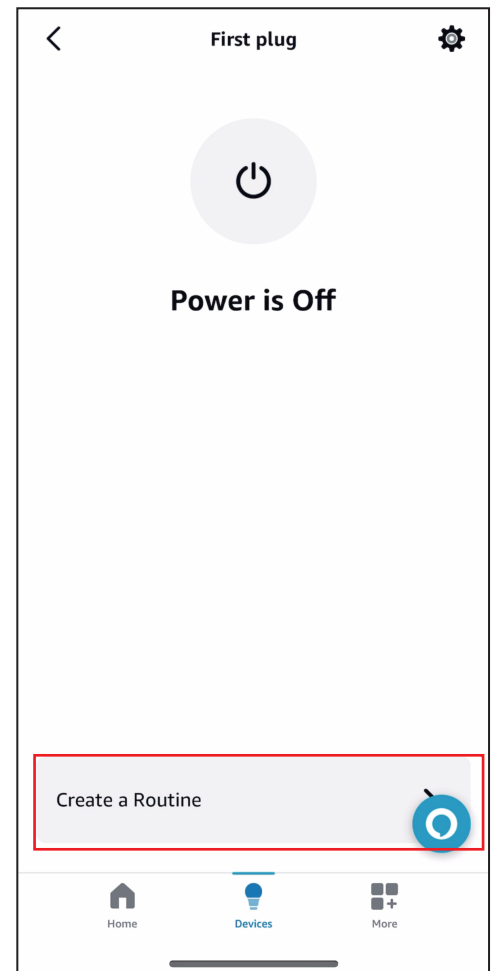
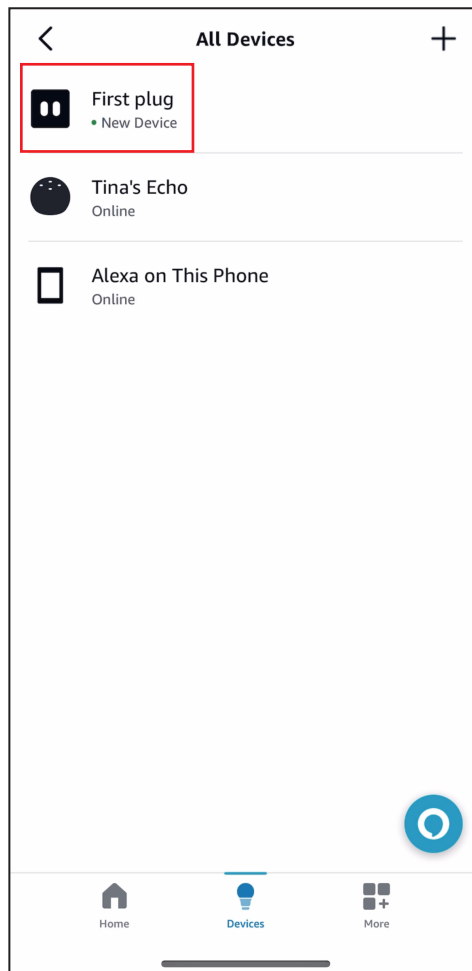
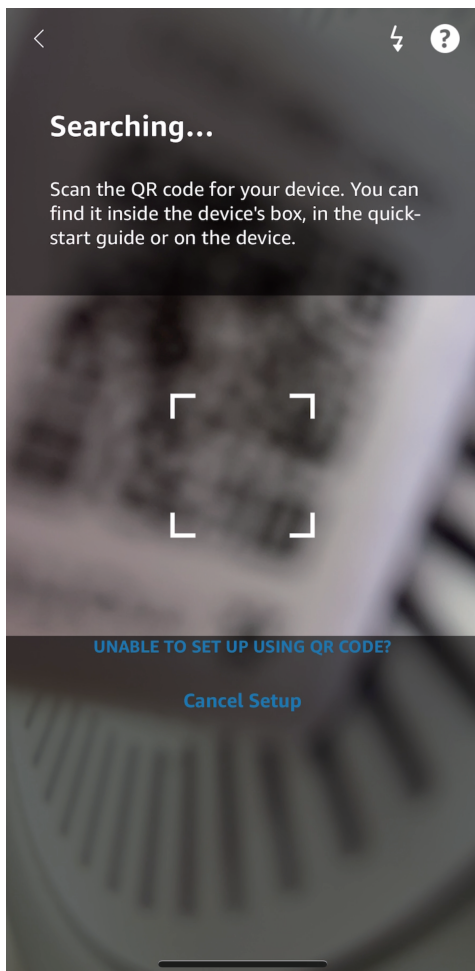
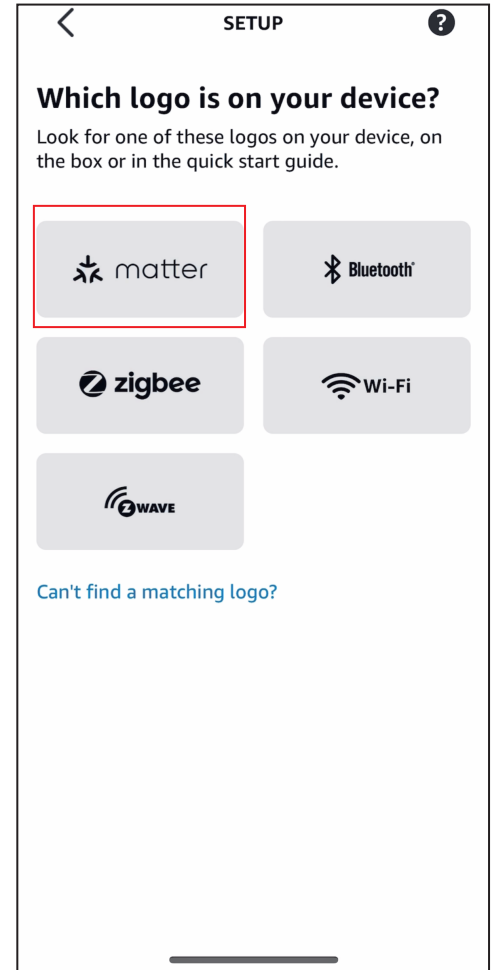
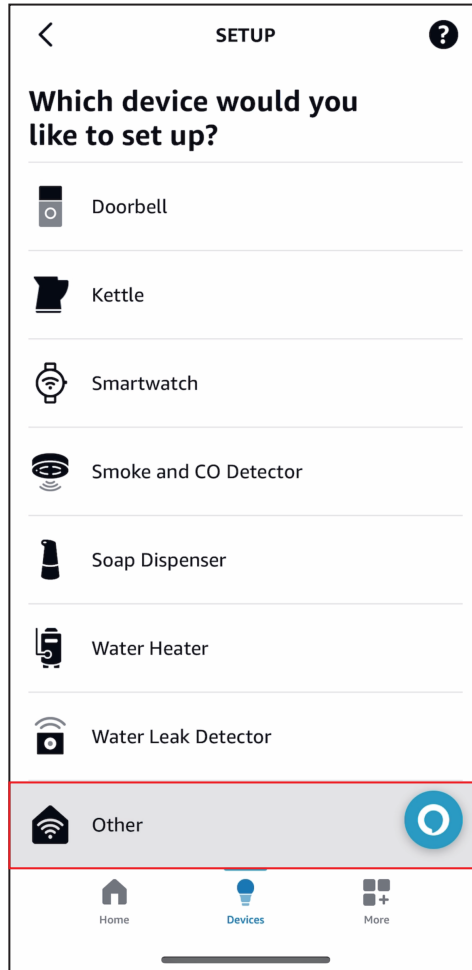
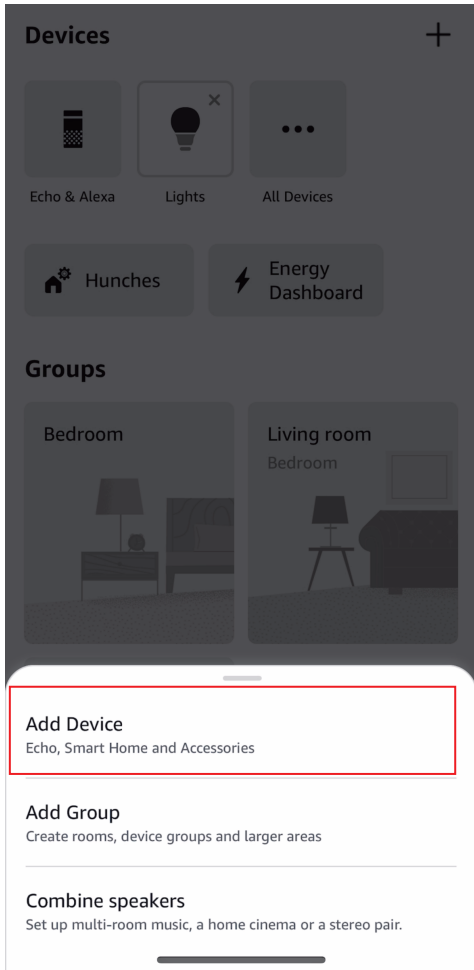

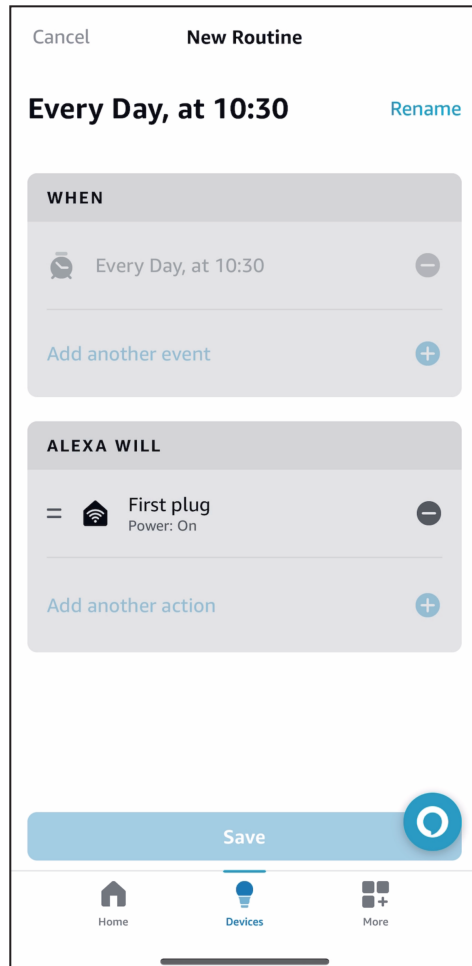
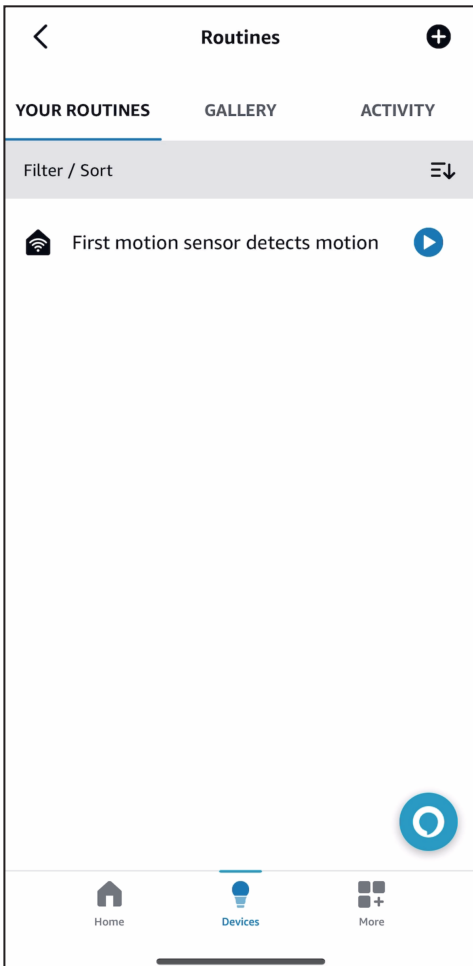
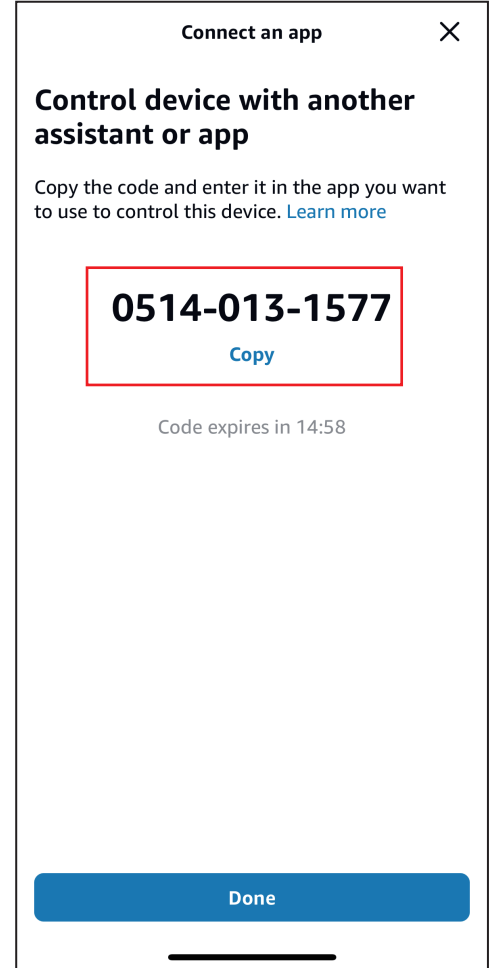
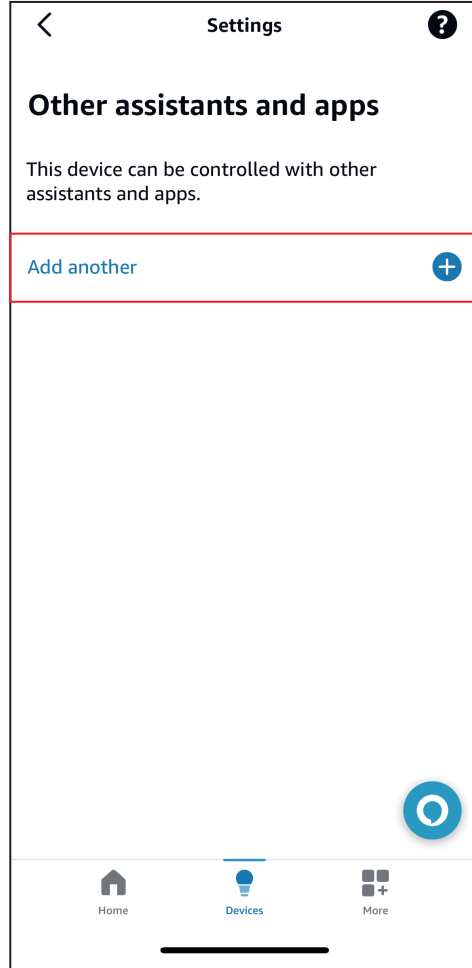
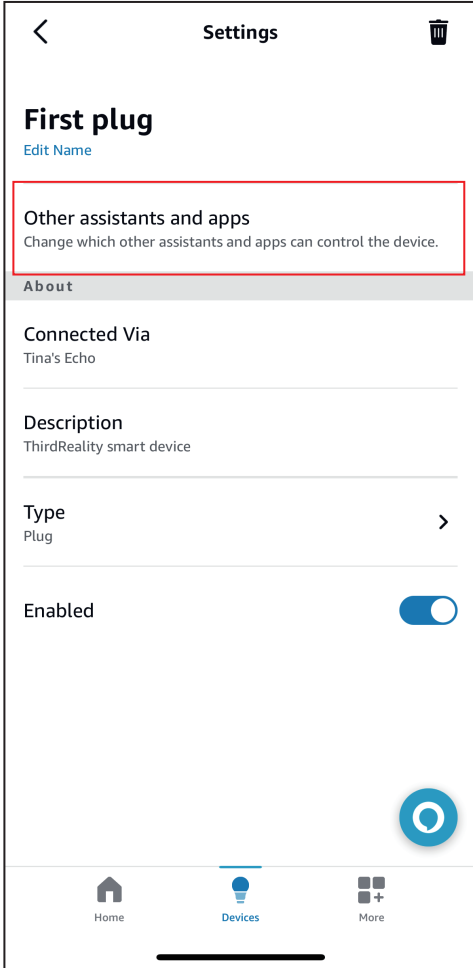

Set Up with SmartThings

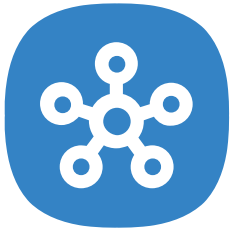

Compatibility:

SmartThings App version 1.8.01.22 or higher.

iOS SmartThings App version 1.7.02.16

Matter-supported Controller: SmartThings Hub (2018), Aeotec Smart Home Hub, SmartThings Station.

1. Launch your SmartThings App. Tap **+** to Add device., Choose Matter.
2. Scan QR code on your device.
3. Select a hub to connect your device.(You need to Add to “iCloud Account” in IOS, then create Accessory Name, then Continue)
4. Now you can check your device on the Device list, turn on/off and create routines.
5. To connect the device to another Matter certified ecosystem app, go to the app of the first ecosystem to generate a new setup code. Go to the Device Settings page, tap [Share with other services](#) then [Share device](#), there will be QR code and a numeric code. Launch the app of another MATTER certified ecosystem, follow the setup instruction to enter the setup code and follow the app instructions to complete the setup.

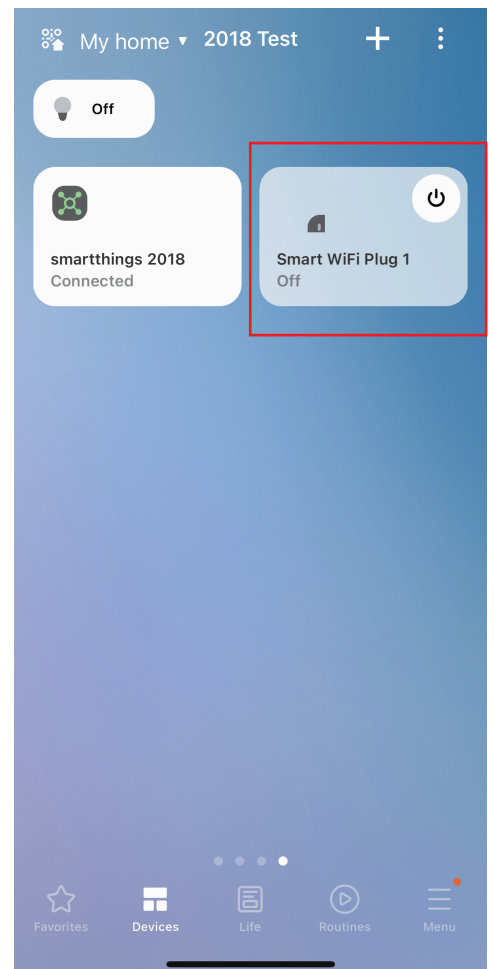
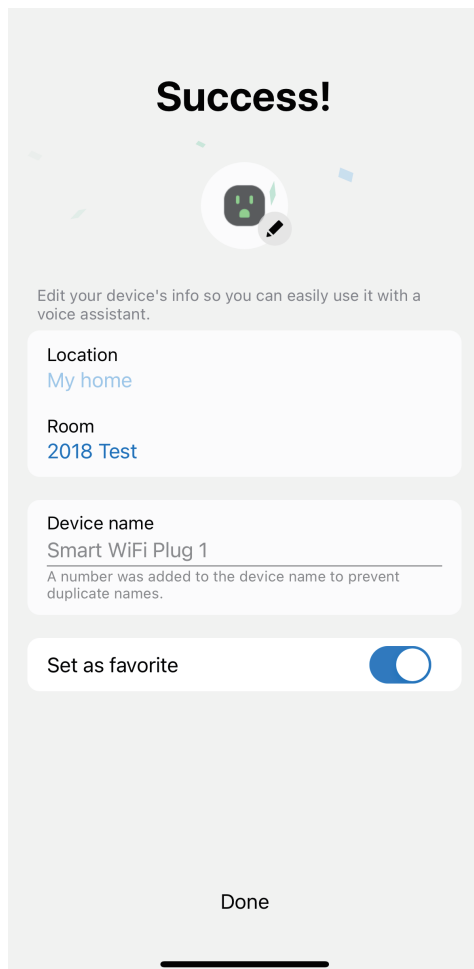
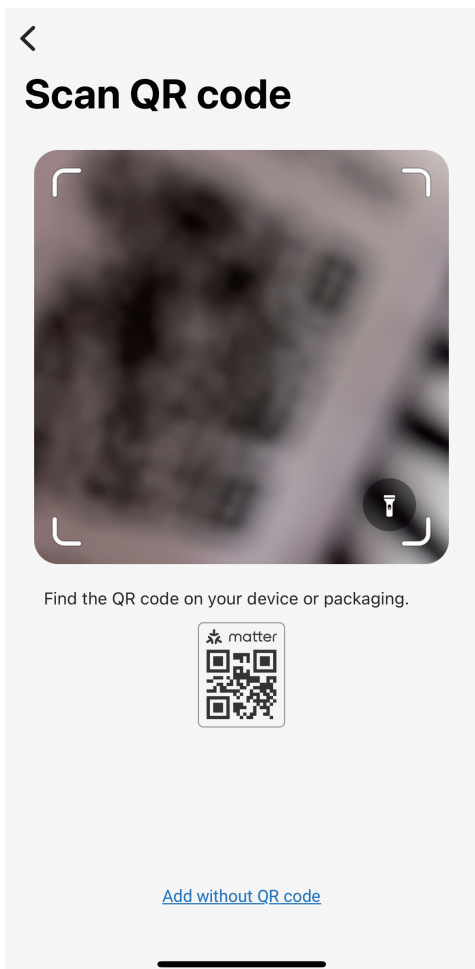
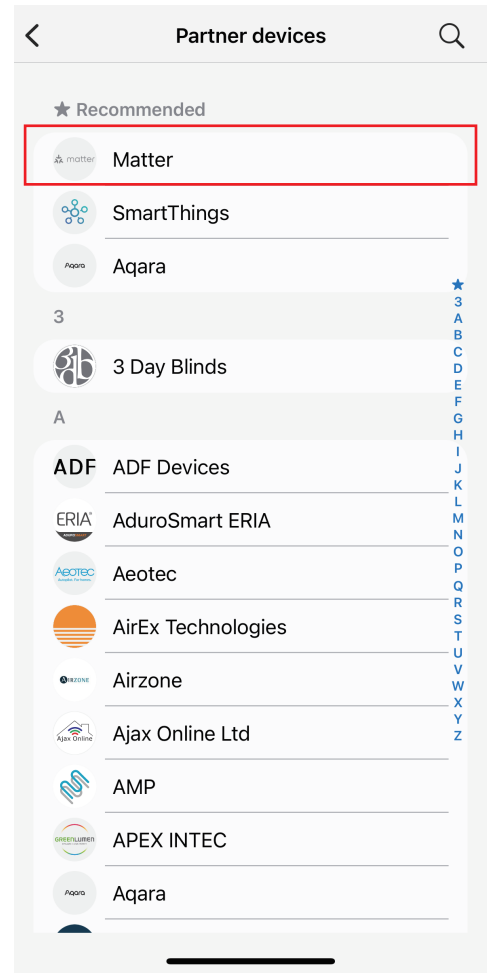
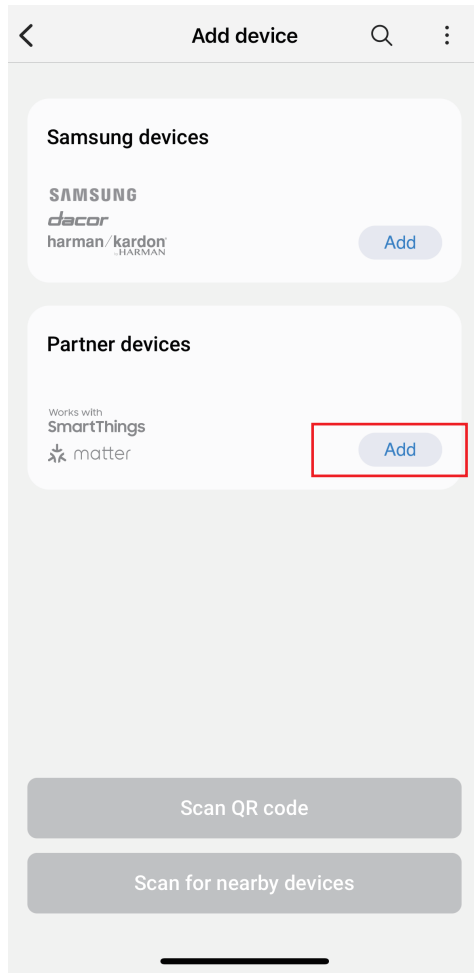
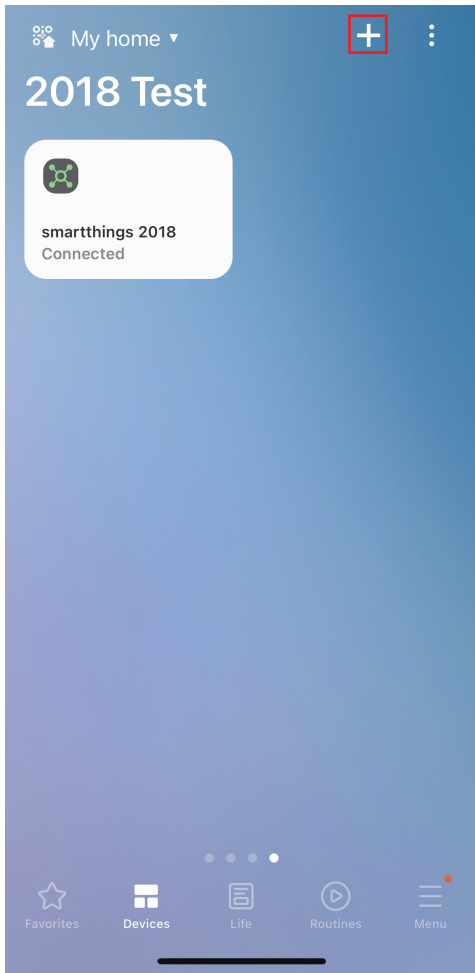

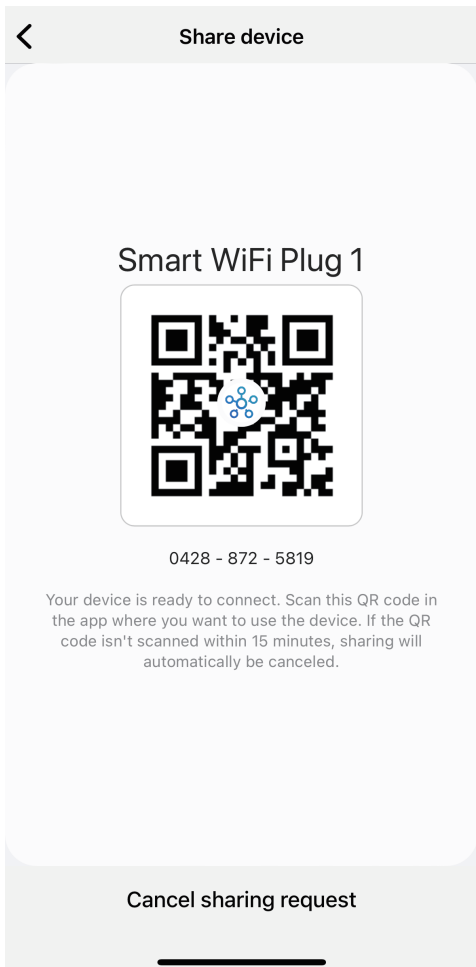
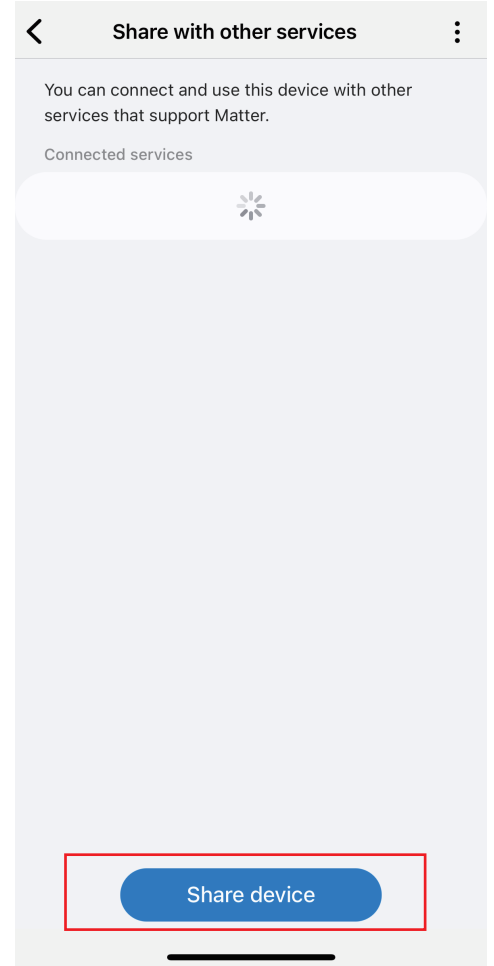
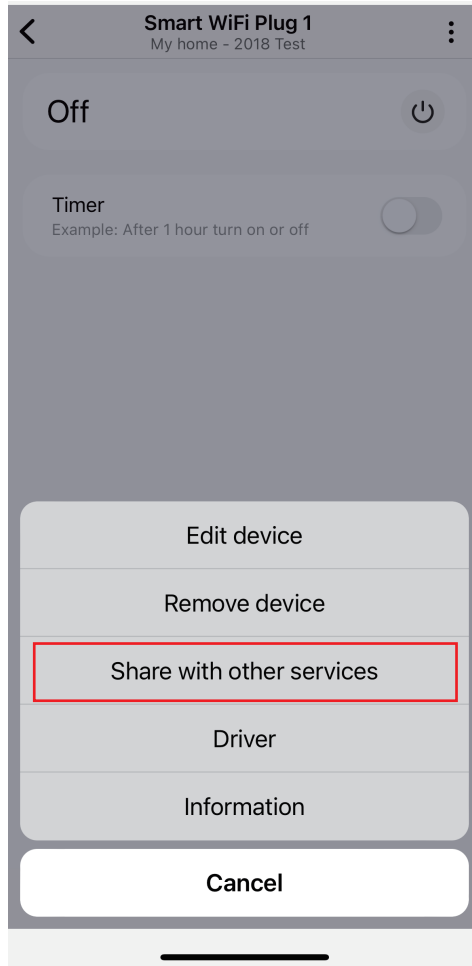
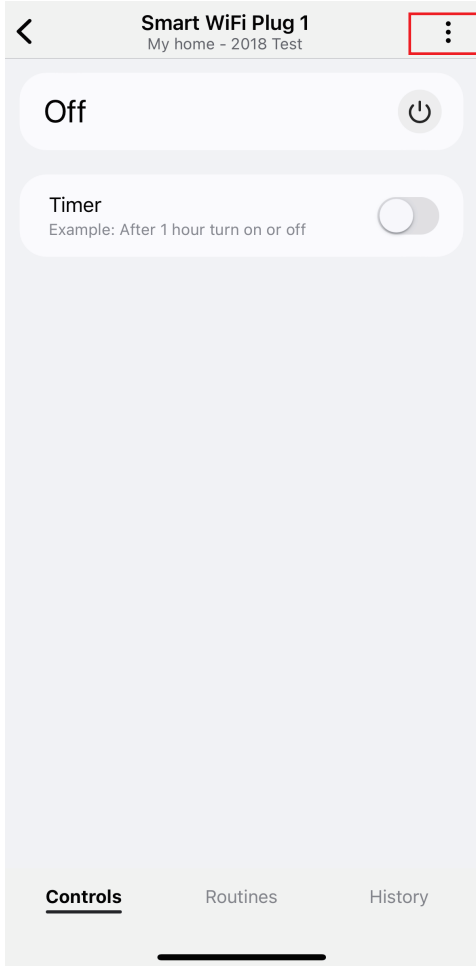

FCC Regulatory Conformance

This device complies with part 15 of the FCC rules. Operation is subject to the following two conditions: (1) this device may not cause harmful interference, and (2) this device must accept any interference received, including interference that may cause undesired operation.

Changes or modifications not expressly approved by the party responsible for compliance could void the user's authority to operate the equipment.

NOTE: This equipment has been tested and found to comply with the limits for a Class B digital device, pursuant to part 15 of the FCC Rules. These limits are designed to provide reasonable protection against harmful interference in a residential installation.

This equipment generates uses and can radiate radio frequency energy and, if not installed and used in accordance with the instructions, may cause harmful interference to radio communications. However, there is no guarantee that interference will not occur in a particular installation. If this equipment does cause harmful interference to radio or television reception, which can be determined by turning the equipment off and on, the user is encouraged to try to correct the interference by one or more of the following measures:

- Reorient or relocate the receiving antenna.
- Increase the separation between the equipment and receiver.
- Connect the equipment into an outlet on a circuit different from that to which the receiver is connected.
- Consult the dealer or an experienced radio/TV technician for help important announcement.

NOTE: The manufacturer is not responsible for any radio or TV interference caused by unauthorized modifications to this equipment. Such modifications could void the user's authority to operate the equipment.

RF Exposure

This equipment complies with FCC radiation exposure limits set forth for an uncontrolled environment.

This transmitter must not be co-located or operating in conjunction with any other antenna or transmitter.

Limited Warranty

For limited warranty, please visit

<https://thirdreality.com/faq-help-center/>

For customer support, please contact us at info@3reality.com or visit www.thirdreality.com

For question on other platforms, visit for corresponding platform's application/support platforms.