

# Smart Plug UZ1

## User Manual

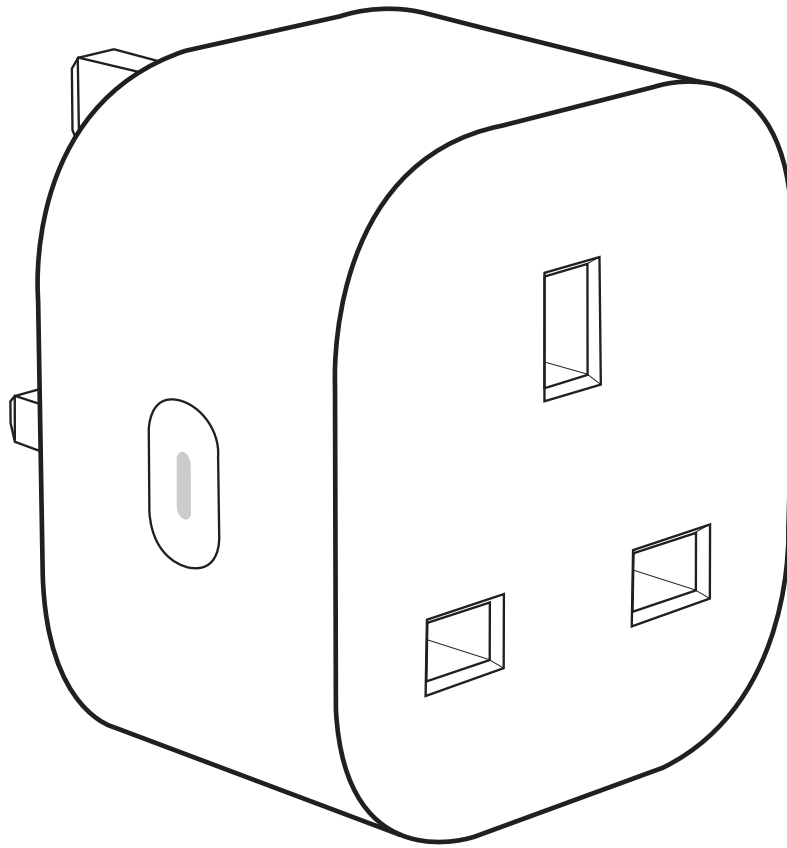

# Contents

Specifications .....	01
Features .....	01
Setting up your Smart Plug UZ1 .....	02
Factory Reset .....	02
Pairing with compatible Echo Speakers or other Zigbee devices .....	03
Pairing with SmartThings .....	04
Pairing with Amazon Alexa .....	06
Pairing with Hubitat .....	09
Pairing with Home Assistant .....	12
Mesh Network Setup .....	18
Using your smart Plug UZ1 .....	19
Troubleshooting .....	20
Limited Warranty .....	22

# Specifications

Model Number	3RSPU01080Z
Input Voltage	AC 100-240V~13A 50/60HZ
Working Temperature	-5°C~40°C(24-hour average temperature ≤35°C)
Operating Humidity	5%~85% RH(Non-condensing)
Connectivity	Zigbee 3.0
The Power Supply Size	L: 50 * W: 55.3 * H: 55.5 mm
Transmission Frequency/Antenna Gain	2405-2480MHz/+0.72dBi
Type of antenna	PCB Antenna
RF output Power	14dbm Max
Maximum power	2990W

## Features

1. Support real-time energy monitoring.
2. Compatible with Zigbee devices from Amazon Echo, SmartThings, Home Assistant, Hubitat, Third Reality, and more.
3. Acts as a Zigbee repeater to extend your Zigbee mesh network's range.
4. Customizable On/Off state when power is restored.

# Setting up your Smart Plug UZ1

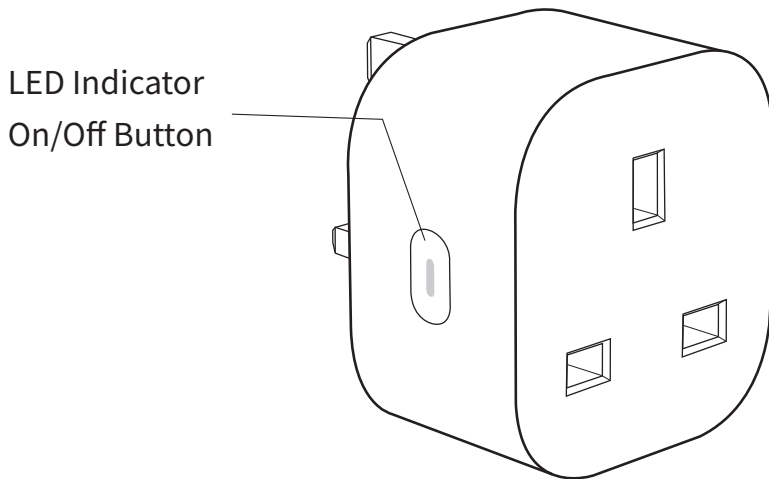

## LED Status

- Pairing: LED light flashes in red.
- Pairing Completed: LED light is out.
- Power ON: LED light is ON in red.
- Power OFF: LED light is OFF.

## Factory Reset

After your Smart Plug is powered on, press and hold the On/Off button for more than 10 seconds until the LED light flashes indicating that your Smart Plug is in pairing mode.

## Pairing with compatible Echo Speakers or other Zigbee devices

Compatible devices: Echo 4th Gen, Echo Plus 1st Gen/2nd-Gen, Echo Show 10 2nd Gen, Echo Show 10 3rd Gen, Echo-Studio, Eero 6, Eero 6 Pro. SmartThings Hub 2015/2018, Aeotec Smart Home Hub, SmartThings Station. Hubitat Elevation, Home Assistant (ZHA/Zigbee2MQTT), Third Reality Hub.

1. Update your hub firmware and phone app to the latest version before pairing, set up your Zigbee Hub by following its user manual.
2. Insert the Smart Plug into an outlet, it will enter pairing mode automatically.
3. Follow the instructions in the corresponding phone app to complete the setup. For compatible Echo Devices, you can also say "Alexa, discover devices" , then Echo will find it automatically.

# Pairing with SmartThings

Compatible Devices: SmartThings Hub 2015&2018, Aeotec Smart Home Hub, SmartThings Station.

App: SmartThings App



## Pairing steps:

1. Check your SmartThings Hub for firmware updates before pairing the Smart Plug with it.
2. Plug the Smart Plug into a socket near the hub, the LED indicator flashes rapidly in red, indicating it is in pairing mode. It exits pairing mode within 3 minutes if not successfully paired. To put it into pairing mode again, press the button for 10 seconds until the LED indicator flashes rapidly in red.
3. Tap "+" in the upper right in your SmartThings app, then tap "Scan for nearby devices", the Smart Plug will be paired within seconds.
4. You can turn on/off the plug, or you can create routine to control it.

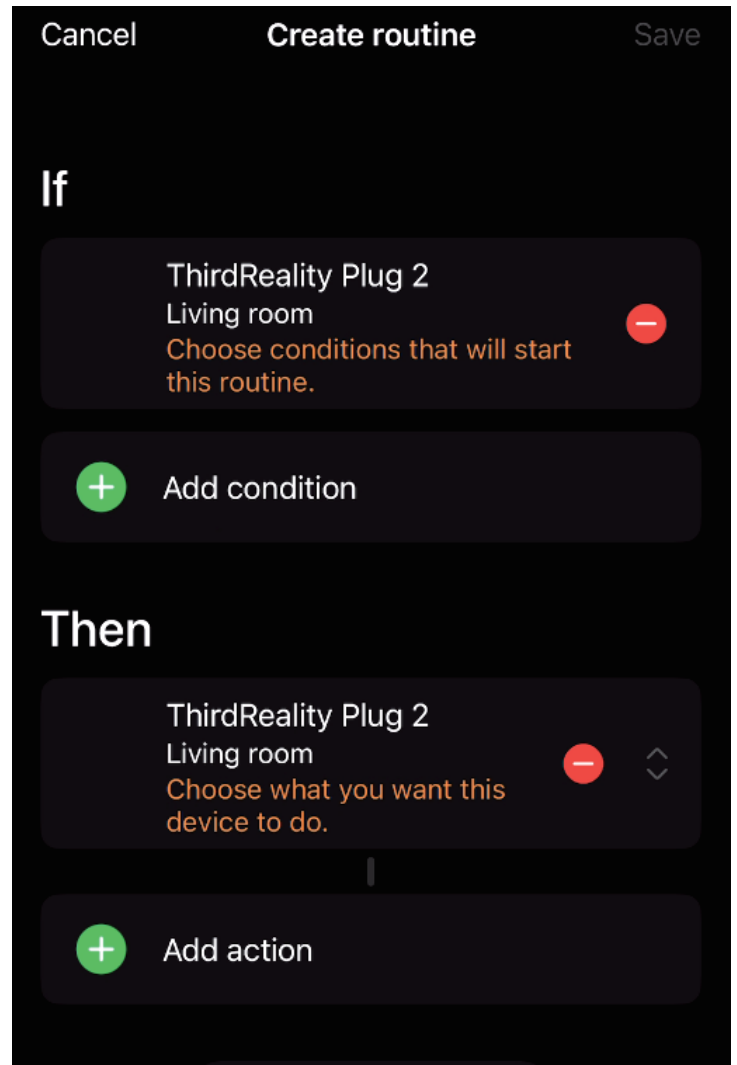
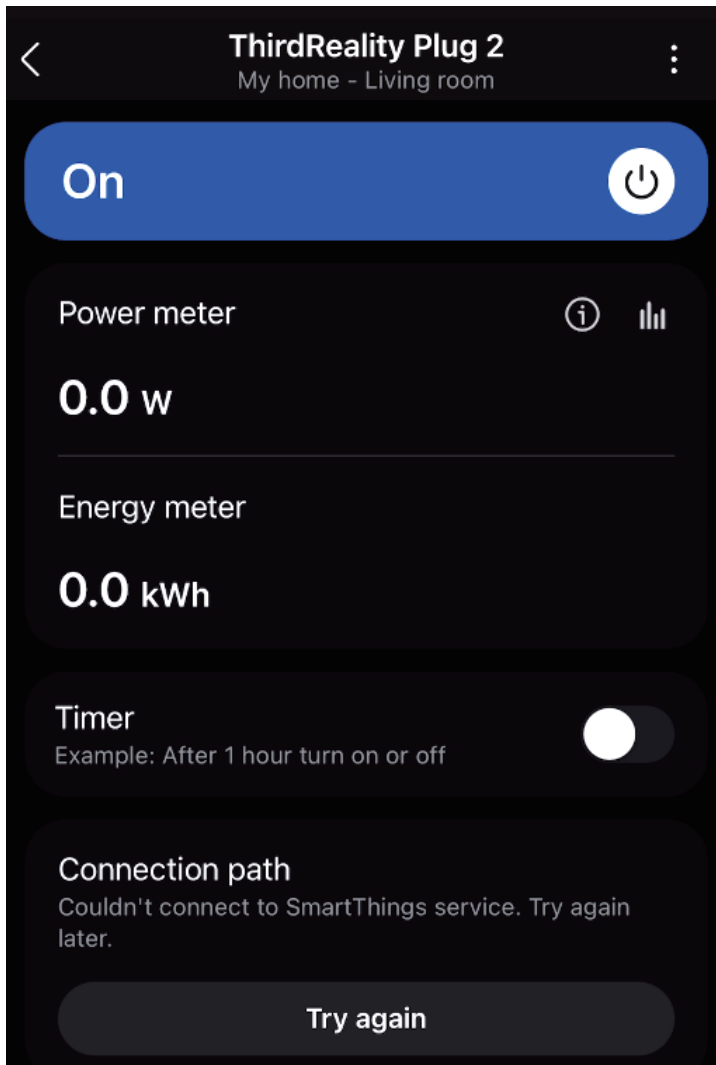
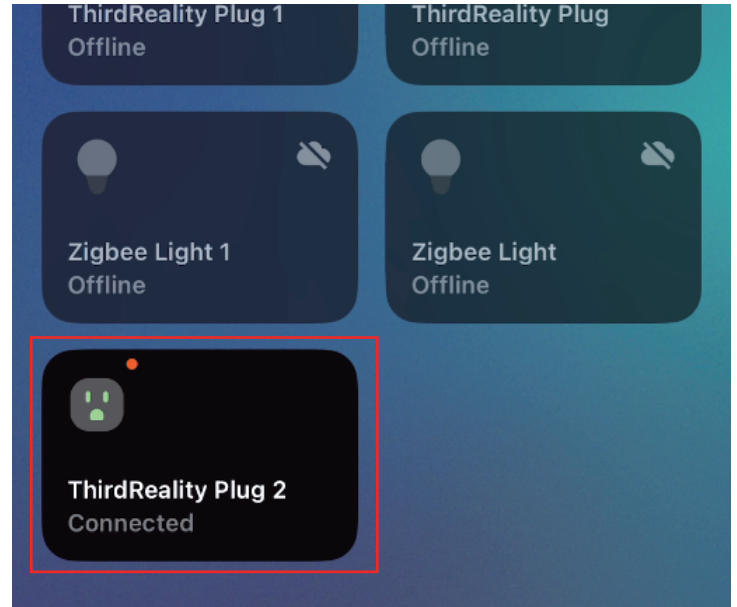
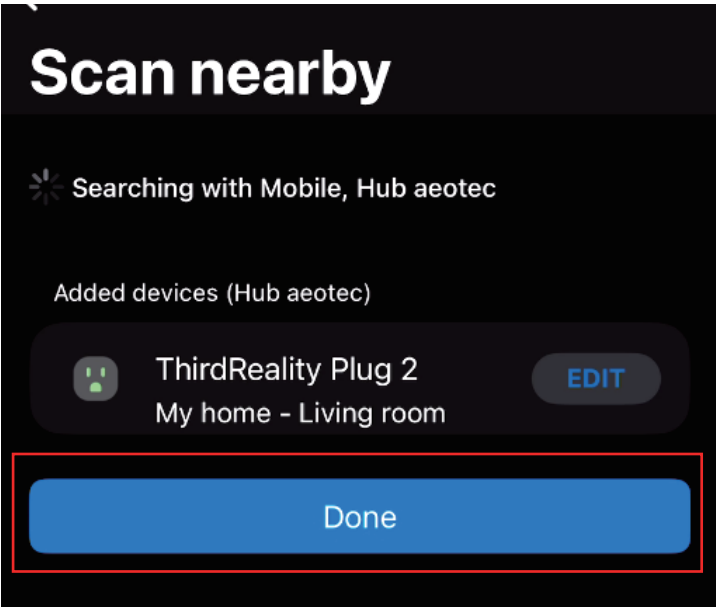
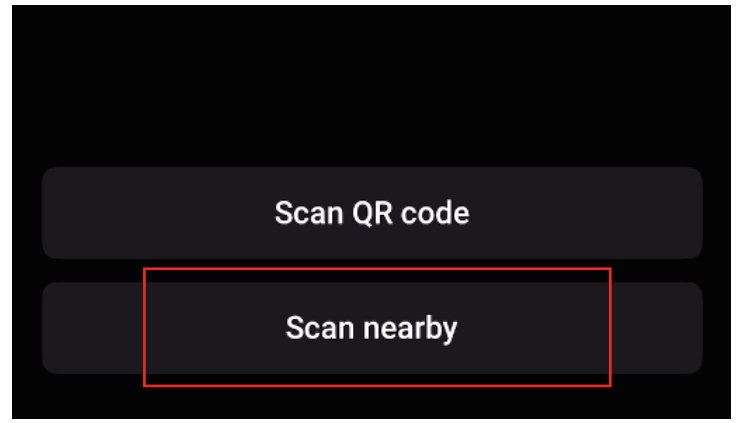
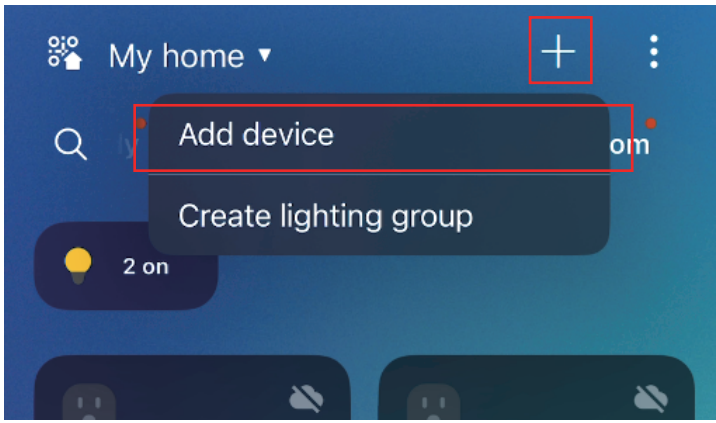

# Pairing with Amazon Echo

Compatible Devices: Echo 4th Gen, Echo Plus 1st Gen/2nd Gen, Echo Show 10 2nd Gen, Echo Show 10 3rd Gen, Echo Studio, Eero 6, Eero 6 Pro.

App: Amazon Alexa App



## Pairing steps:

1. Check your Echo speaker for firmware updates before pairing.
2. Plug the Smart Plug into a power outlet near the Echo speaker, the LED indicator of the plug flashes rapidly in red, indicating it is in pairing mode. It exits pairing mode within 3 minutes if not successfully paired. To put it into pairing mode again, press the button for 10 seconds until the LED indicator flashes rapidly in red.
3. Tap "+" in the upper right in your Alexa app to "Add Device", scroll down to choose "Other", then choose Zigbee connection to add device, or simply ask Alexa to discover devices, the Smart Plug will be paired within seconds.
4. You can turn on/off the plug through voice assistant or Echo app on your phone, or you can create routine to control it.

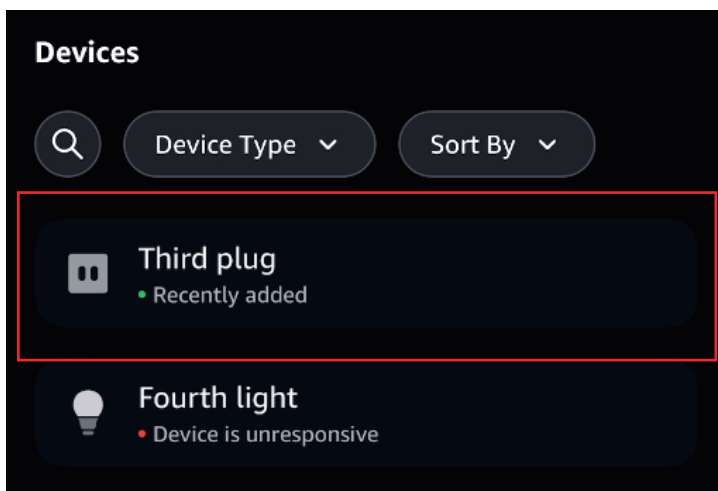
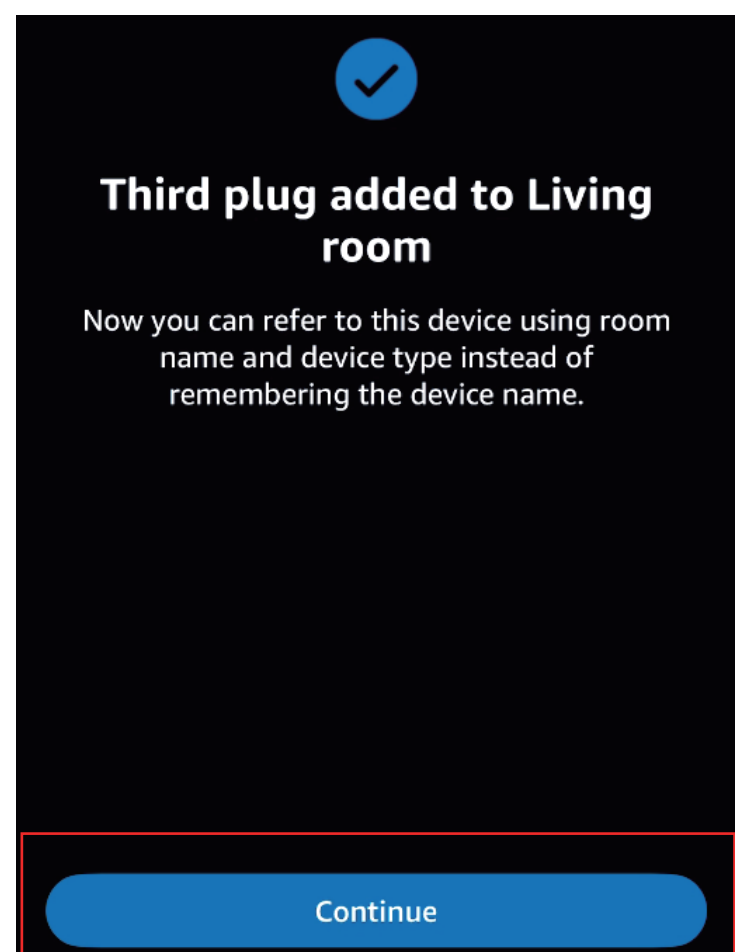
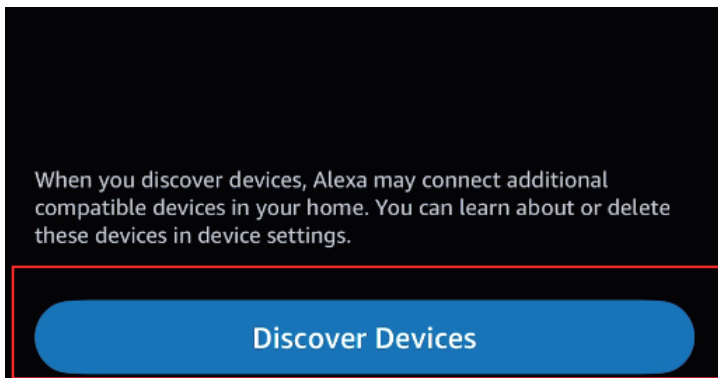
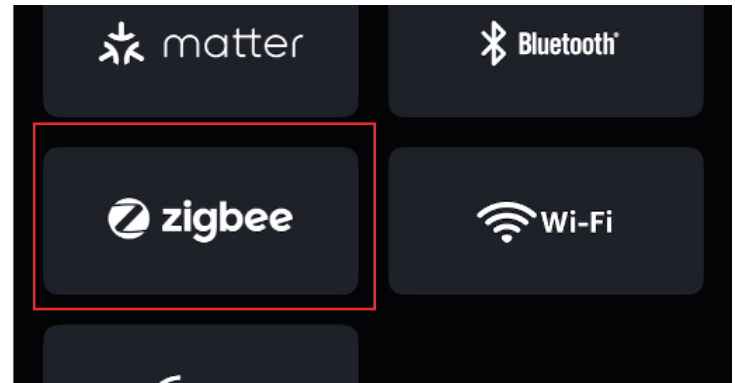
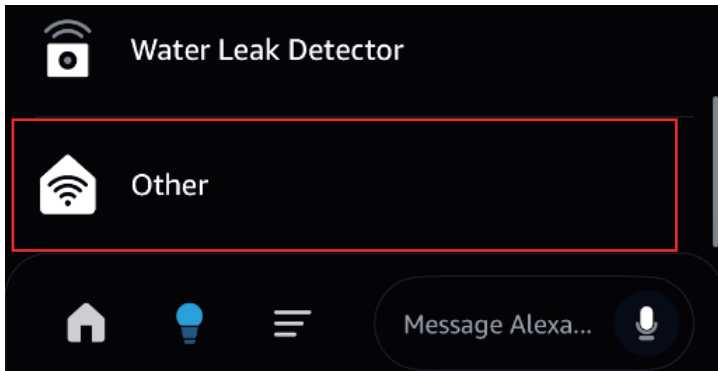
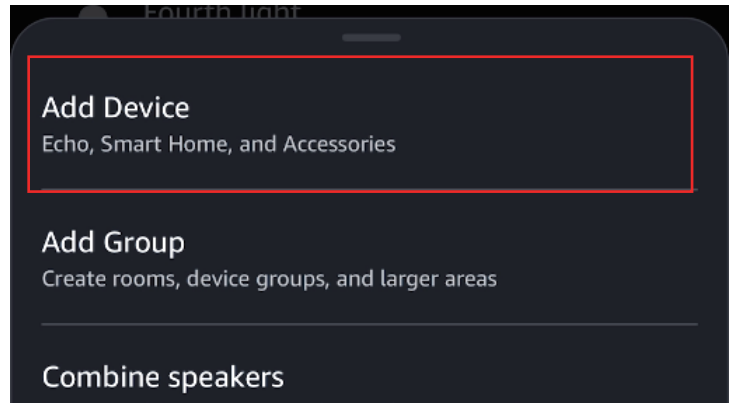
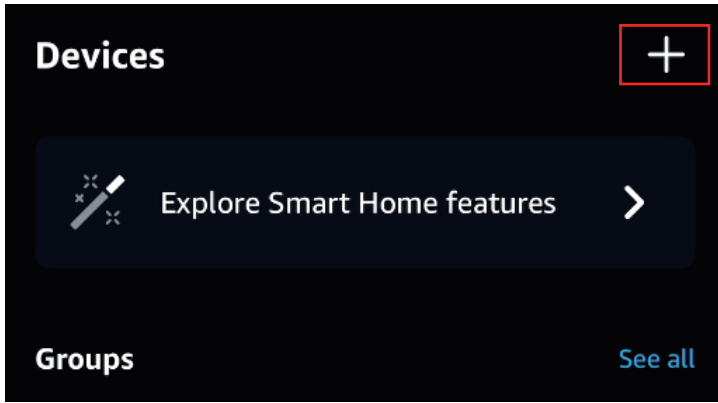

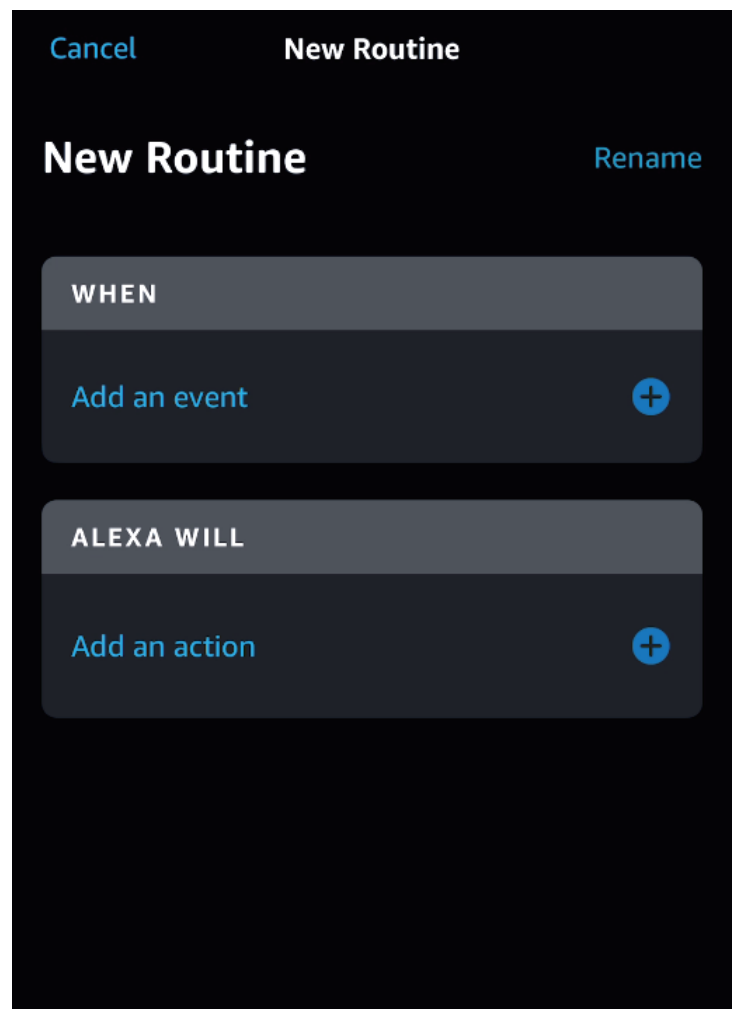
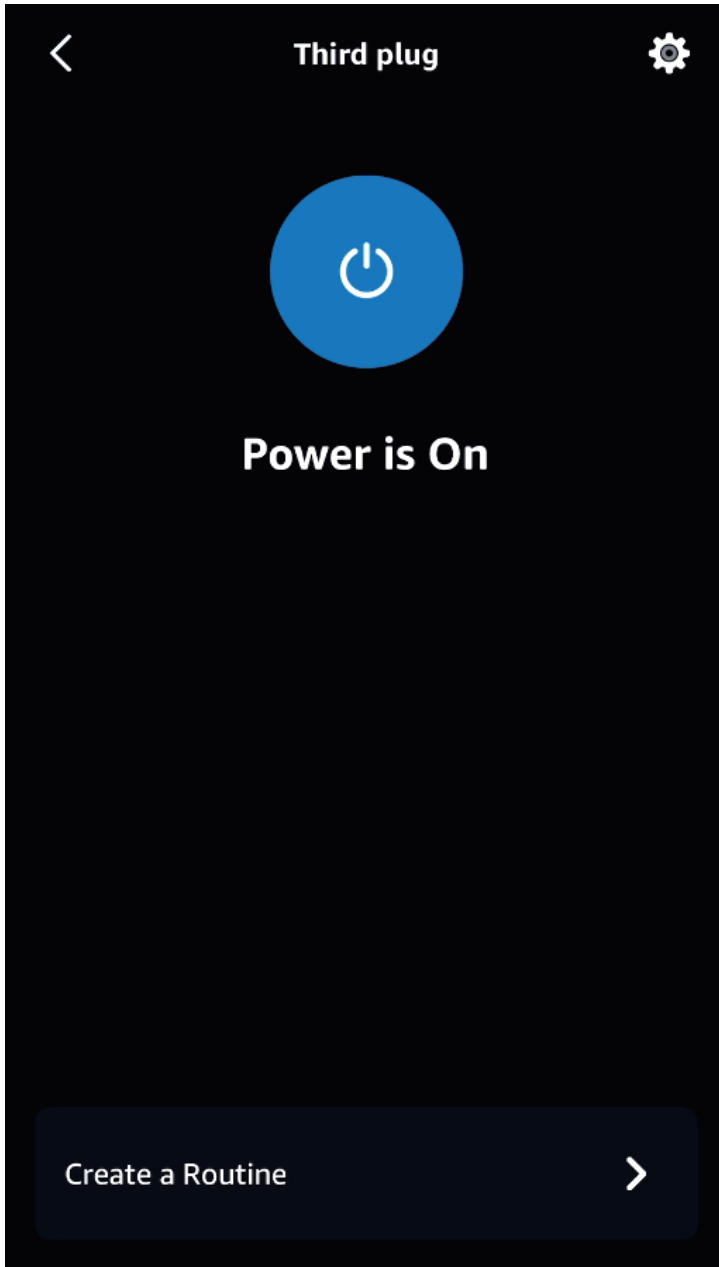

# Pairing with Hubitat

Website: <http://find.hubitat.com/>



## Pairing steps:

1. Before pairing the Smart Plug with Hubitat Elevation, check for firmware update in your Hubitat settings page.
2. Plug the Smart Plug into a socket near the hub, the LED indicator flashes rapidly in red, indicating it is in pairing mode. It exits pairing mode within 3 minutes if not successfully paired. To put it into pairing mode again, press the button for 10 seconds until the LED indicator flashes rapidly in red.
3. Tap + Add device in the Devices page.
4. Choose Zigbee to add device manually.
5. The Smart Plug will be paired within seconds, then you can rename it and edit its location.

6. Change Type from "Device" to "Generic Zigbee Outlet".
7. Now you can turn on/off the Smart Plug.

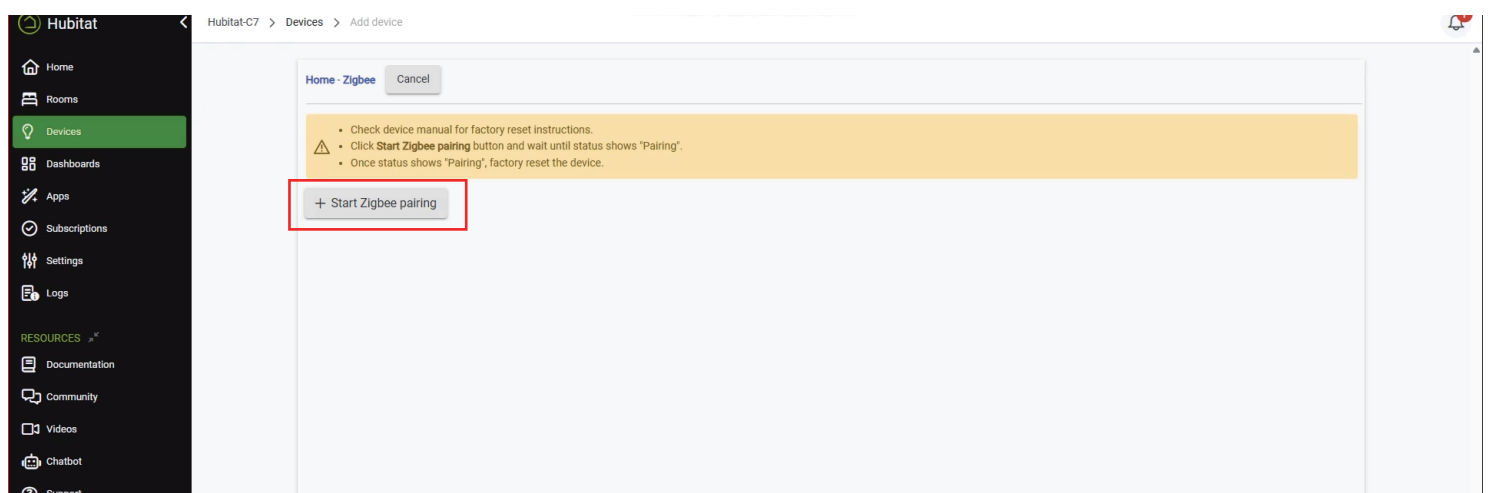
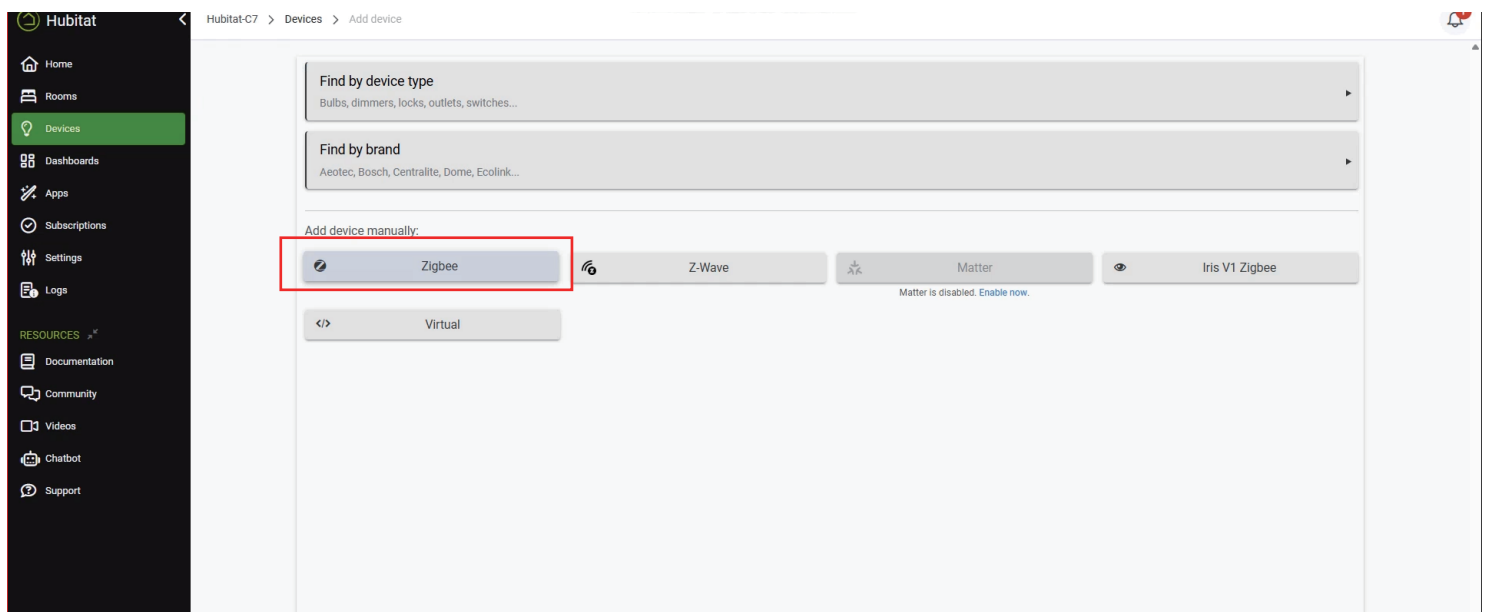
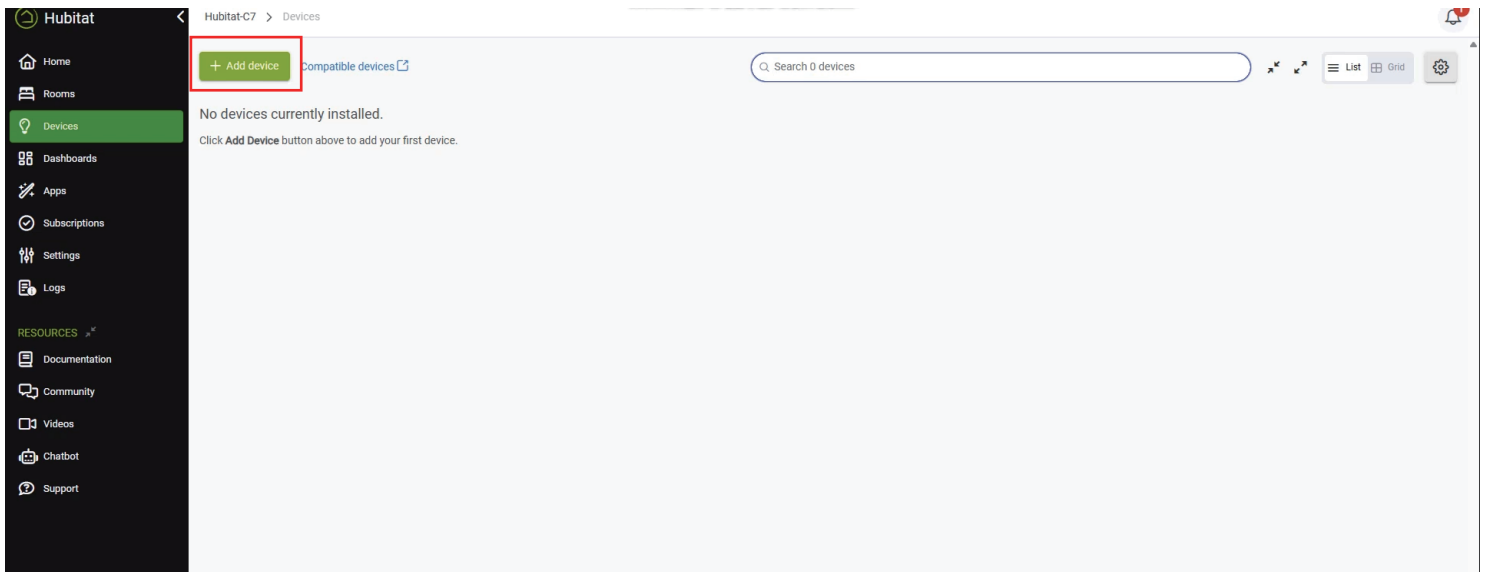

Hubitat-C7 > Devices > Add device

Home

Device added!

[View device details](#)

Test the functions of your new device (**highly recommended**) and see additional details.

[+ Add another device](#)

Start from the beginning to add a new device.

Hubitat-C7 > Devices > Smart Plug UZ1

Commands Preferences **Device Info** In Use By Scheduled Jobs Events Logs

Device name: Device Device label: Smart Plug UZ1 Device Network Id: 2008 [edit](#)

Zigbee Id: 4CE174DF20A90000

Type (currently system): Generic Zigbee Outlet Room: Dashboards: Select dashboards

Event history size: 11 State history size: 30 Too many events alert threshold: 300

Hub Mesh  enabled Tags: [Edit tags](#)

Custom icon: [?](#) [🗑️](#) Device note: Add a note about this device

[Save](#)

Hubitat-C7 > Devices > Smart Plug UZ1

Commands Preferences Device Info **In Use By** Scheduled Jobs Events Logs

Show common commands first

Configure [Configure](#) Flash [Flash](#) Off [Off](#)

On [On](#) Refresh [Refresh](#) Update Firmware [Update Firmware](#)

Current States  Show raw names Power: 0

[Show in Rooms](#) [Show in Devices](#) [Disable](#) [Remove](#)

# Pairing with Home Assistant



## Pairing steps:

### Zigbee Home Automation(ZHA)

1. Plug the Smart Plug into a socket near the hub, the LED indicator flashes rapidly in red, indicating it is in pairing mode. It exits pairing mode within 3 minutes if not successfully paired. To put it into pairing mode again, press the button for 10 seconds until the LED indicator flashes rapidly in red.
2. Make sure Home Assistant Integration Zigbee Home Automation Setup is ready, then go to "settings" page, Click "Devices & Services".
3. Then click the "Devices" on the Zigbee item, then click "Add Devices".
4. After the pairing is completed successfully, it will show up in the page.

5. Back to "Devices", then you can find the smart Plug added.
6. Click to enter in the control interface to set the Smart Plug, you can monitor the active power and preset on/off states after power outage in the devices page.

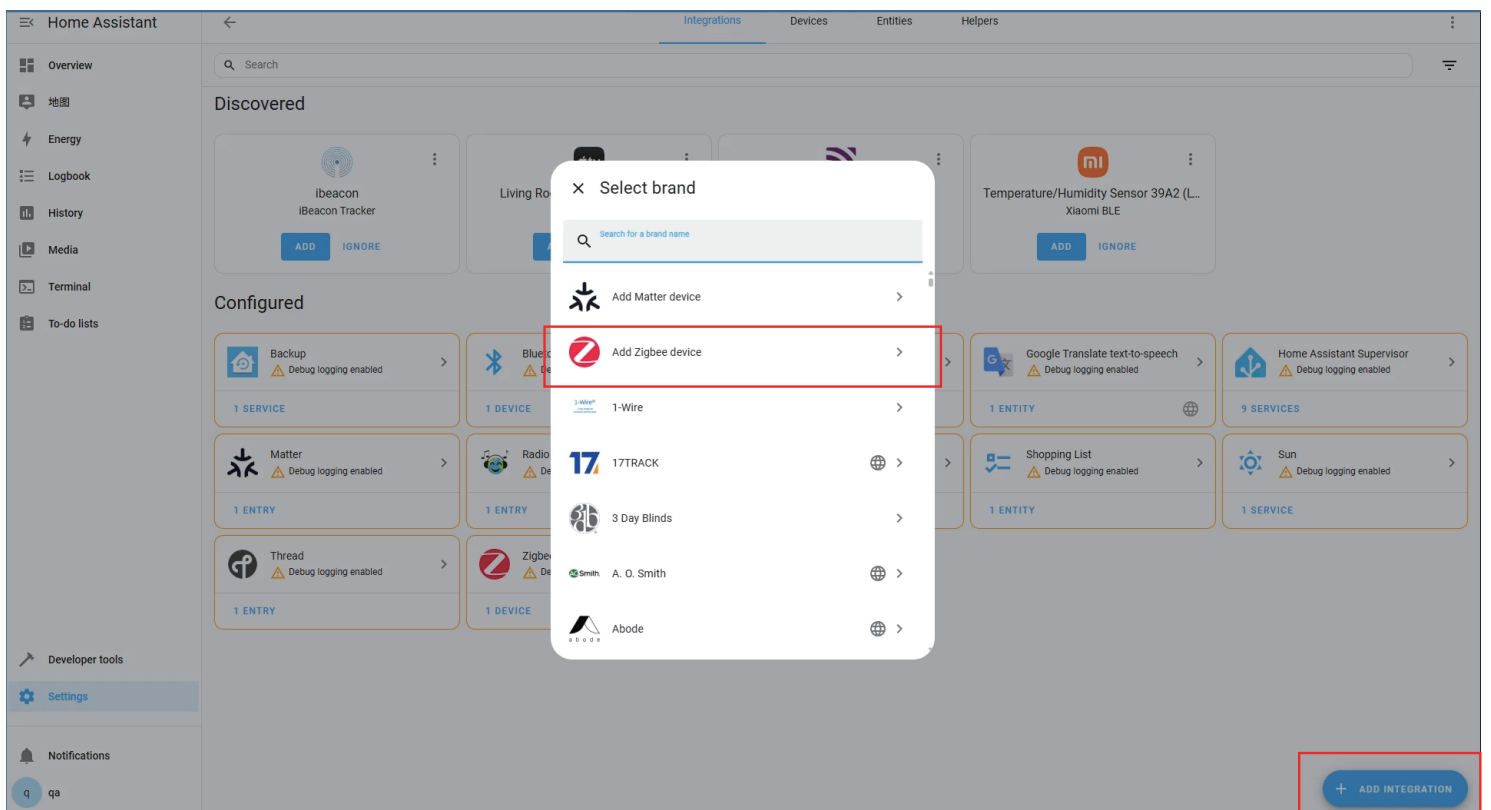
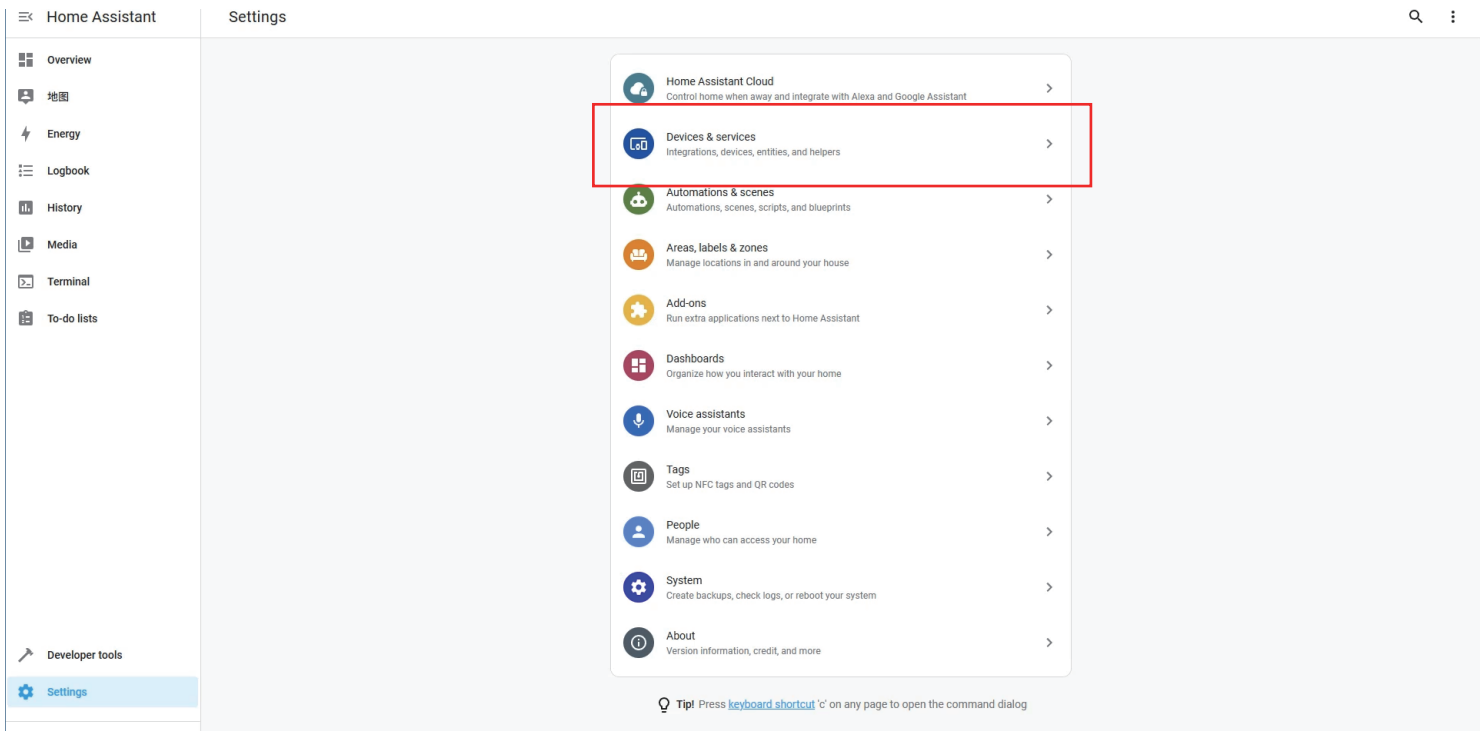

Home Assistant

Network Groups Visualization SHOW LOGS

Overview  
地图  
Energy  
Logbook  
History  
Media  
Terminal  
To-do lists

Developer tools  
Settings

Searching for Zigbee devices...

Interview complete  
Configuring

3RSPU01080Z  
by Third Reality, Inc  
IEEE: 4c:e1:74:df:20:a9:00:00  
NWK: 0x0006

Home Assistant

Zigbee Home Automation 2 devices • 12 entities ADD ENTRY

Debug logging enabled DISABLE

Integration entries

^ Zigbee Home Automation	⚙️	⋮
ZIGate ZIGate USB-TTL ZIGate USB-TTL	>	✏️ ⋮
Third Reality, Inc 3RSPU01080Z 3RSPU01080Z • 12 entities	>	✏️ ⋮

Developer tools  
Settings

Home Assistant Third Reality, Inc 3RSPU01080Z

Overview 地图 Energy Logbook History Media Terminal To-do lists Developer tools Settings

**zigbee**

### Device info

3RSPU01080Z  
by Third Reality, Inc  
Connected via [ZiGate ZiGate USB-TTL](#)

Zigbee info

- Zigbee Home Automation

RECONFIGURE

### Controls

Third Reality, Inc 3RSPU01...

ADD TO DASHBOARD

### Sensors

AC Frequency	50.0 Hz
Current	0.0 A
Power Factor	0.0%
Power Supply	0.0 W
Total Delivered	0.000 kWh
Voltage	234.3 V

ADD TO DASHBOARD

### Configuration

Firmware Unknown

启动行为 PreviousValue

### Automations

No automations have been added using this device yet. You can add one by pressing the + button above.

### Scenes

No scenes have been added using this device yet. You can add one by pressing the + button above.

### Scripts

No scripts have been added using this device yet. You can add one by pressing the + button above.

### Logbook

August 6, 2025

- Firmware became unknown  
8:56:25 AM - 2 minutes ago
- Third Reality, Inc 3RSPU01080Z turned off  
8:56:26 AM - 2 minutes ago
- Third Reality, Inc 3RSPU01080Z 启动行为 changed to PreviousValue  
8:56:25 AM - 2 minutes ago
- Third Reality, Inc 3RSPU01080Z 确认 became unknown  
8:56:25 AM - 2 minutes ago
- Firmware became unavailable  
8:56:16 AM - 2 minutes ago
- Third Reality, Inc 3RSPU01080Z became

Home Assistant Third Reality, Inc 3RSPU01080Z

Overview 地图 Energy Logbook History Media Terminal To-do lists Developer tools Settings Notifications qa

**zigbee**

### Device info

3RSPU01080Z  
by Third Reality, Inc  
Connected via [ZiGate ZiGate USB-TTL](#)

Zigbee info

- Zigbee Home Automation

RECONFIGURE

### Controls

Third Reality, Inc 3RSPU01...

ADD TO DASHBOARD

### Sensors

AC Frequency	50.0 Hz
Current	0.0 A
Power Factor	0.0%
Power Supply	0.0 W
Total Delivered	0.000 kWh
Voltage	234.3 V

ADD TO DASHBOARD

### Configuration

Firmware Unknown

启动行为 PreviousValue

ADD TO DASHBOARD

### Automations

No automations have been added using this device yet. You can add one by pressing the + button above.

### Scenes

No scenes have been added using this device yet. You can add one by pressing the + button above.

### Scripts

No scripts have been added using this device yet. You can add one by pressing the + button above.

### Logbook

August 6, 2025

- Third Reality, Inc 3RSPU01080Z turned off triggered by action Switch: Turn off  
8:58:50 AM - In 1 second - qa
- Third Reality, Inc 3RSPU01080Z turned on triggered by action Switch: Turn on  
8:58:49 AM - 1 second ago - qa
- Third Reality, Inc 3RSPU01080Z turned off triggered by action Switch: Turn off  
8:58:45 AM - 4 seconds ago - qa
- Third Reality, Inc 3RSPU01080Z turned on triggered by action Switch: Turn on  
8:58:45 AM - 5 seconds ago - qa
- Third Reality, Inc 3RSPU01080Z turned off

### Create automation with device

- Use device as trigger  
When something happens to the device
- Use device as condition  
Only if a condition is met for the device
- Use device as action  
Do something on the device
- Create new automation  
Start with an empty automation from scratch

# Zigbee2MQTT

1. Plug the Smart Plug into a socket near the hub, the LED indicator flashes rapidly in red, indicating it is in pairing mode. It exits pairing mode within 3 minutes if not successfully paired. To put it into pairing mode again, press the button for 10 seconds until the LED indicator flashes rapidly in red.
2. Click "Permit Join" in Zigbee2MQTT to add device.
3. Smart Plug UZ1 has been added successfully.
4. Click the device name to see detailed device information.
5. Now you can turn on/off the Smart Plug in the Exposes page.

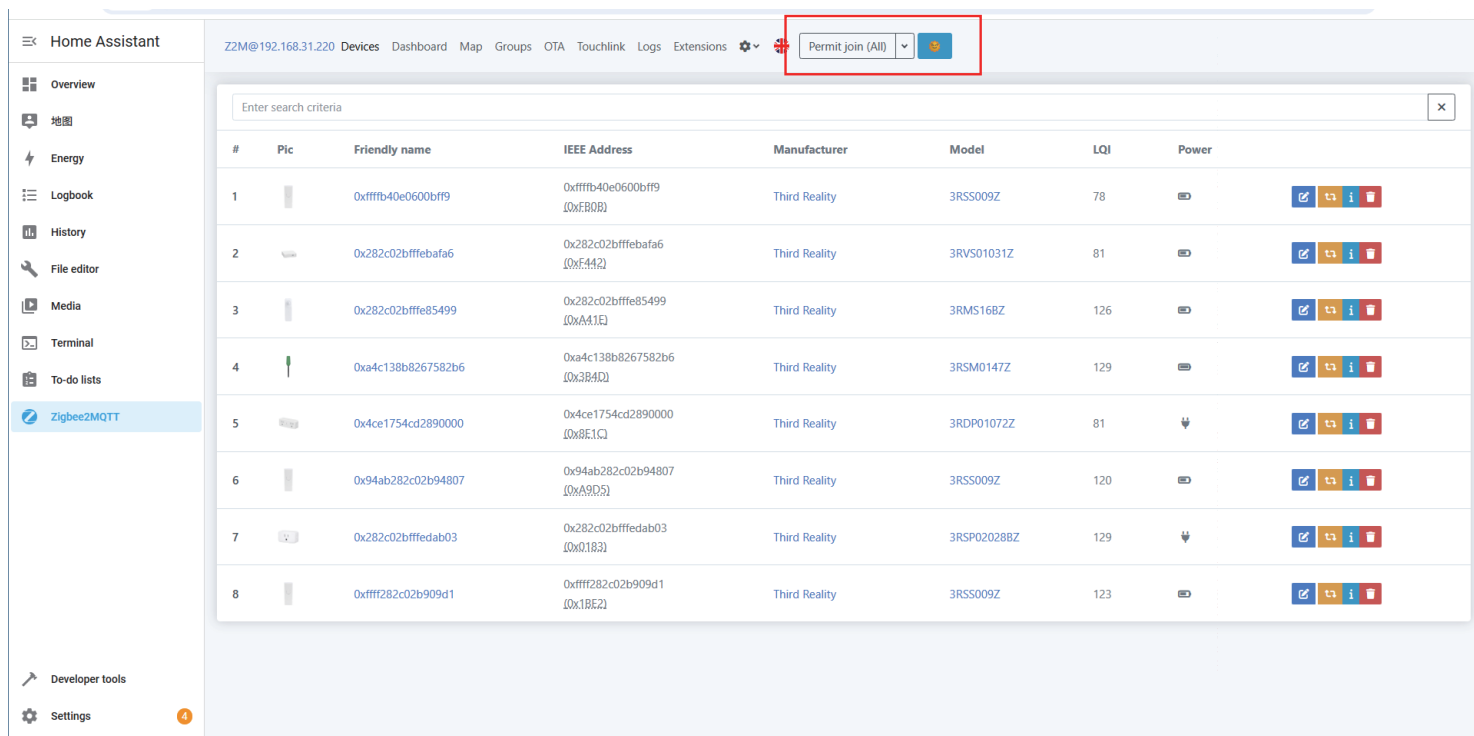

The screenshot shows the Home Assistant interface with the Zigbee2MQTT integration. The left sidebar contains navigation options like Overview, Energy, Logbook, History, File editor, Media, Terminal, To-do lists, Developer tools, and Settings. The main area displays a table of Zigbee devices. A red box highlights the 'Permit join (All)' button in the top right corner of the device list.

#	Pic	Friendly name	IEEE Address	Manufacturer	Model	LQI	Power	
1		0xffffb40e0600bf9	0xffffb40e0600bf9 (0x:FB0B)	Third Reality	3RSS009Z	78		
2		0x282c02bfffefafa6	0x282c02bfffefafa6 (0x:F442)	Third Reality	3RVS01031Z	81		
3		0x282c02bfffef85499	0x282c02bfffef85499 (0xA41E)	Third Reality	3RMS168Z	126		
4		0xa4c138b8267582b6	0xa4c138b8267582b6 (0x:3B4D)	Third Reality	3RSM0147Z	129		
5		0x4ce1754cd2890000	0x4ce1754cd2890000 (0x:8E1C)	Third Reality	3RDP01072Z	81		
6		0x94ab282c02b94807	0x94ab282c02b94807 (0xA9D5)	Third Reality	3RSS009Z	120		
7		0x282c02bfffefab03	0x282c02bfffefab03 (0x:1B33)	Third Reality	3RSP020288Z	129		
8		0xffff282c02b909d1	0xffff282c02b909d1 (0x:1BE2)	Third Reality	3RSS009Z	123		

- Overview
- 地图
- Energy
- Logbook
- History
- File editor
- Media
- Terminal
- To-do lists

Zigbee2MQTT

Developer tools

Settings

Enter search criteria

#	Pic	Friendly name	IEEE Address	Manufacturer	Model	LQI	Power	
1		0xffffb40e0600bff9	0xffffb40e0600bff9 (0xFB0B)	Third Reality	3RSS009Z	78		
2		0x282c02bffffbafa6	0x282c02bffffbafa6 (0xF442)	Third Reality	3RVS01031Z	81		
3		0x282c02bffffe85499	0x282c02bffffe85499 (0xA41E)	Third Reality	3RMS16BZ	138		
4		0xa4c138b8267582b6	0xa4c138b8267582b6 (0x3B4C)	Third Reality	3RSM0147Z	117		
5		0x94ab282c02b94807	0x94ab282c02b94807 (0xA9D5)	Third Reality	3RSS009Z	102		
6		0xffff282c02b909d1	0xffff282c02b909d1 (0x18E2)	Third Reality	3RSS009Z	111		
7		0x4ce174df20a90000	0x4ce174df20a90000 (0xE392)	Third Reality	3RSPU01080Z	96	?	

- Overview
- 地图
- Energy
- Logbook
- History
- File editor
- Media
- Terminal
- To-do lists

Zigbee2MQTT

Developer tools

Settings

0x4ce174df20a90000 ▾

About Exposes Bind Reporting Settings Settings (specific) State Clusters Scene Dev console

**State**  
On/off state of the switch OFF  ON

**Power-on behavior**  
Controls the behavior when the device is powered on after power loss off on toggle previous

**Power**  
Instantaneous measured power 0 W

**Voltage**  
Measured electrical potential value 235.8 V

**AC frequency**  
Measured electrical AC frequency 50 Hz

**Power factor**  
Instantaneous measured power factor 0

**Current**  
Instantaneous measured electrical current 0 A

**Energy**  
Sum of consumed energy 0 kWh

**Linkquality**  
Link quality (signal strength) 90 lqi

## Mesh Network Setup

If you want to have multiple plugs set up for different rooms, especially rooms out of the range of the Echo Devices Zigbee signal range, you can utilize Mesh Network setup to extend the range.

1. First, set up the smart plugs close to the Echo Device.
2. Unplug the plug and move it further away from the Echo Device. And make sure it's within Zigbee range of another active plug, which is connected on the network as a node. This will form a Zigbee Mesh Network. Each connected plug will connect with other plugs (nodes) within the range.

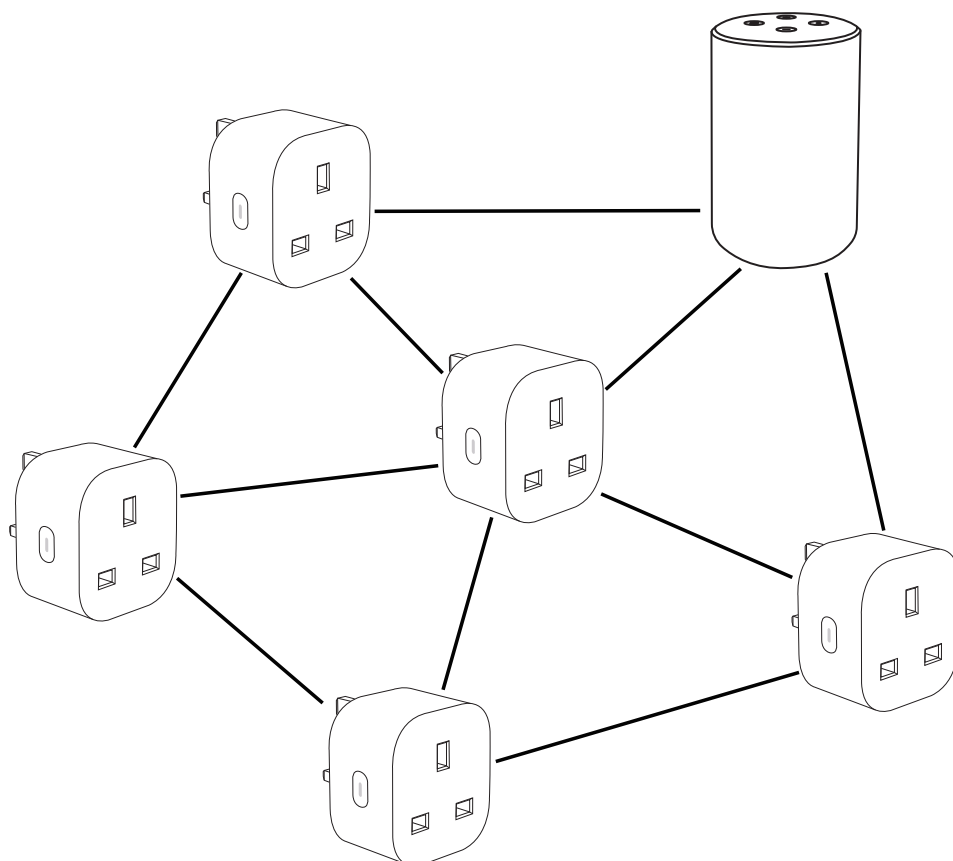

# Using your Smart Plug UZ1

1. Control the Smart Plug via voice command, say " Alexa, turn on/off First Plug ".
2. Schedules or timers to turn the Smart Plug on/off automatically.
3. Create routines to enjoy your smart life, say " Alexa, good morning " to turn on the coffee maker, etc.
4. Remotely control the Smart Plug from your phone even if you are not at home.
5. Use the plugs as extenders, they can help Echo Devices or the Zigbee Hubs to connect with the plugs that are further away from your Echo.

# Troubleshooting

## 1. Factory reset the Smart Plug UZ1

Power on the Smart Plug, and then press and hold the button for more than 10 seconds until the LED light flashes in red.

## 2. Fail to pair with Echo

Make sure your Echo Speaker is compatible with Smart Plug (See the Compatible Devices List) and the Smart Plug is in the right mode.

- Please ensure your Echo Devices are set up before adding the Smart Plugs.
- Reboot the Echo Speaker or Zigbee Hub by unplugging the power and plugging it back in, then try to pair the Smart Plug with it again.
- Factory reset the Echo speaker (Press and hold the Action Button for 25 seconds. The light ring will pulse orange, then turn off. Wait for the light ring to turn back on and turn blue. The light ring then turns orange again and the device enters the setup mode), then try to pair the Smart Plug with it again.

### 3. **Smart Plug is not responding**

- Turn on/off the Smart Plug twice in the Alexa app to sync the plug.
- If not connected, please reboot the Echo Speaker and factory reset the Smart Plug, then pair the Smart Plug with the Echo Speaker.
- If still not working, please try to deregister the Echo Speaker and register back in, then try to pair the Smart Plug with it.

### 4. **Move Smart Plugs**

If you want to move the paired plug from one echo to another, make sure you remove the plug from the Alexa app and wait 30 minutes to allow cloud synchronization before repairing with different Echo Device.

## 5. Alexa's response

If the Alexa Device finds the plug, setup is complete.

But if the Alexa Device says she did not find any devices, say " Alexa, turn all plugs off ".

If the " plug " in question turns off, then the plug did set up and the Echo Device had the common false fail issue —where an Echo Device will say it did not find the plug when it in fact did. Please, if it is not too much trouble, report this false fail to Amazon as the plug did add but the Echo Device wrongly said it did not add. Hopefully, if enough people report the issue, it can be found and solved.

**Note:** If the Alexa Device says she failed to find the plug and the plug does not respond to " Alexa, turn all plugs off ", please contact us at [Support@3reality.com](mailto:Support@3reality.com) to let us know so we may assist.

## Limited Warranty

For limited warranty, please visit

<https://3reality.com/faq-help-center/>

For customer support, please contact us at

[info@3reality.com](mailto:info@3reality.com) or visit [www.3reality.com](http://www.3reality.com)

For question on other platforms, visit for corresponding platform' s application/support platforms.